

10100274
REV 1
SHEET 1
SIZE DRAWING NO. A3

GE PROPRIETARY AND CONFIDENTIAL INFORMATION
 This document is the property of General Electric Company ("GE") and contains proprietary information of GE. This document is loaned on the express condition that neither it nor the information contained therein shall be disclosed to others without the express written consent of GE Industrial Systems, and that the information shall be used by the recipient only as approved expressly by GE Industrial Systems. This document shall be returned to GE upon its request. This document may be subject to certain restrictions under U.S. export control laws and regulations.

REVISIONS			
REV.	DESCRIPTION	DATE	APPROVED
1	R1102469	YY 02/03/11	AJ

METRIC

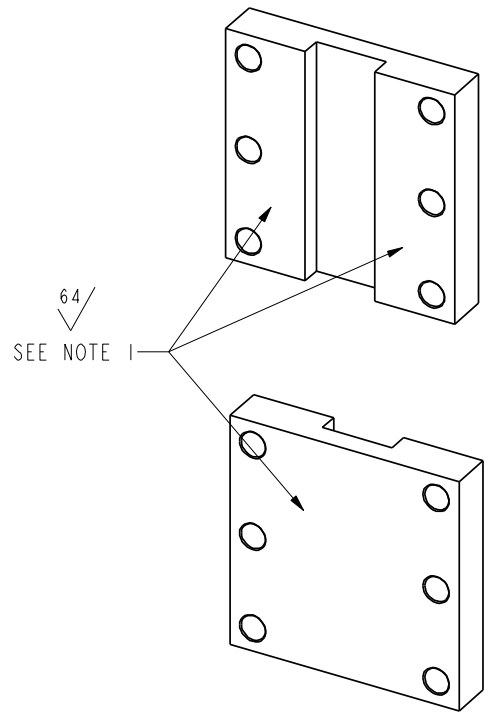
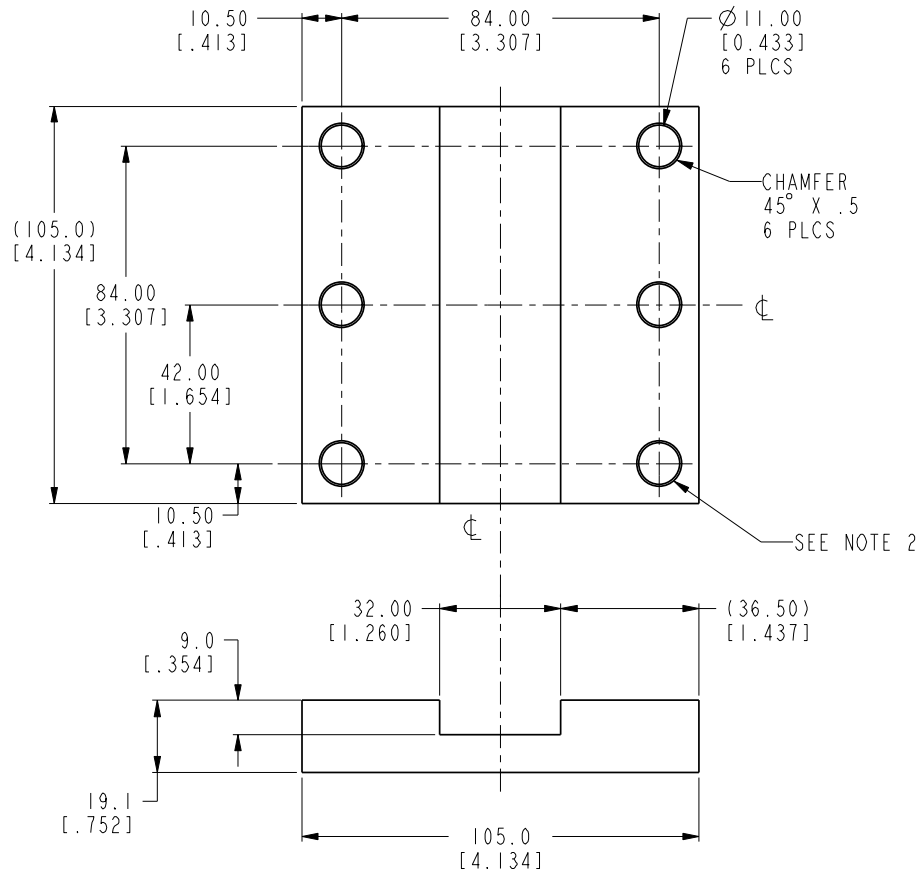

64
SEE NOTE 1

SEE NOTE 2

P3

MATERIAL :B11B4C2 HIGH CONDUCTIVITY COPPER(HALF HARD)
 REMOVE SHARP EDGES AND BURRS
 NOTE 1 : CONTACT MAKING SURFACES TO BE DENT & BURR FREE
 NOTE 2 : DEBURR HOLES ON BOTH SIDES
 DIMS IN [xxx] ARE INCHES

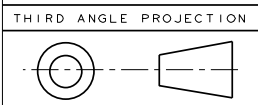

Article or Material Must Conform to RoHS Procedure SI900000 Sec. 13
 Part must conform to SI 900000 Sect. 4, Toxicity Procedure

FOR ADDITIONAL INFO REFER TO: APPLIED PRACTICES EDB	SIGNATURES	DATE	GE Consumer & Industrial GENERAL ELECTRIC COMPANY
DIMENSIONS ARE IN MILLIMETERS UNLESS OTHERWISE SPECIFIED IN DRAWING	MODEL	YY 02/03/11	
TOLERANCE ON: 1 PL DECIMALS ± 0.3 2 PL DECIMALS ± 0.13 ANGLES ± 0.5 FRACTIONS ±	DETAIL		TITLE FR2, CASSETTE TRMNL BASE FOR UL PV BREAKER 3000A
FINISH	CHECKED		SIZE DRAWING A3
CRITICAL TO QUALITY CHARACTERISTIC	ENGRG		10100274
	MFG		REV 1
	QUALITY		SCALE: 1:1
	ISSUED		REF. No. :
	DRAWING FILE: 10100274P3		SHEET 1 of 1
	SOLID MODEL: 10100274P3		

METRIC