

kVA RATING:
K-FACTOR:
PRI VOLTAGE:
SEC VOLTAGE:
FREQ (Hz):
TEMP RISE:
WINDING MATL:
ES SHIELD:
SOUND LVL (dB):

| KNOCKOUTS | |
|---------------------------|----------------|
| CONDUIT SIZE | TOTAL QUANTITY |
| 1" OR 2" [27 OR 53 MM] | 8 |

APPROX TOTAL WEIGHT
400 LBS [181 KG]

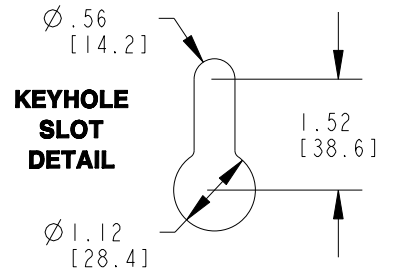

| | | | |
|---|--|--|--------------|
| JOB NAME: SPEEDI PROP: | UNLESS OTHERWISE SPECIFIED ALL DIMENSIONS ARE INCH [MM] | | |
| | THIRD ANGLE PROJECTION | DRY TYPE TRANSFORMER OUTLINE DRAWING TYPE QMS, 1-PHASE (ENCLOSED INDOOR/OUTDOOR UNIT) | |
| CAD DRAWING: 303B923AAP025 | SHEET 1 OF 1 | CATALOG # | REV 3 |