

| STYLE NO. | RATINGS (kV rms) | | TOV (kV rms) | MAXIMUM RESIDUAL VOLTAGE WITH CURRENT WAVE (kV PEAK) | | | | |
|----------------|------------------|------------------------|----------------|--|---------------------|--------------------|------------|------|
| | V _r | MCOV V _{mcoV} | | WITH PRIOR ENERGY SINGLE IMPULSE OF 4.5 kJ/kVr | SPL (SIPL) 30/60 μS | LPL (LIPL) 8/20 μS | FOW 0.5 μS | |
| STANDARD CREEP | | | | | | | | |
| 0003SA002ASZ76 | 3 | 2.55 | Ø10 sec = 4.93 | 9.77 | 10.9 | 11.3 | 12.9 | 12.8 |
| 0004SA003ASZ76 | 4 | 3.40 | Ø10 sec = 4.93 | 10.0 | 11.2 | 11.6 | 13.3 | 13.1 |
| 0005SA004ASZ76 | 5 | 4.25 | Ø10 sec = 6.57 | 12.3 | 13.7 | 14.4 | 16.3 | 16.1 |
| 0006SA005ASZ76 | 6 | 5.10 | Ø10 sec = 6.57 | 12.8 | 14.3 | 15.0 | 17.0 | 16.8 |
| 0007SA006ASZ76 | 7 | 5.95 | Ø10 sec = 9.86 | 17.7 | 19.8 | 21.0 | 23.6 | 23.3 |
| 0008SA007ASZ76 | 8 | 6.80 | Ø10 sec = 9.86 | 18.5 | 20.7 | 22.0 | 24.7 | 24.4 |
| 0009SA008BSZ76 | 9 | 7.65 | Ø10 sec = 9.86 | 19.0 | 21.3 | 22.6 | 25.4 | 25.0 |
| 0010SA008BSZ76 | 10 | 8.40 | Ø10 sec = 11.0 | 21.0 | 23.5 | 25.0 | 28.0 | 27.6 |

| | | | |
|---------------|-------------|-------------|--------|
| ABB | Date | POLIM-S | U.S.A. |
| | Style No. * | Ser. No. * | |
| Weight 18 lbs | MCOV * | kV Rating * | kV |

MASTER NAMEPLATE

* ASSIGNED AT THE TIME OF PRODUCTION AND RECORDED IN THE PROPER LOCATIONS

NOTES:

- FOR MINIMUM PHASE-TO-GROUND AND PHASE-TO-PHASE CLEARANCES WITH TYPE POLIM-S SURGE ARRESTERS, REFER TO THE POLIM-S PRODUCT BULLETIN (2GNM110077). OTHER APPARATUS STANDARDS, OTHER SPECIFICATIONS OR LOCAL CODES MAY SUPERCEDE DISTANCES SPECIFIED.
- DESIGNED FOR VERTICAL OR HORIZONTAL MOUNT.
- MAX CANTILEVER LOAD 20,000 in-lbs [2260 Nm].
- PRESSURE RELIEF CLASS IS 63 kA RMS SYMMETRICAL.
- NOMINAL CREEPAGE DISTANCE 11.3 [287].
- MAXIMUM ARRESTER WEIGHT 18.0 lbs [8.2 kg].

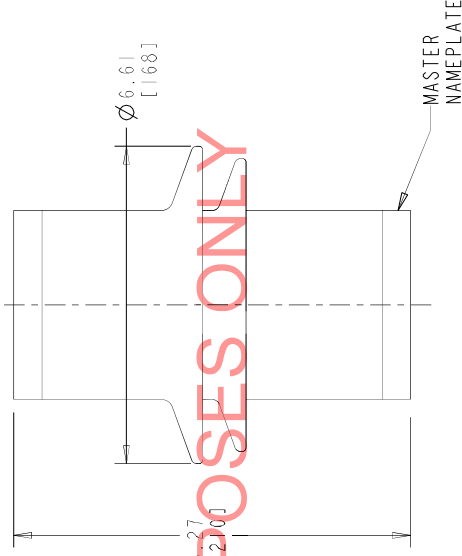

ALL DIMENSIONS IN INCHES [MM] UNLESS NOTED

This drawing is the property of ABB INC. and contains proprietary and confidential information which must not be duplicated, used or disclosed other than expressly authorized by ABB INC.

POLIM-S IEEE STATION / IEC CLASS 3
POLYMER ARRESTER (MODULE)
2 SHED HOUSING OUTLINE



ABB Inc.
Power Products Division
100 Distribution Circle, Mt. Pleasant, PA 15666

CAD DRW PRDZ WILDFIRE 2.0

| | |
|------------|--------------|
| SCALE 0:20 | SHEET 1 OF 1 |
| ASSY. DWG. | 4F4141 |
| DWG. NO. | 4F4141 |
| CHKD. | |
| APP. | |
| REV. | 2 |

| | | | | |
|-------------------------|--------------|-----------------------|----|---------------|
| 01 | MAY 30, 2014 | NOTE 5: 11.3 WAS 11.0 | 02 | JULY 22, 2015 |
| REV. DESCRIPTION & DATE | | DJK | | |