

3D Model is the Master Document of Record  
 Article or National Must Conform to NEC, IEC, or Procedure 59000000 Sec. 1.4  
 Part Must Conform to 39500000 Sec. 4 Toxicity Procedure  
 Geometric Dimensioning & Tolerancing as per ASME Y14.5-2009

ABB PROPRIETARY AND CONFIDENTIAL INFORMATION  
 The information contained in this document has to be kept strictly confidential.  
 Any unauthorized disclosure of this information is strictly forbidden.  
 ABB reserves all rights regarding Intellectual Property Rights.  
 Copyright 2018 ABB. All rights reserved.

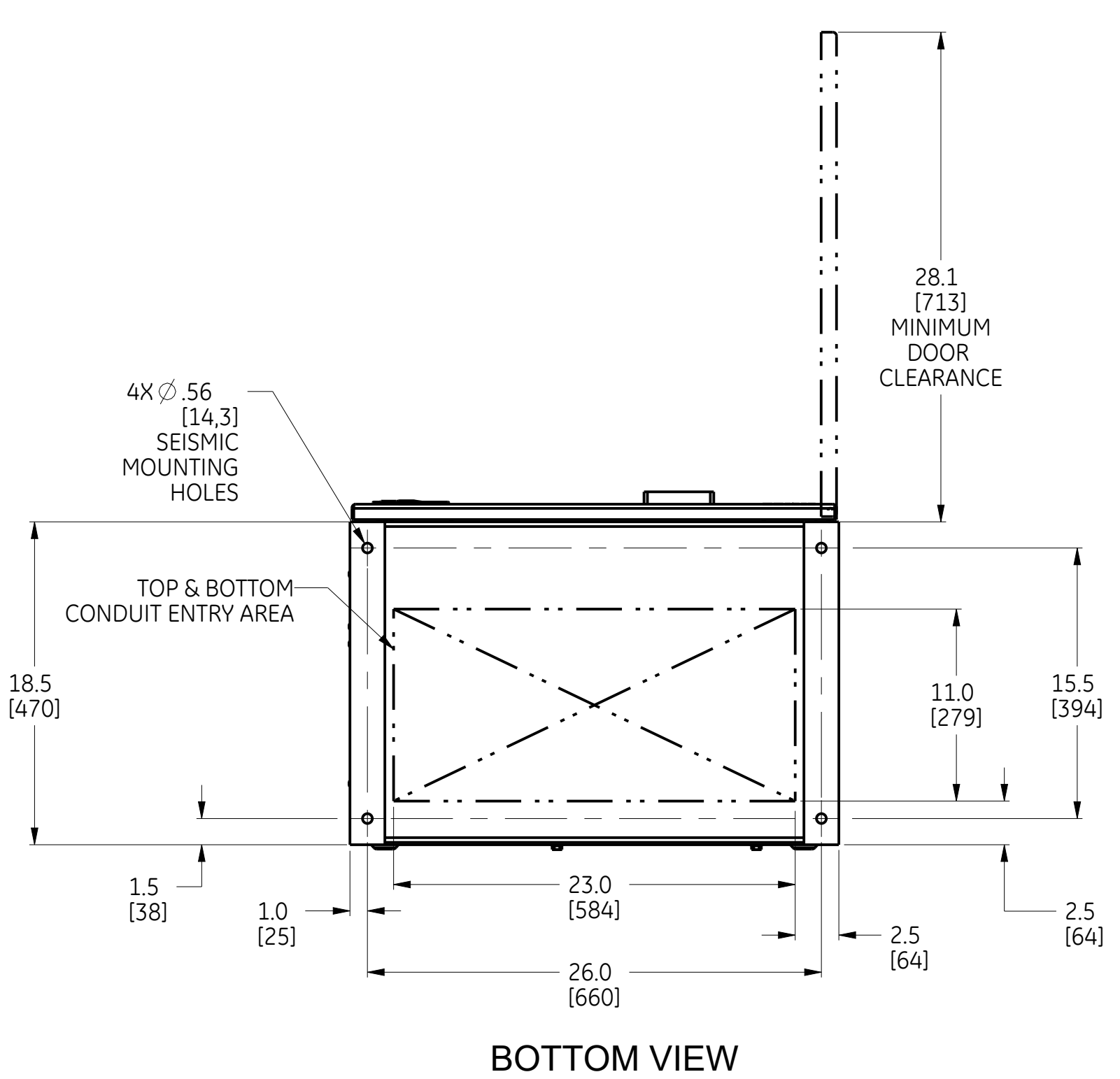
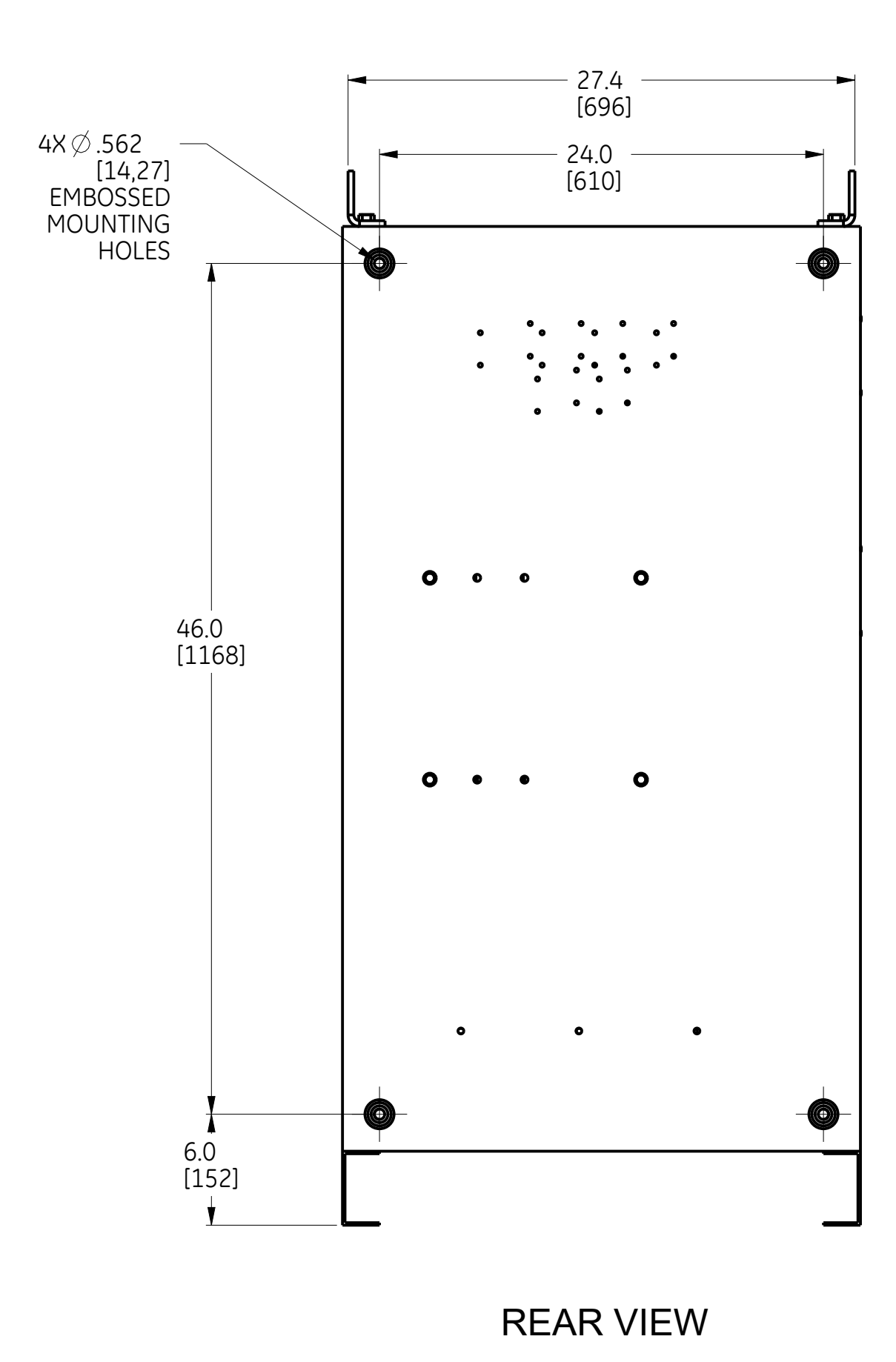
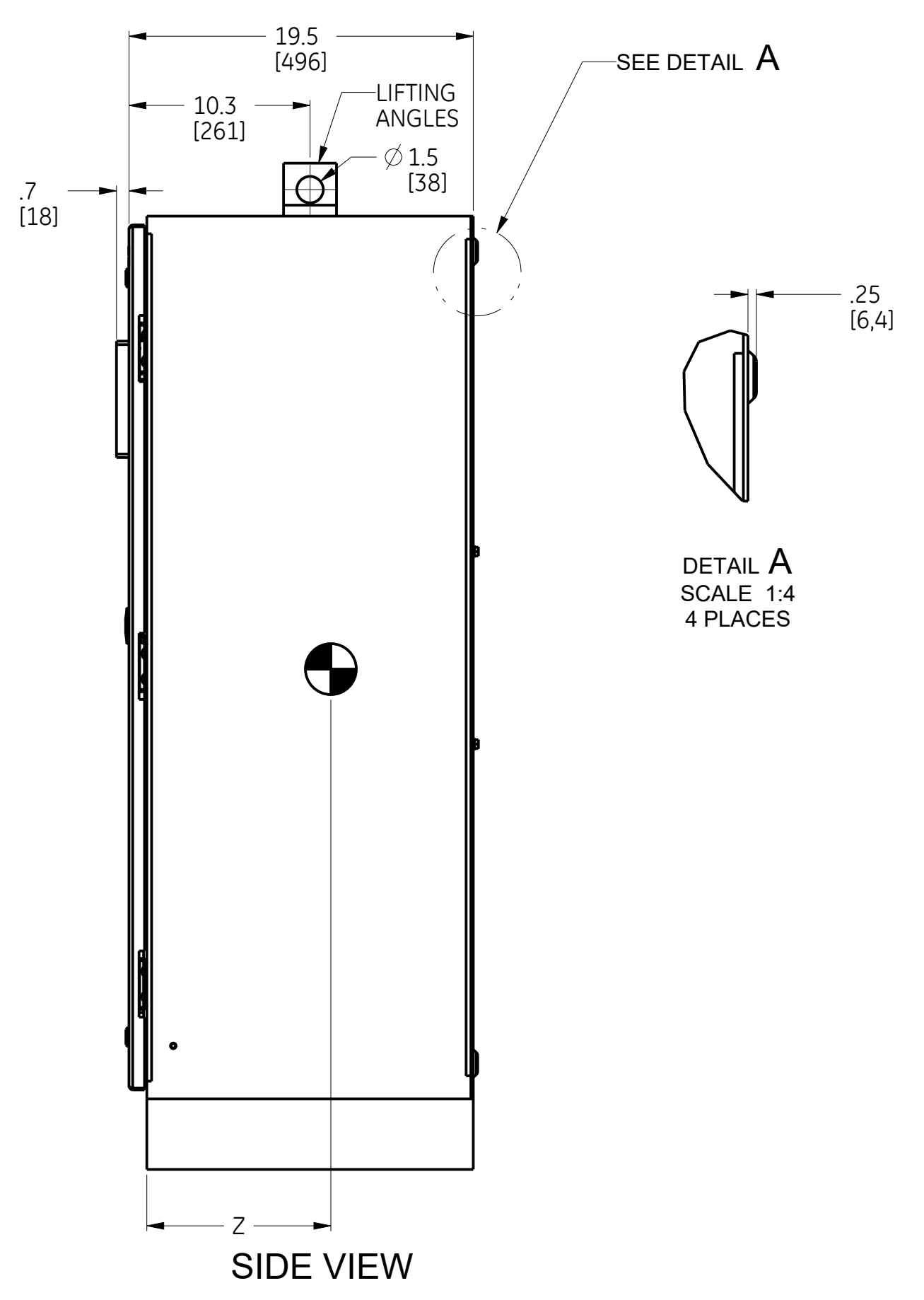
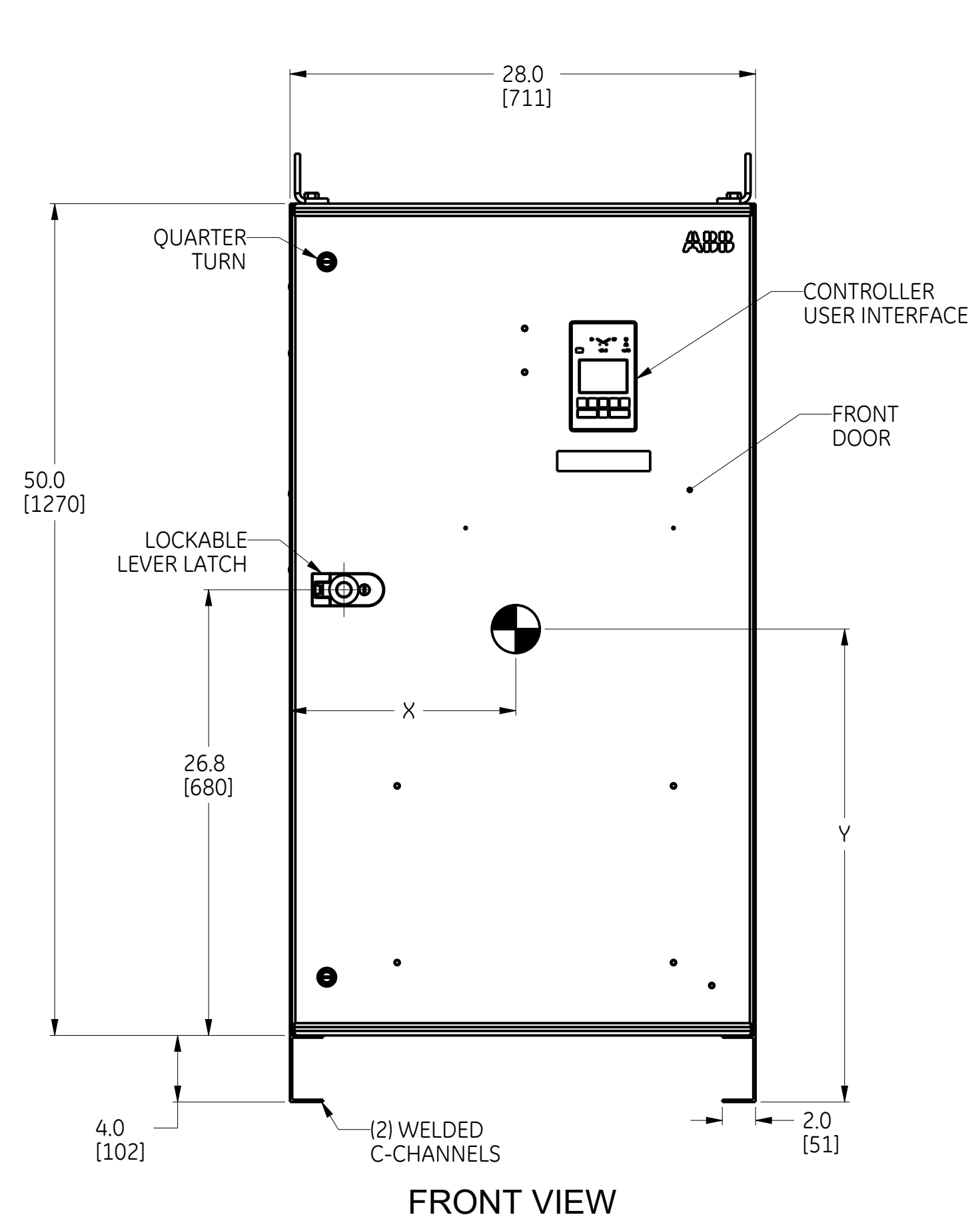

AMP	POLE	CONTROLLER TYPE	CABINET #	LUG RANGE	WEIGHT LB(KG)	CENTER OF GRAVITY IN(MM)		
						X	Y	Z
600A	2	SEE TABLE A	F-2014MP	QTY 2 2 AWG-600 KCMIL	278(126)	13.7 (348)	28.1 (714)	10.3 (262)
	3				284(129)			
	4				290(132)			

TYPE	TRANSITION	LEVEL	PART NO.
ZTX	OPEN	2	OXAMI1-L2
ZTG	OPEN	3	OXAMI1-L3
ZTGD	DELAYED	3	OXBM1-L3

- NOTES**
- ENCLOSURE : NEMA-1 TYPE, FREE STANDING, FLOOR MOUNT.
  - MATERIAL: 12 GA (.105) 1018 HRS REF.
  - FINISH : ANSI 61 GREY
  - CONSTRUCTION PER UL 1008 STANDARD.
  - FRONT ACCESSIBLE UNIT. NO SIDE OR REAR ACCESS REQUIRED.
  - SUITABLE WIRE BENDING SPACE PROVIDED PER THE SAFETY AGENCY STANDARDS.
  - UL AND CSA RECOGNIZED/CERTIFIED MECHANICAL LUGS ARE STANDARD.
  - EQUIPMENT GROUND LUG IS PROVIDED IN ALL UNITS. REFER SHEET 2 FOR DETAILS.
  - ALL DIMENSIONS ARE FOR REFERENCE ONLY AND SHOWN IN INCHES(MILLIMETERS).
  - 100% RATED SOLID/SWITCHED NEUTRAL PROVIDED PER THE SWITCH CONFIGURATION.
  - SUITABLE FOR TOP AND/OR BOTTOM CABLE ENTRY.

- SEISMIC NOTES:**
- BOLT ENCLOSURE FROM C-CHANNEL BASE USING THE FOLLOWING SEISMIC CERTIFIED MOUNTING HARDWARE PER MOUNTING HOLE: (HARDWARE PROVIDED BY INSTALLER).  
 \*1/2-13 GRADE 5 BOLT TORQUE TO 70 FT-LBS. (95 NEWTON METERS).  
 \*1/2-13 STANDARD FLAT WASHER.  
 \*1/2 (13) HELICAL SPRING LOCK WASHER.
  - CENTER OF GRAVITY DIMENSIONS ARE FOR REFERENCE ONLY.
  - FOR WORKING CLEARANCE REFER TO NATIONAL AND LOCAL CODES AND STANDARDS.

DRAWING FILE		MODEL FILE		<b>ABB</b>		
50C-1066		50C-1066				
DATE MODIFIED		DESIGNED BY		<b>TruONE LAYOUT, 600A WITH NEMA-1 CABINET</b>		
06-May-19 10:25:02 AM		DV				
APPROVED BY		SR		UNITS: in LOCAL TITLE: ---		
C066449		Critical to Quality Characteristic				
VOLUME		---		SCALE: 13:100 PRODUCT LINE: ZTX/ZTG(D) SHEET: 1 of 2		
0.000 in^3		---				
MASS		---		SIZE: D ROOT NUMBER: 50C-1066 REV: 1 RELEASE STATE: In Work		
0.000 lbm		---				
TOLERANCE ON: 1 PL DECIMALS: ± 0.1 2 PL DECIMALS: ± 0.02 3 PL DECIMALS: ± 0.005 ANGLE: ± 1.0		---		---		
UNLESS OTHERWISE SPECIFIED		---				

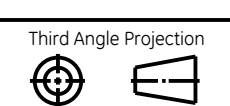

28 27 26 25 24 23 22 21

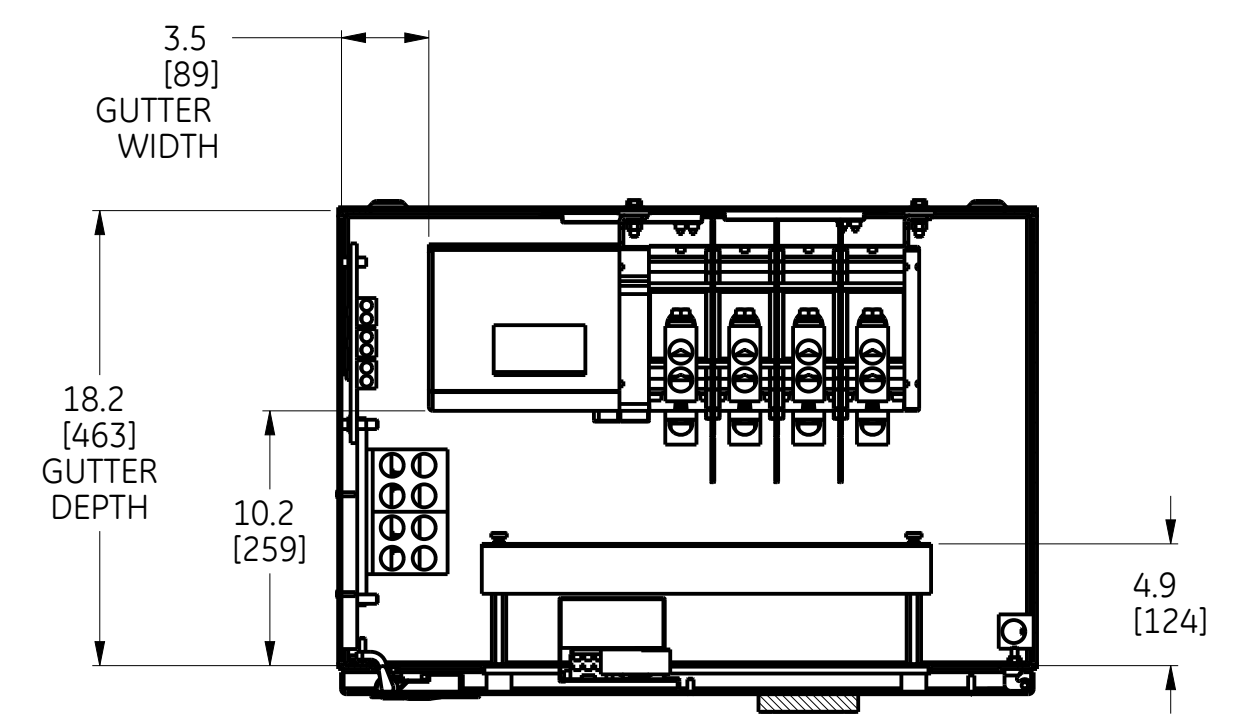

SECTION B-B  
TOP VIEW  
WITHOUT TOP PANEL

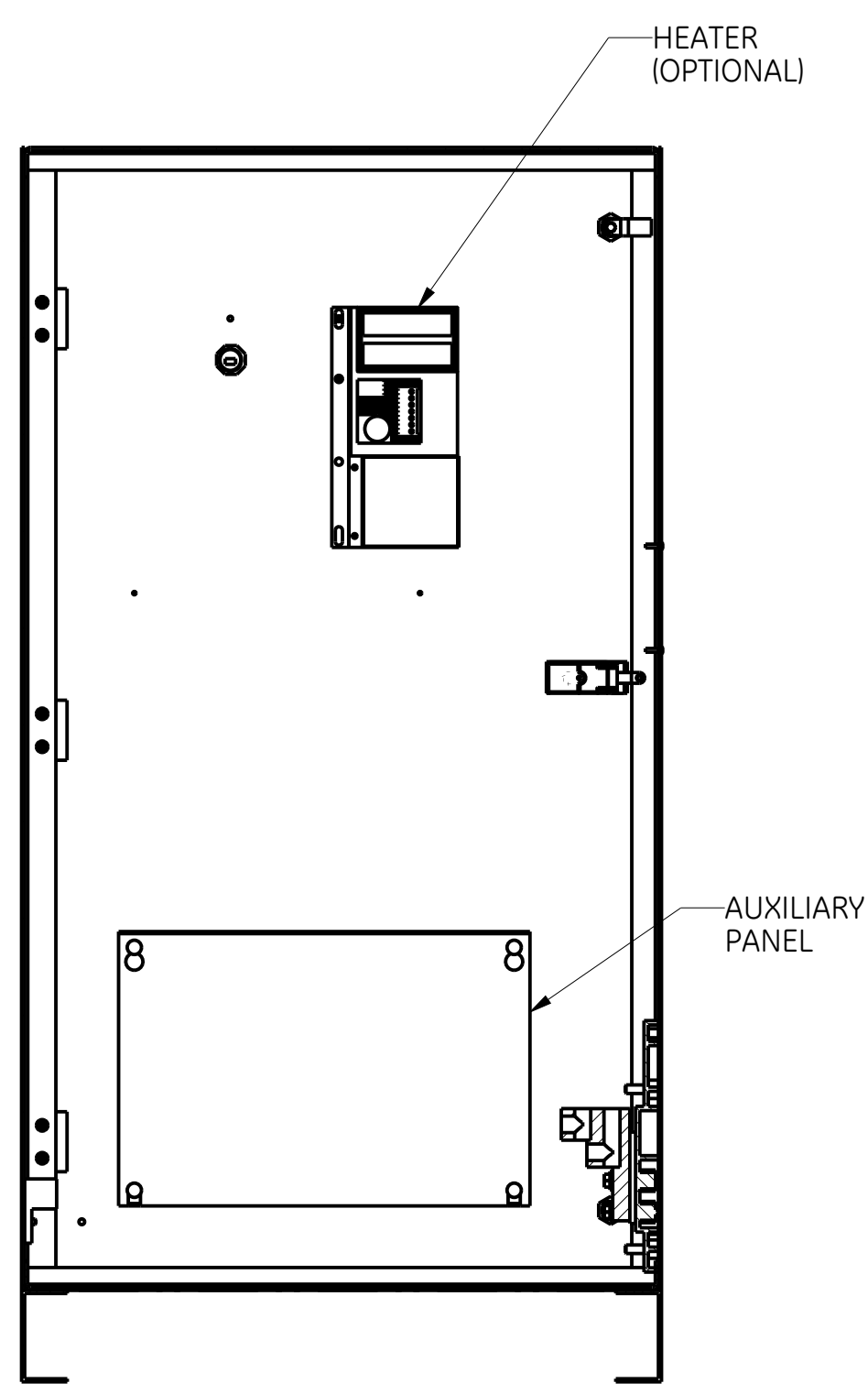

SECTION D-D  
DOOR INSIDE VIEW

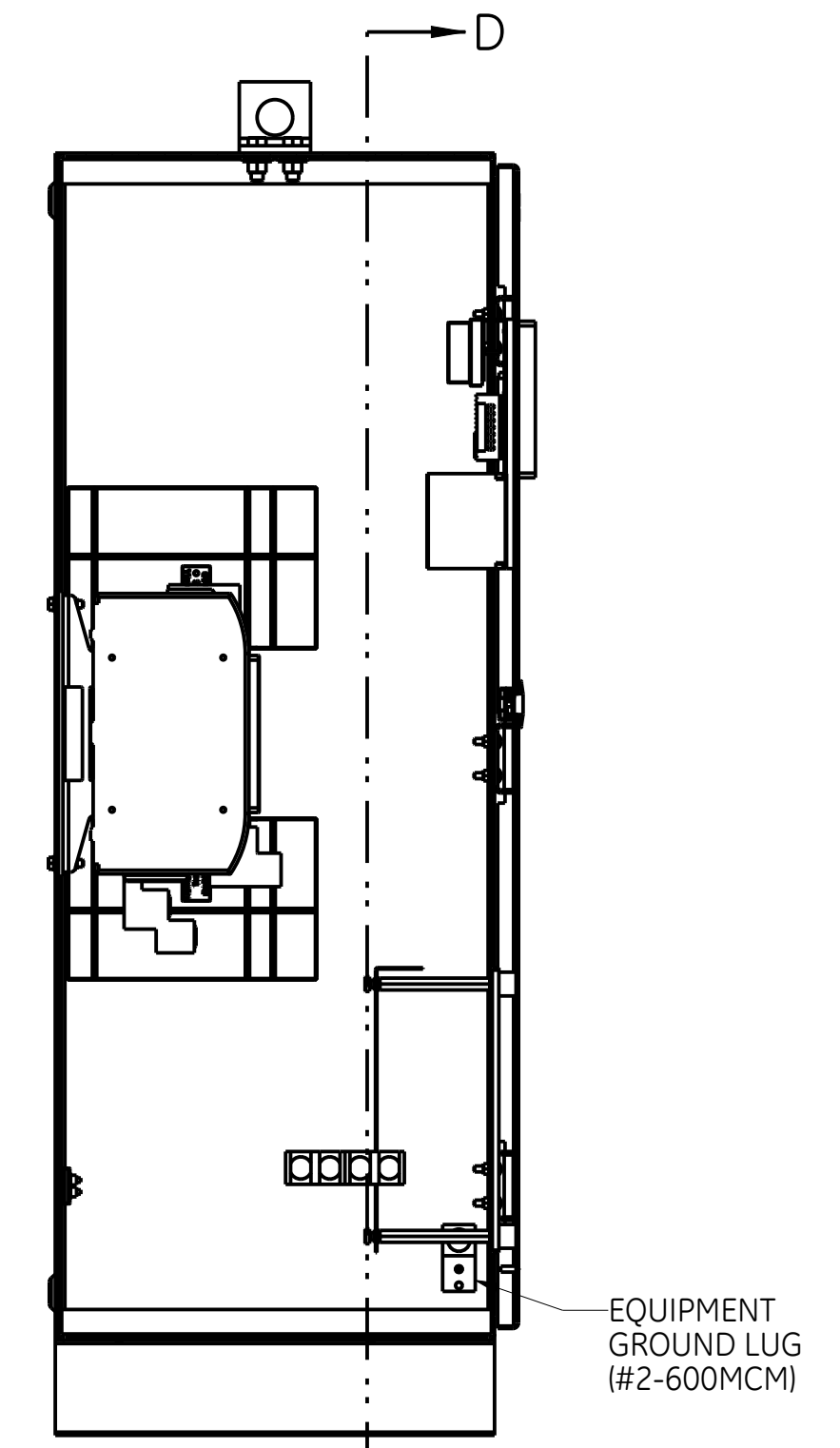

SECTION A-A  
LEFT VIEW  
WITHOUT SIDE PANEL

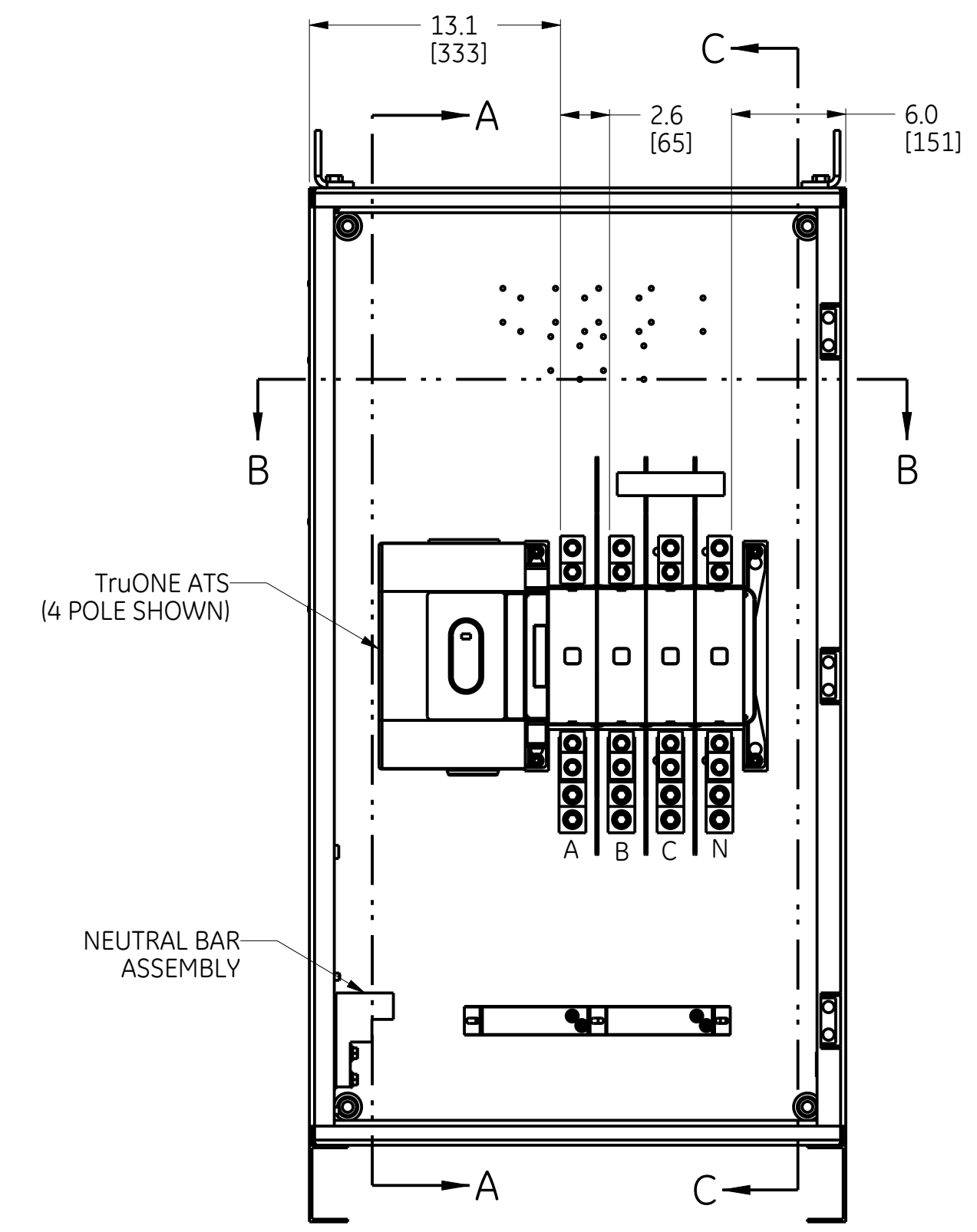

FRONT VIEW  
WITHOUT DOOR

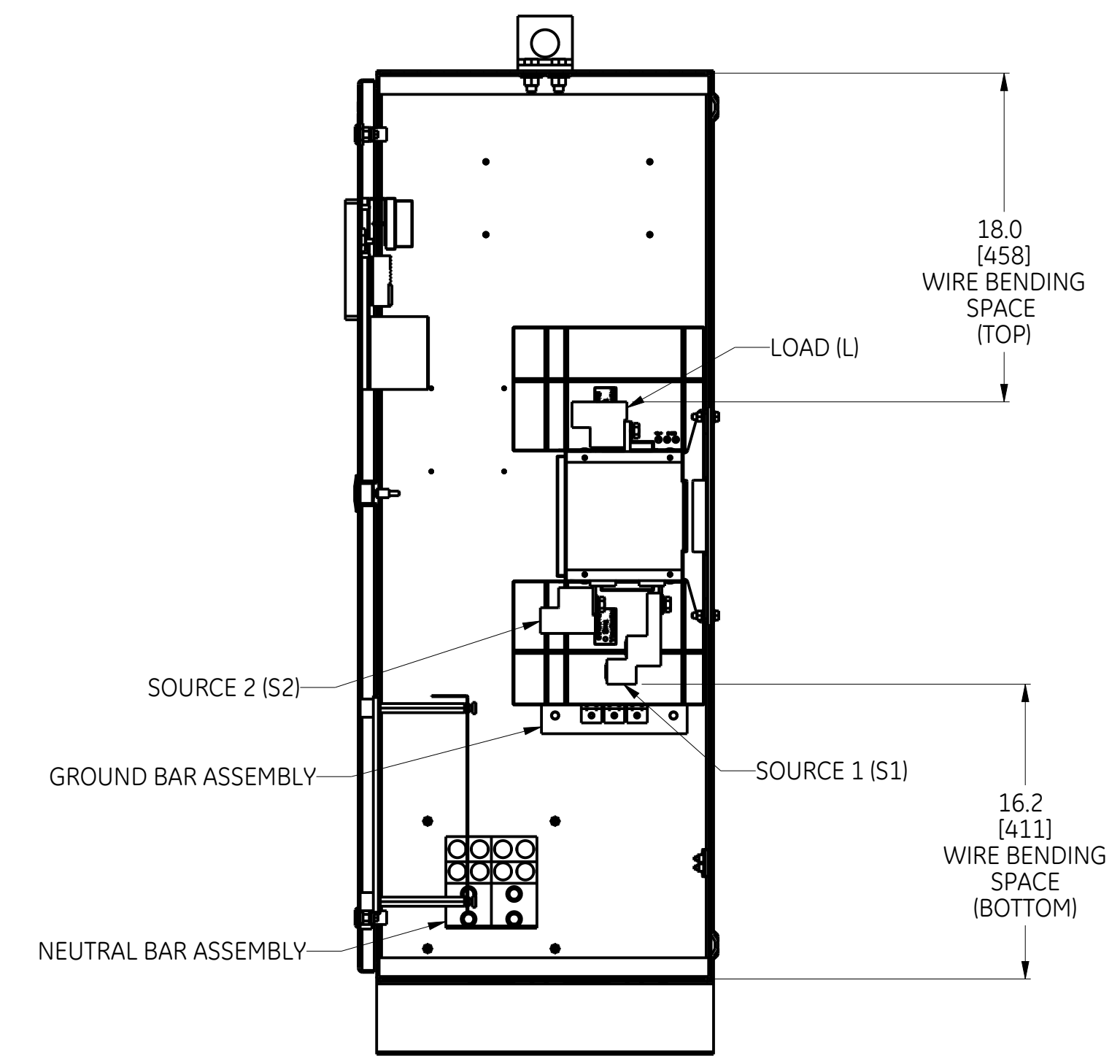

SECTION C-C  
RIGHT SIDE VIEW  
WITHOUT SIDE PANEL

NOTE:  
1. REFER TO SHEET (1) FOR COMPLETE NOTE DETAILS  
2. MECHANICAL LUGS SHOWN IN ABOVE VIEWS ARE FOR REFERENCE ONLY.

ABB PROPRIETARY AND CONFIDENTIAL INFORMATION  
The information contained in this document has to be kept strictly confidential. Any unauthorized use, reproduction, distribution or disclosure to third parties is strictly forbidden. All rights reserved. © 2018 ABB.

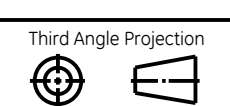

<b>ABB</b>		
SIZE D	NUMBER 50C-1066	REV 1
SCALE 13:100	PRODUCT LINE ZTX/ZTG(D)	SHEET 2 of 2

28 27 26 25 24 23 22 21