

3D Model is the Master Document of Record
 Article or National Must Conform to IEC 61439-1 Procedure 5000000 Sec.1.4
 Part Must Conform to IEC 61439-1 Procedure 5000000 Sec.1.3
 Geometric Dimensioning & Tolerancing as per ASME Y14.5-2009

ABB PROPRIETARY AND CONFIDENTIAL INFORMATION
 The information contained in this document has to be kept strictly confidential.
 Any unauthorized use, disclosure, or distribution of this document is strictly forbidden.
 ABB reserves all rights regarding intellectual property rights.
 Copyright 2018 ABB. All rights reserved.

NEMA 4 AND 12
 SAME AS 3R EXCEPT AS SHOWN

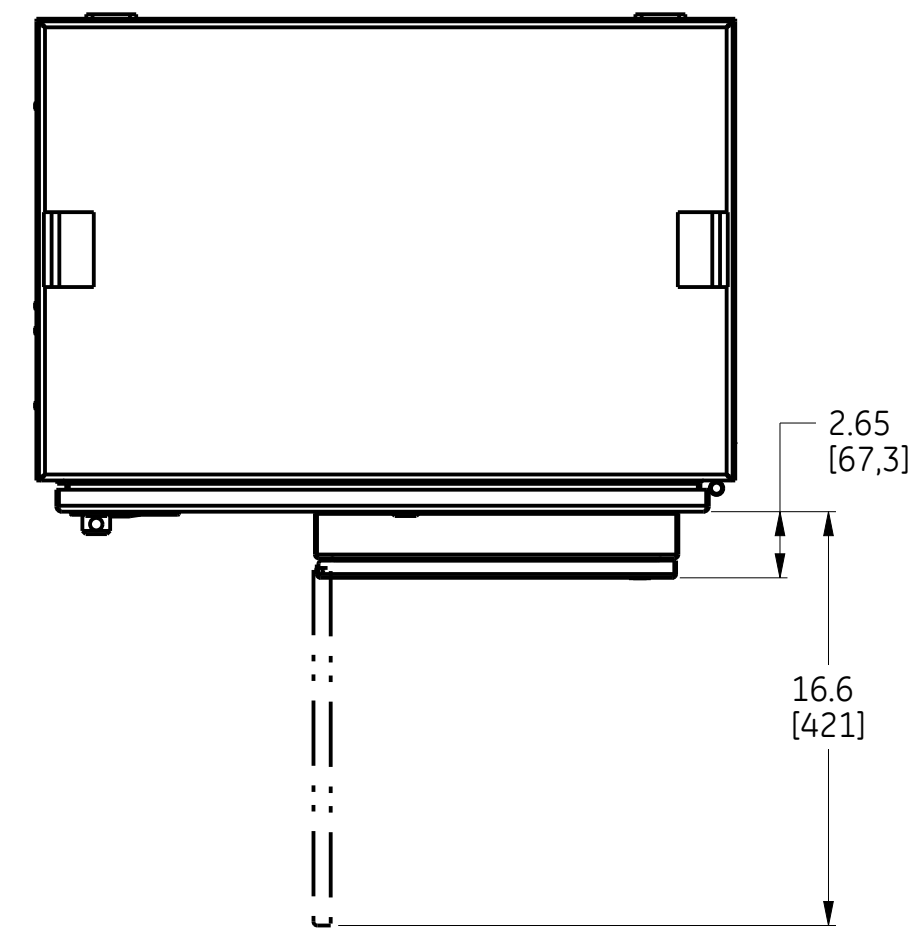

TOP VIEW

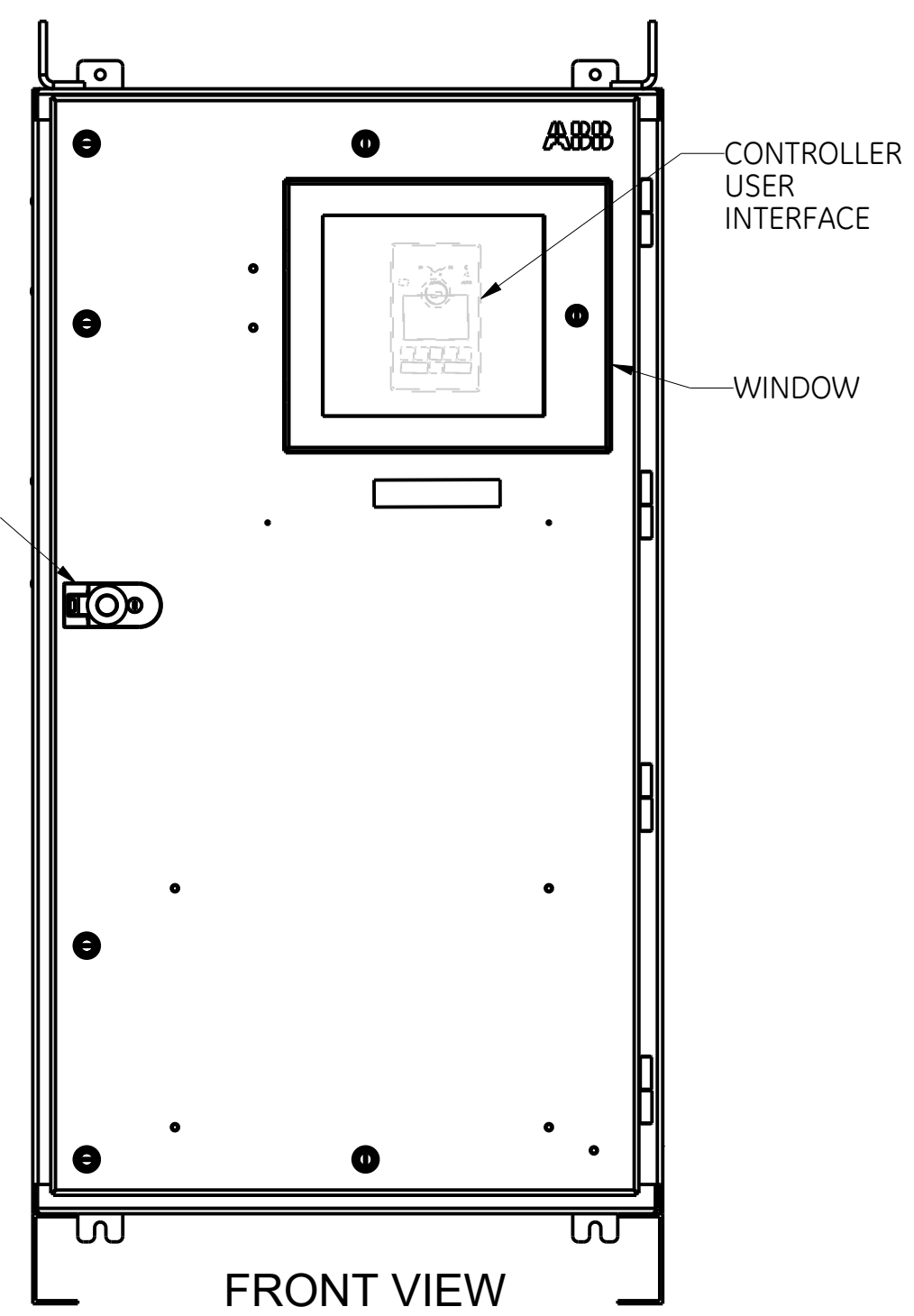

FRONT VIEW

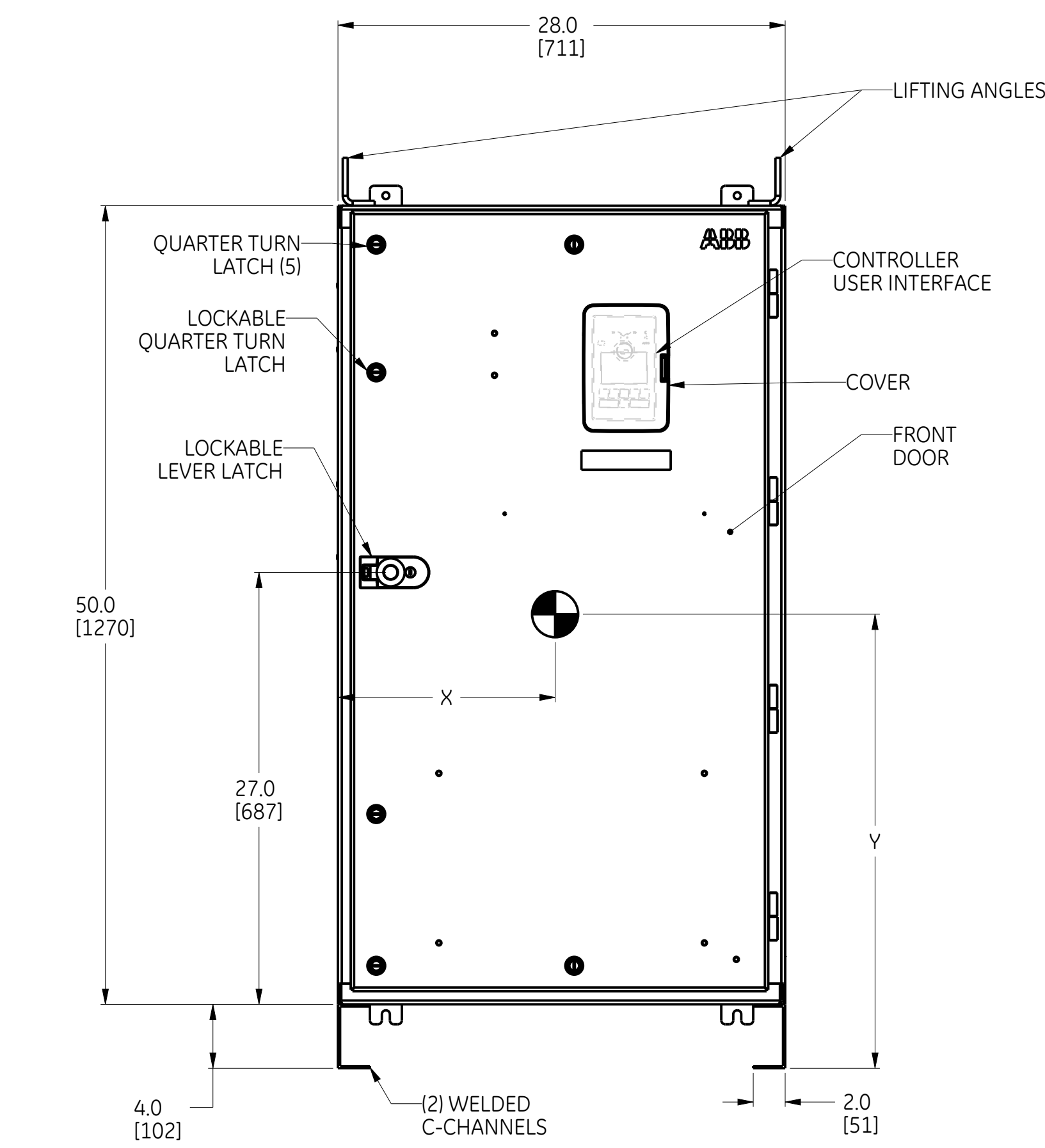

FRONT VIEW

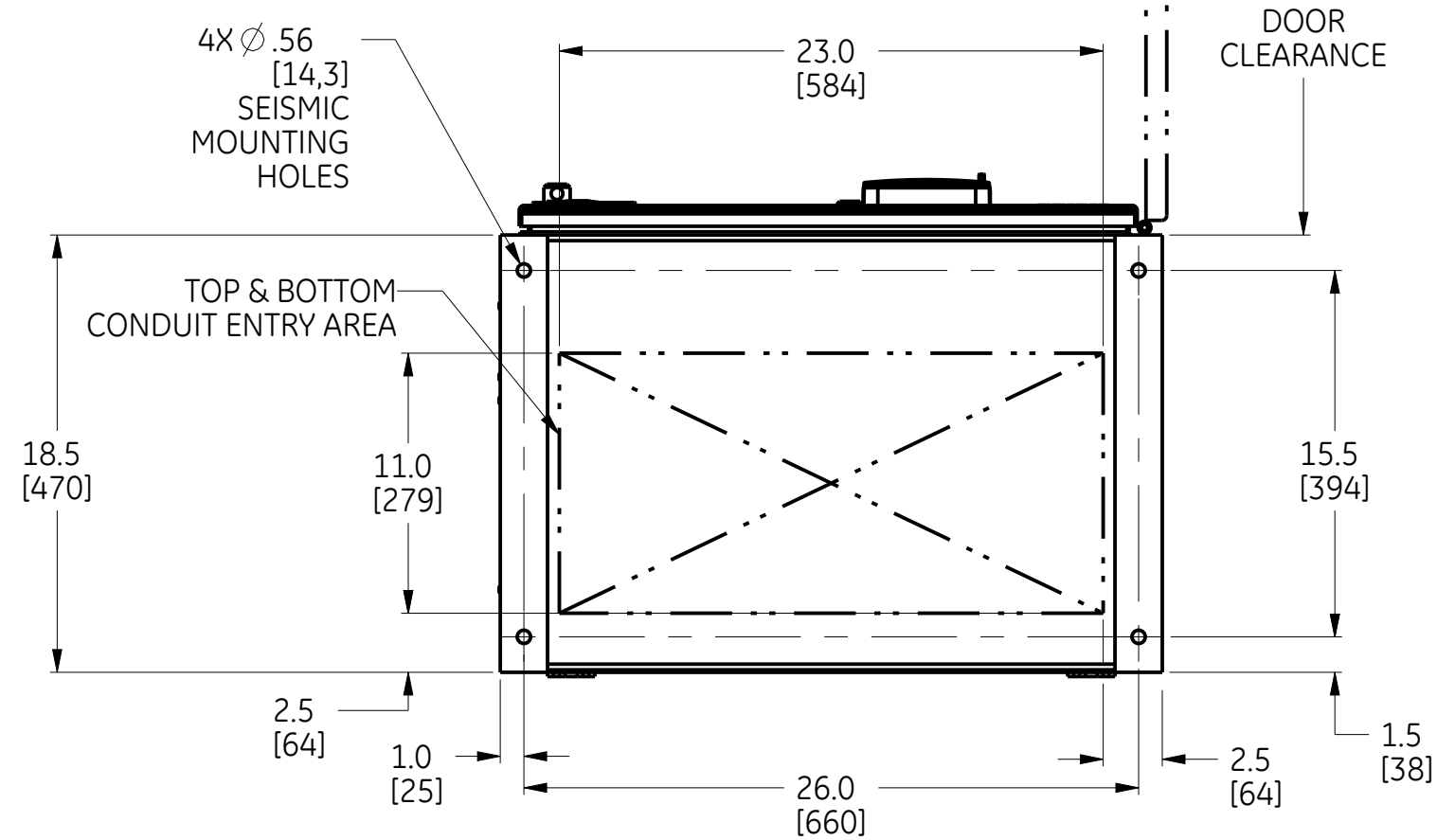

BOTTOM VIEW

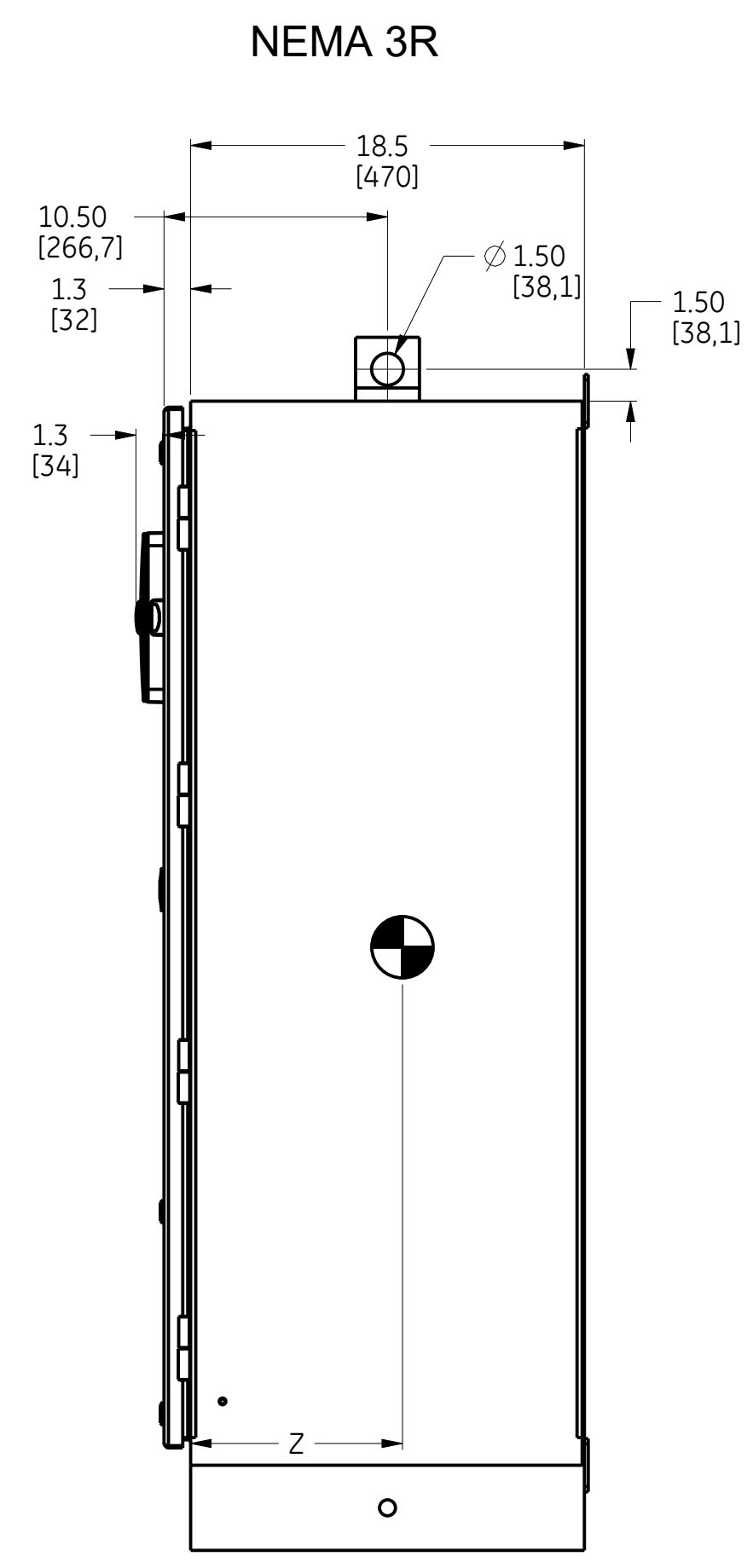

SIDE VIEW

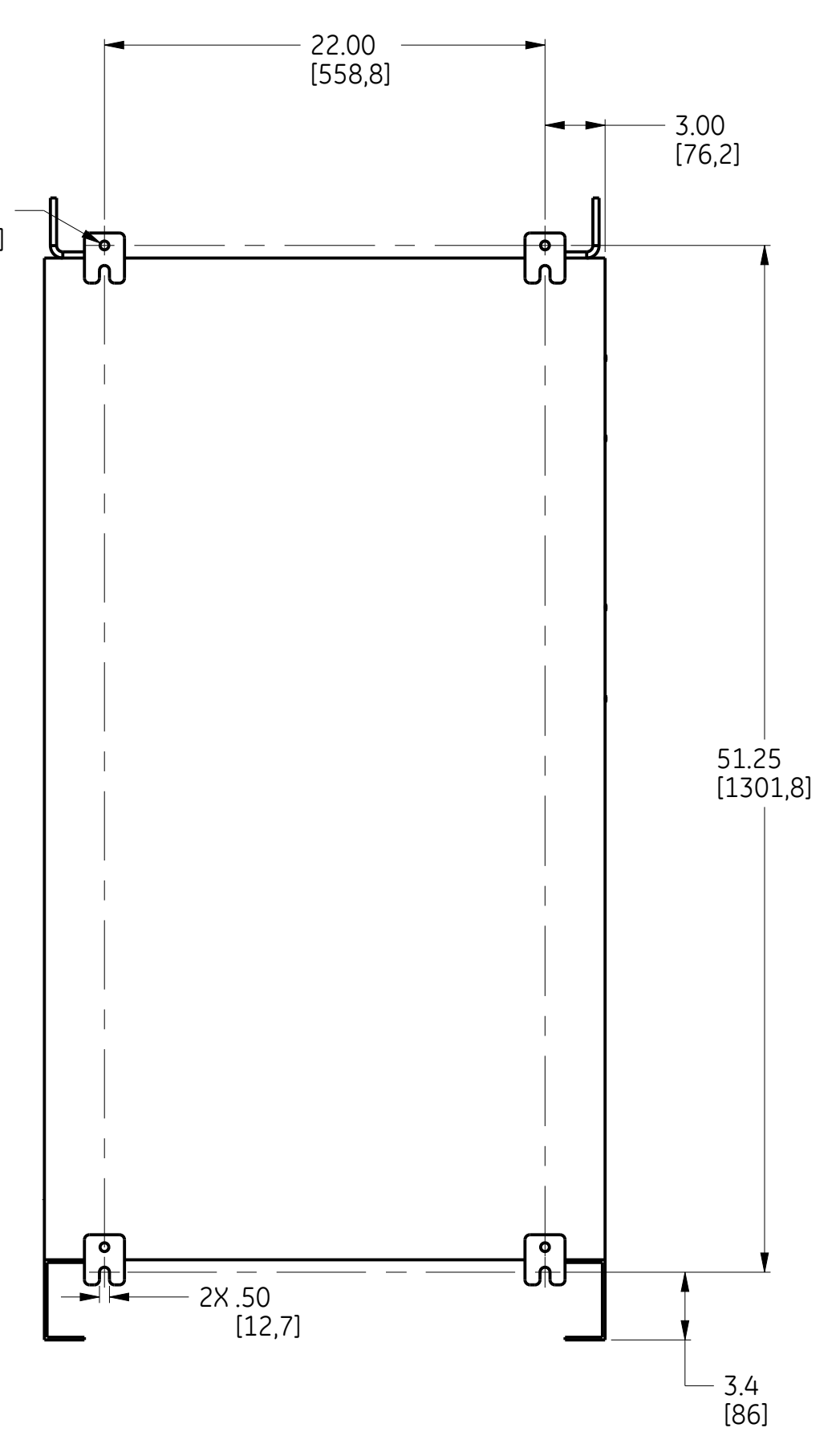

REAR VIEW

- NOTES**
- ENCLOSURE : NEMA-3R TYPE, FREE STANDING, FLOOR MOUNT.
 - MATERIAL: 12 GA (.105) 1018 HRS REF.
 - FINISH : ANSI 61 GREY
 - CONSTRUCTION PER UL 1008 STANDARD.
 - FRONT ACCESSIBLE UNIT. NO SIDE OR REAR ACCESS REQUIRED.
 - SUITABLE WIRE BENDING SPACE PROVIDED PER THE SAFETY AGENCY STANDARDS.
 - UL AND CSA RECOGNIZED/CERTIFIED MECHANICAL LUGS ARE STANDARD.
 - EQUIPMENT GROUND LUG IS PROVIDED IN ALL UNITS. REFER SHEET 2 FOR DETAILS.
 - ALL DIMENSIONS ARE FOR REFERENCE ONLY AND SHOWN IN INCHES(MILLIMETERS).
 - 100% RATED SOLID/SWITCHED NEUTRAL PROVIDED PER THE SWITCH CONFIGURATION.
 - SUITABLE FOR TOP AND/OR BOTTOM CABLE ENTRY.

SEISMIC NOTES:

- BOLT ENCLOSURE FROM C-CHANNEL BASE USING THE FOLLOWING SEISMIC CERTIFIED MOUNTING HARDWARE PER MOUNTING HOLE: (HARDWARE PROVIDED BY INSTALLER).
 *1/2-13 GRADE 5 BOLT TORQUE TO 70 FT-LBS. (95 NEWTON METERS).
 *1/2-13 STANDARD FLAT WASHER.
 *1/2 (13) HELICAL SPRING LOCK WASHER.
- CENTER OF GRAVITY DIMENSIONS ARE FOR REFERENCE ONLY.
- FOR WORKING CLEARANCE REFER TO NATIONAL AND LOCAL CODES AND STANDARDS.

AMP	POLE	CONTROLLER TYPE	CABINET #	LUG RANGE	WEIGHT	CENTER OF GRAVITY IN(MM)		
					LB(KG)	X	Y	Z
600A	2	SEE TABLE A	F-2015MP	QTY 2 2 AWG-600 KCMIL	313(142)	13.7 (348)	28.1 (714)	9.7 (246)
	3				319(144)			
	4				324(147)			

TYPE	TRANSITION	LEVEL	PART NO.
ZTX	OPEN	2	OXAMI1-L2
ZTG	OPEN	3	OXAMI1-L3
ZTGD	DELAYED	3	OXBMI1-L3

DRAWING FILE: 50C-1067		MODEL FILE: 50C-1067		ABB	
DATE MODIFIED: 20-May-19 01:32:58 PM		DESIGNED BY: DV			
VOLUME: 0.000 in^3		APPROVED BY: SR		TITLE: TruONE LAYOUT, 600A WITH NEMA 3R, 4, 12 TYPE CABINET	
MASS: 0.000 lbm		MATERIAL SPECIFICATION: ---		UNITS: in	
UNLESS OTHERWISE SPECIFIED		FINISH SPECIFICATION: ---		SCALE: 13:100	
TOLERANCE ON: 1 PL DECIMALS: ± 0.1 2 PL DECIMALS: ± 0.02 3 PL DECIMALS: ± 0.005 ANGLES: ± 1.0		MATERIAL DESCRIPTION: ---		PRODUCT LINE: ZTX/ZTG(D)	
SIZE: D		ROOT NUMBER: 50C-1067		RELEASE STATE: In Work	
SCALE: 13:100		REV: 1		SHEET: 1 of 2	

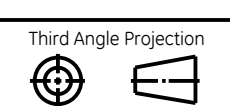

Third Angle Projection

28 27 26 25 24 23 22 21

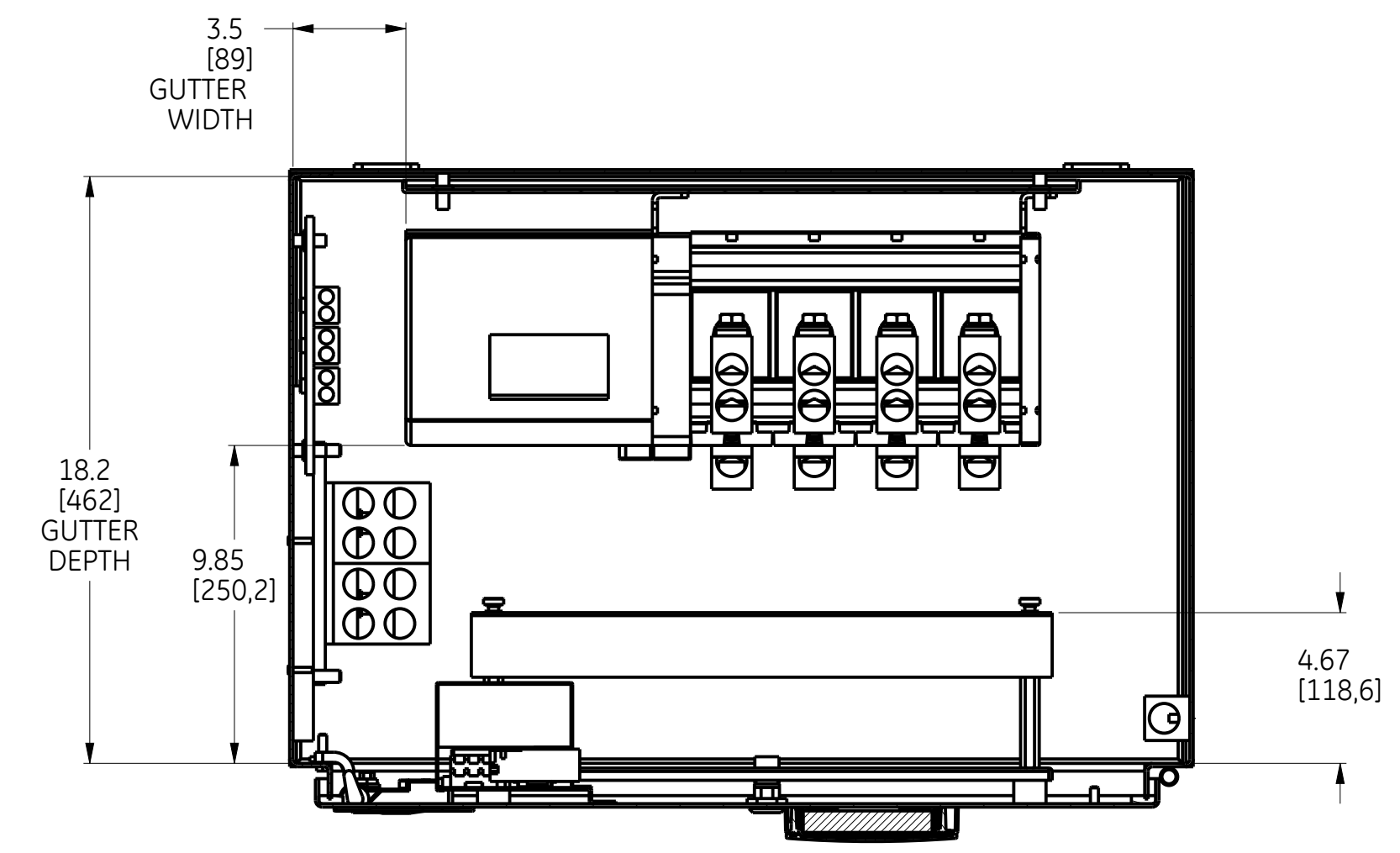

SECTION B-B
TOP VIEW
WITHOUT TOP PANEL

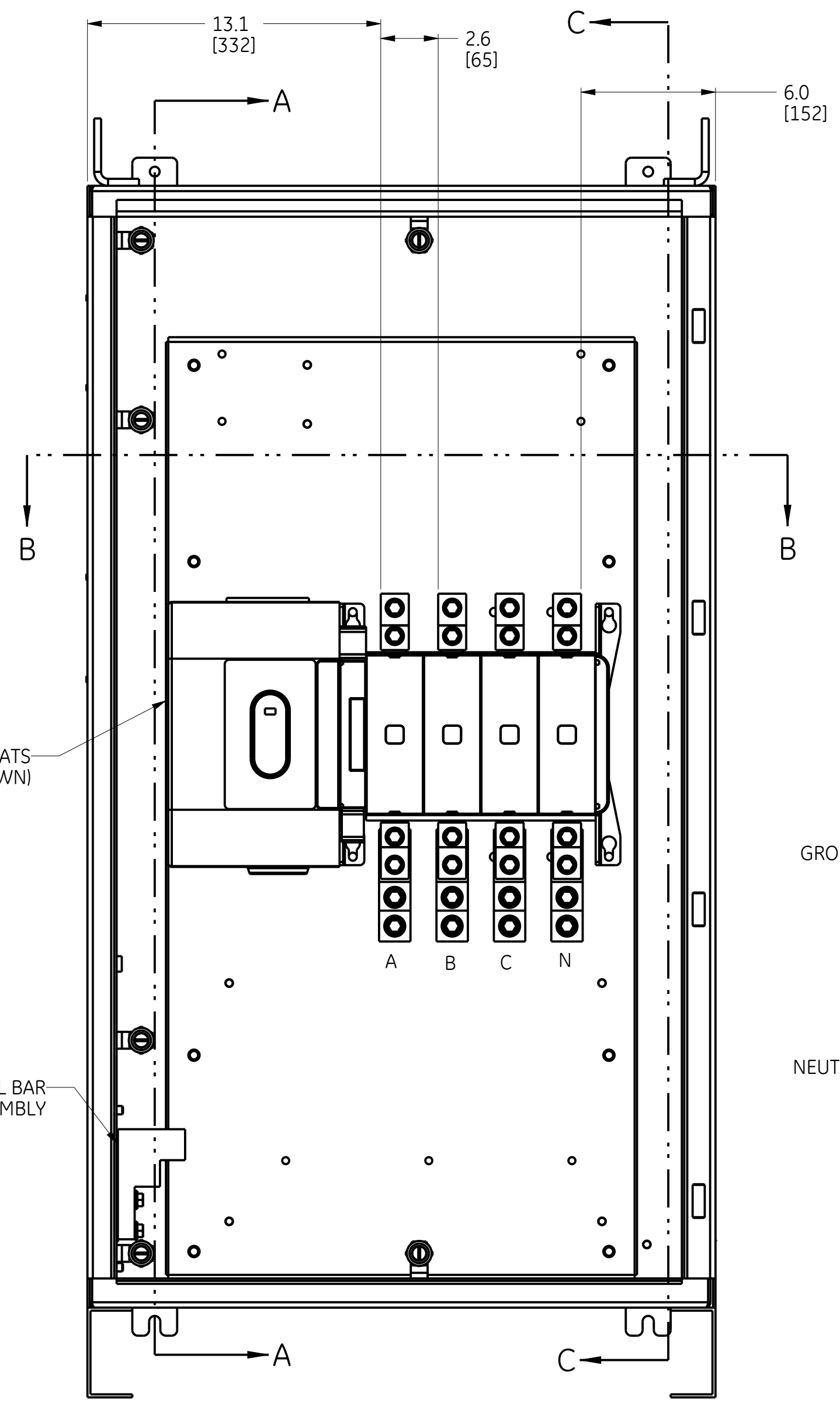

FRONT VIEW
WITHOUT DOOR

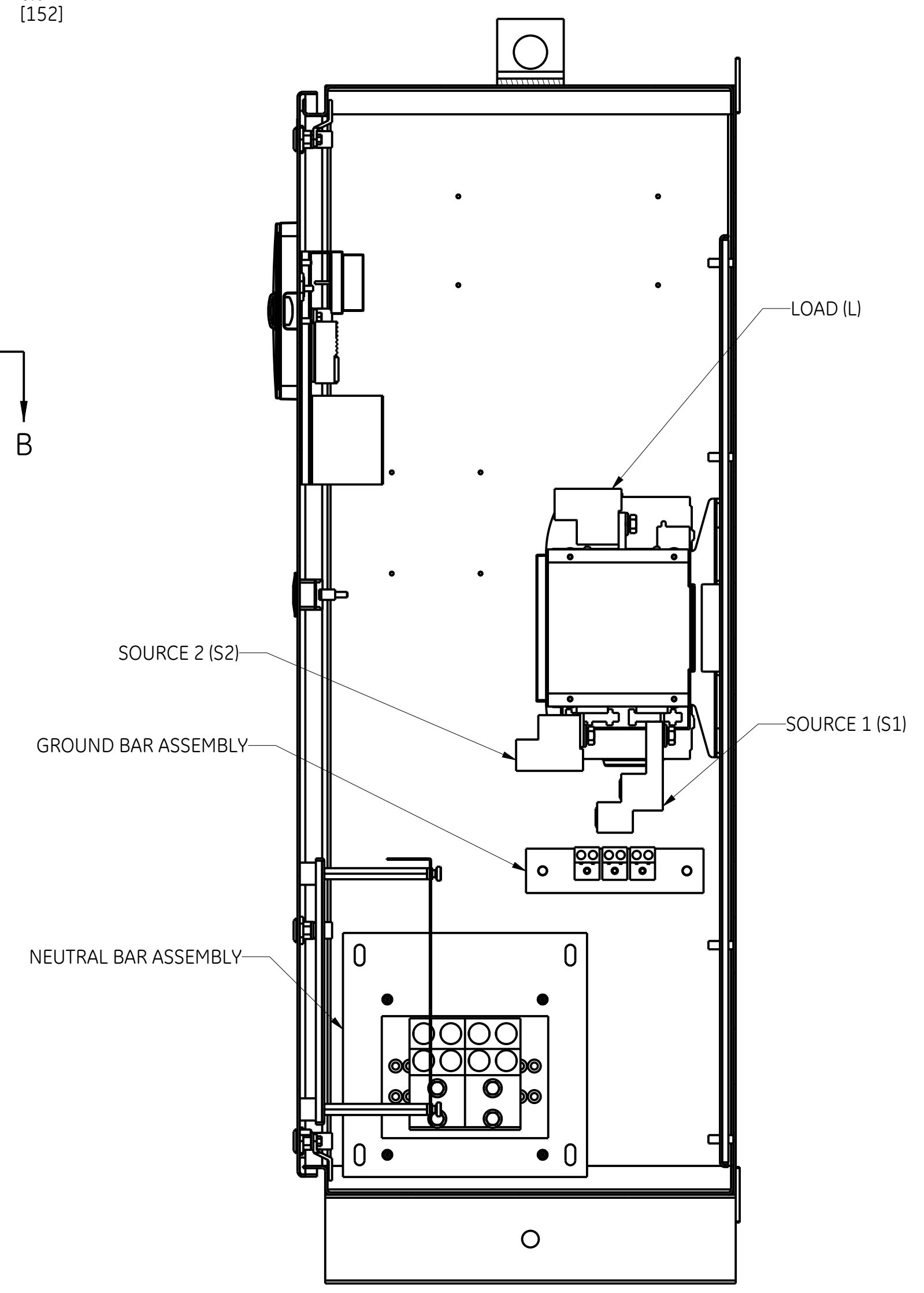

SECTION C-C
RIGHT VIEW
WITHOUT SIDE PANE L

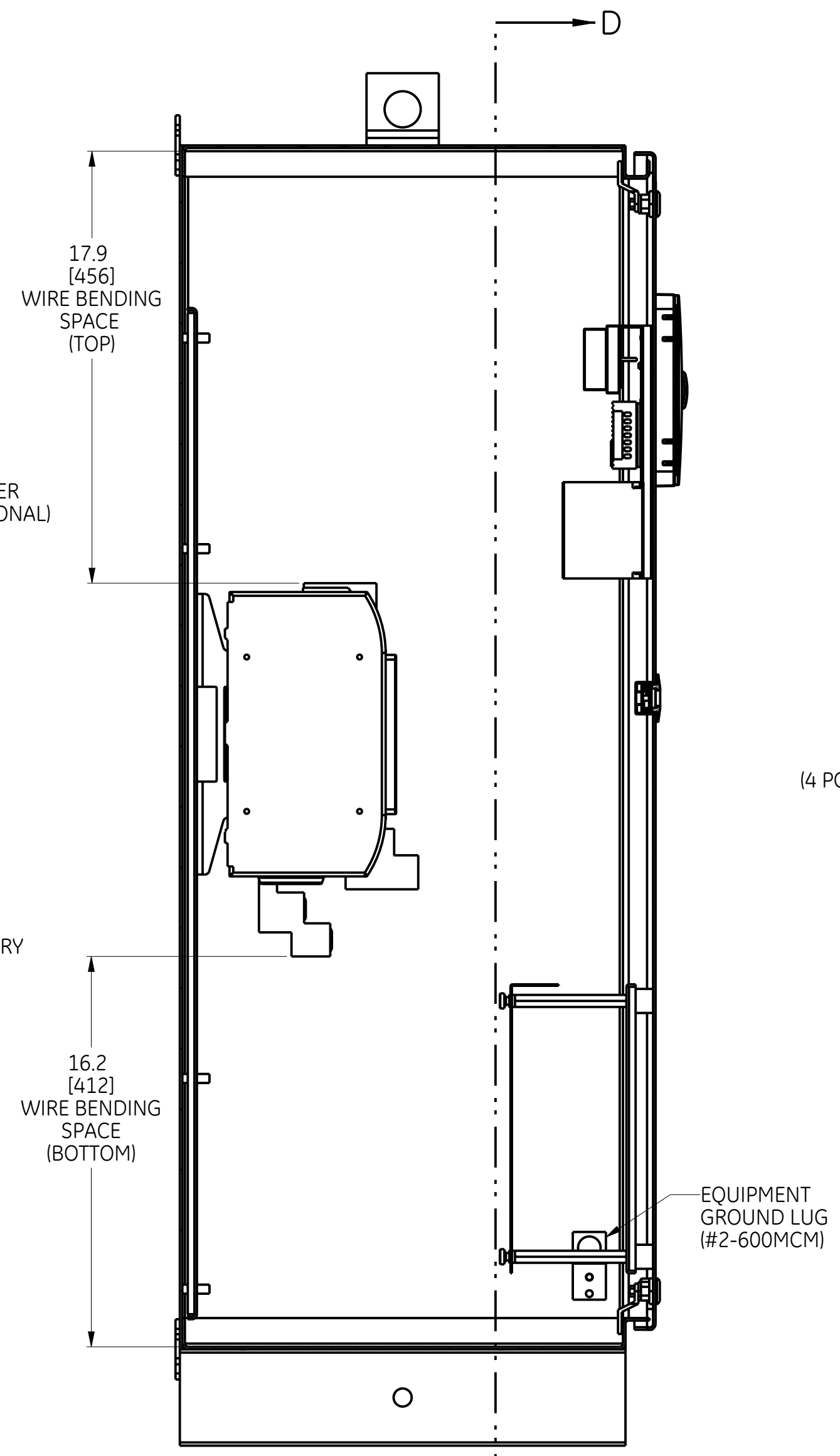

SECTION A-A
LEFT VIEW
WITHOUT SIDE PANEL

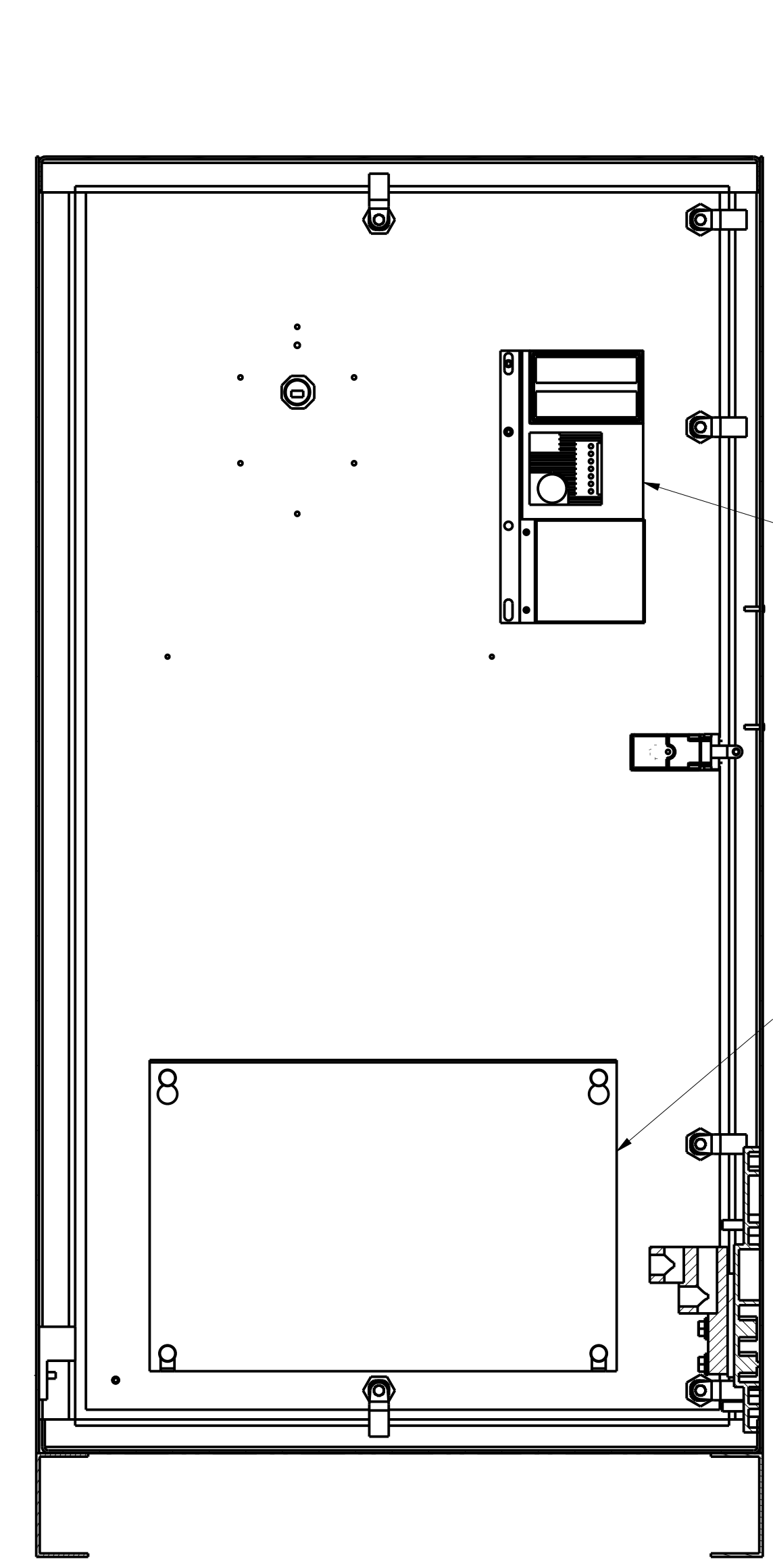

SECTION D-D
DOOR INSIDE VIEW

NOTES:
1. REFER TO SHEET (1) FOR COMPLETE NOTE DETAILS
2. MECHANICAL LUGS SHOWN IN ABOVE VIEWS ARE FOR REFERENCE ONLY.

ABB		
SIZE	NUMBER	REV
D	50C-1067	1
SCALE	PRODUCT LINE	SHEET
1:5	ZTX/ZTG(D)	2 of 2

ABB PROPRIETARY AND CONFIDENTIAL INFORMATION
 The information contained in this document has to be kept strictly confidential. Any unauthorized use, reproduction, distribution or disclosure to third parties is strictly forbidden. All rights reserved. © 2018 ABB.

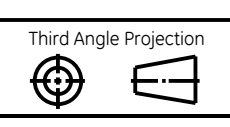

28 27 26 25 24 23 22 21