

3D Model is the Master Document of Record
 Article or National Must Conform to IEC 61439-1 Procedure 5000000 Sec 1.4
 Part Must Conform to 3500000 Sec 4 Toxicity Procedure
 Geometric Dimensioning & Tolerancing as per ASME Y14.5-2009

ABB PROPRIETARY AND CONFIDENTIAL INFORMATION
 The information contained in this document has to be kept strictly confidential.
 Any unauthorized use, disclosure, or distribution of this document is strictly forbidden.
 ABB reserves all rights regarding Intellectual Property Rights.
 Copyright 2018 ABB. All rights reserved.

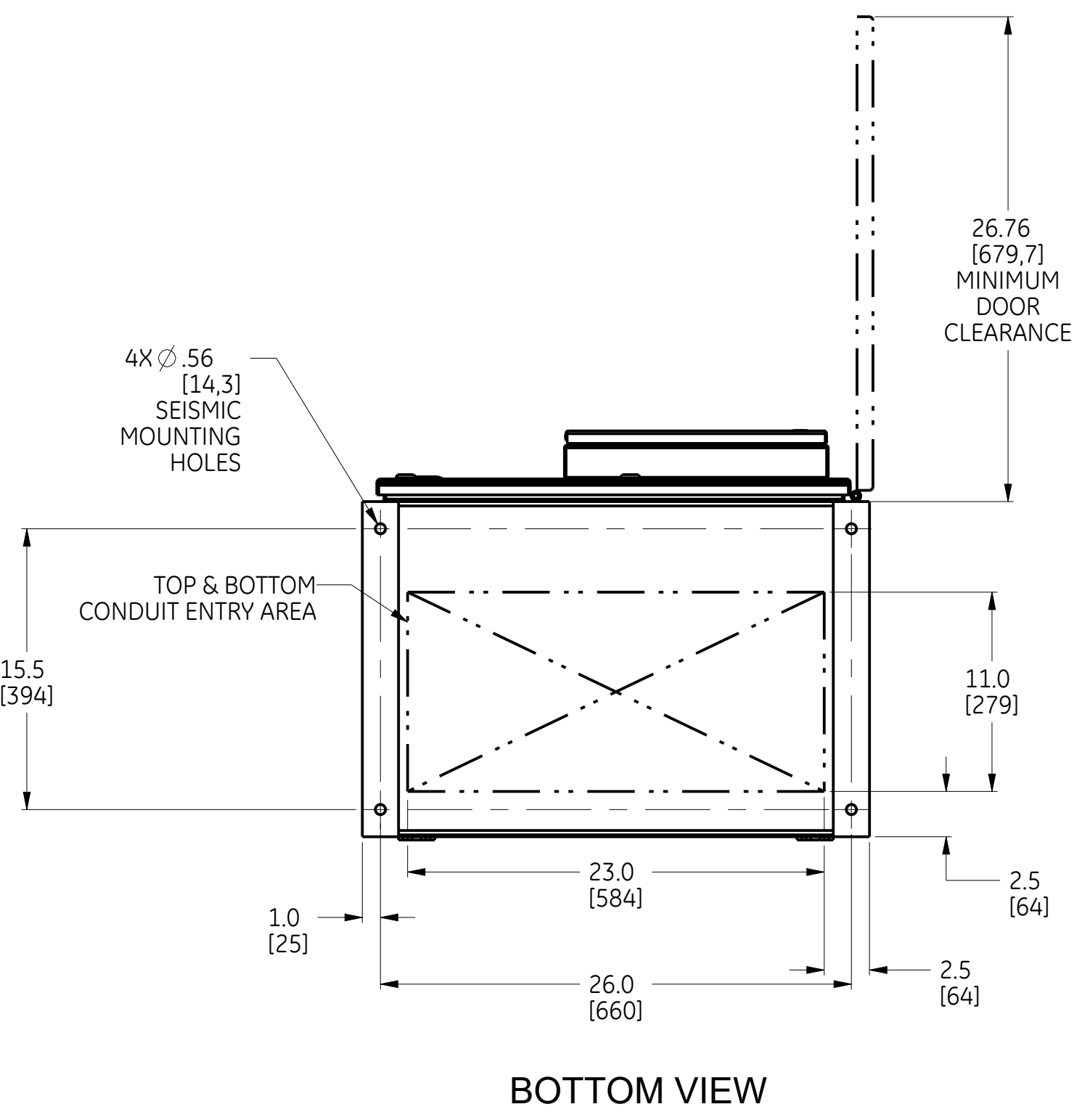
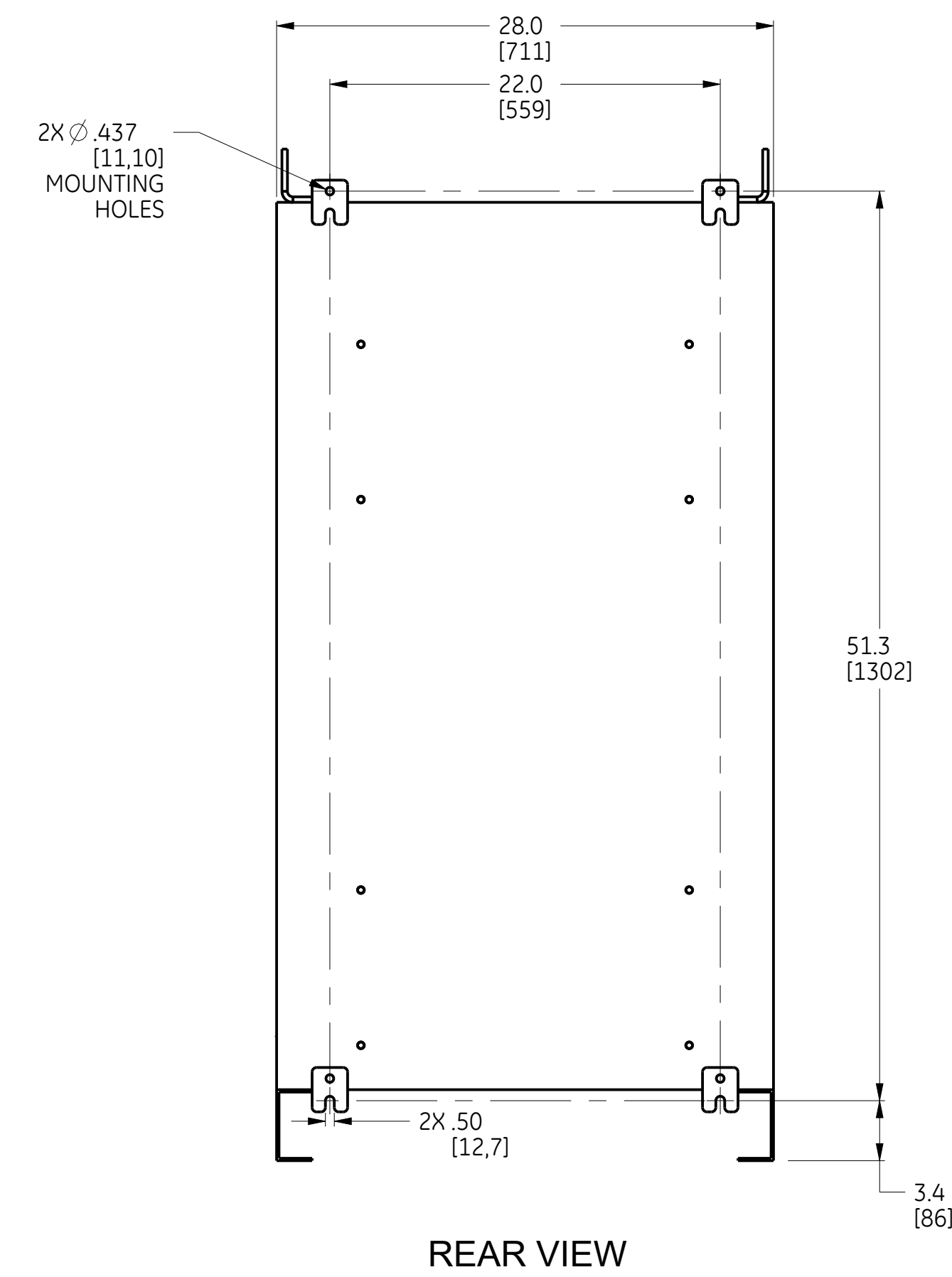
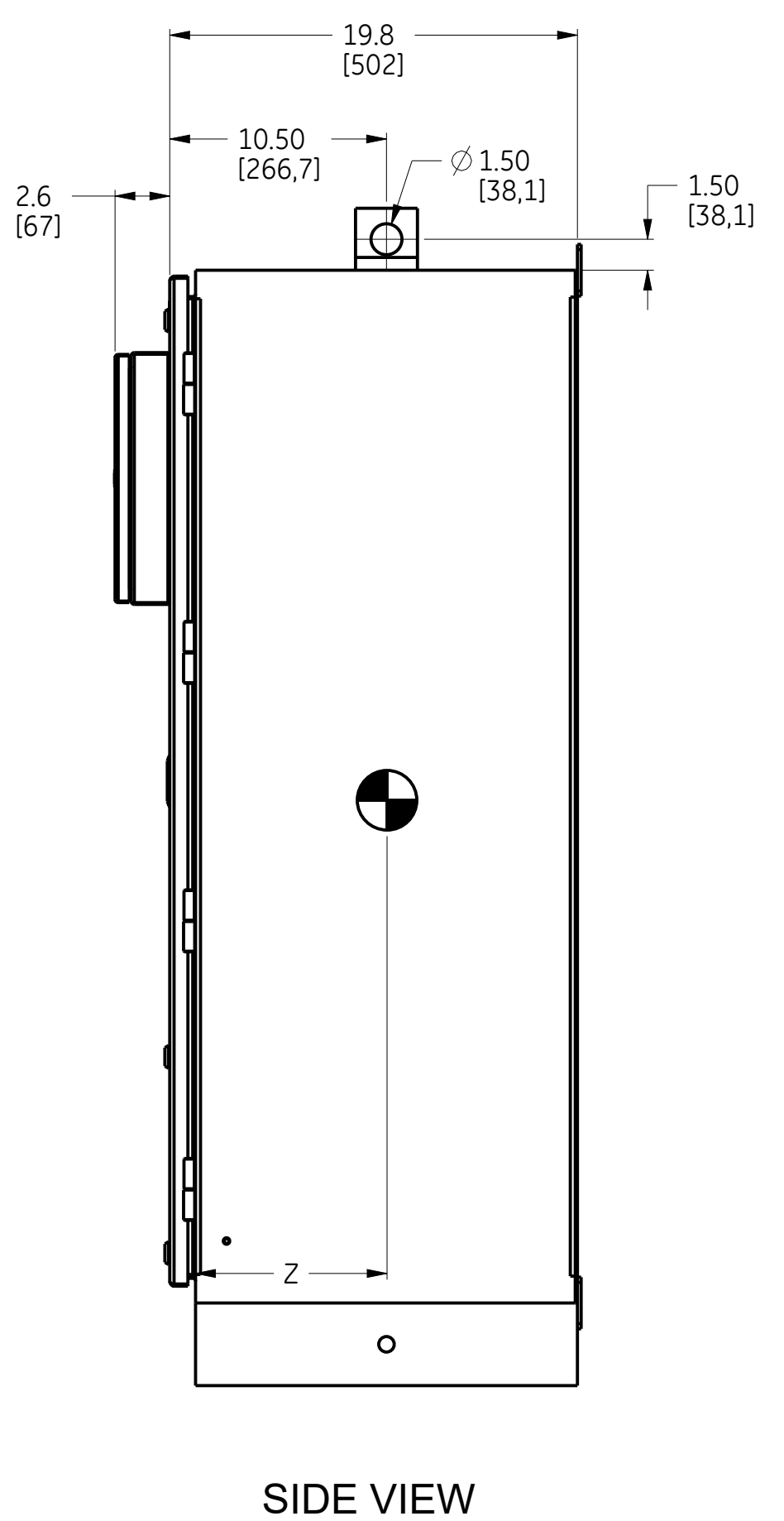
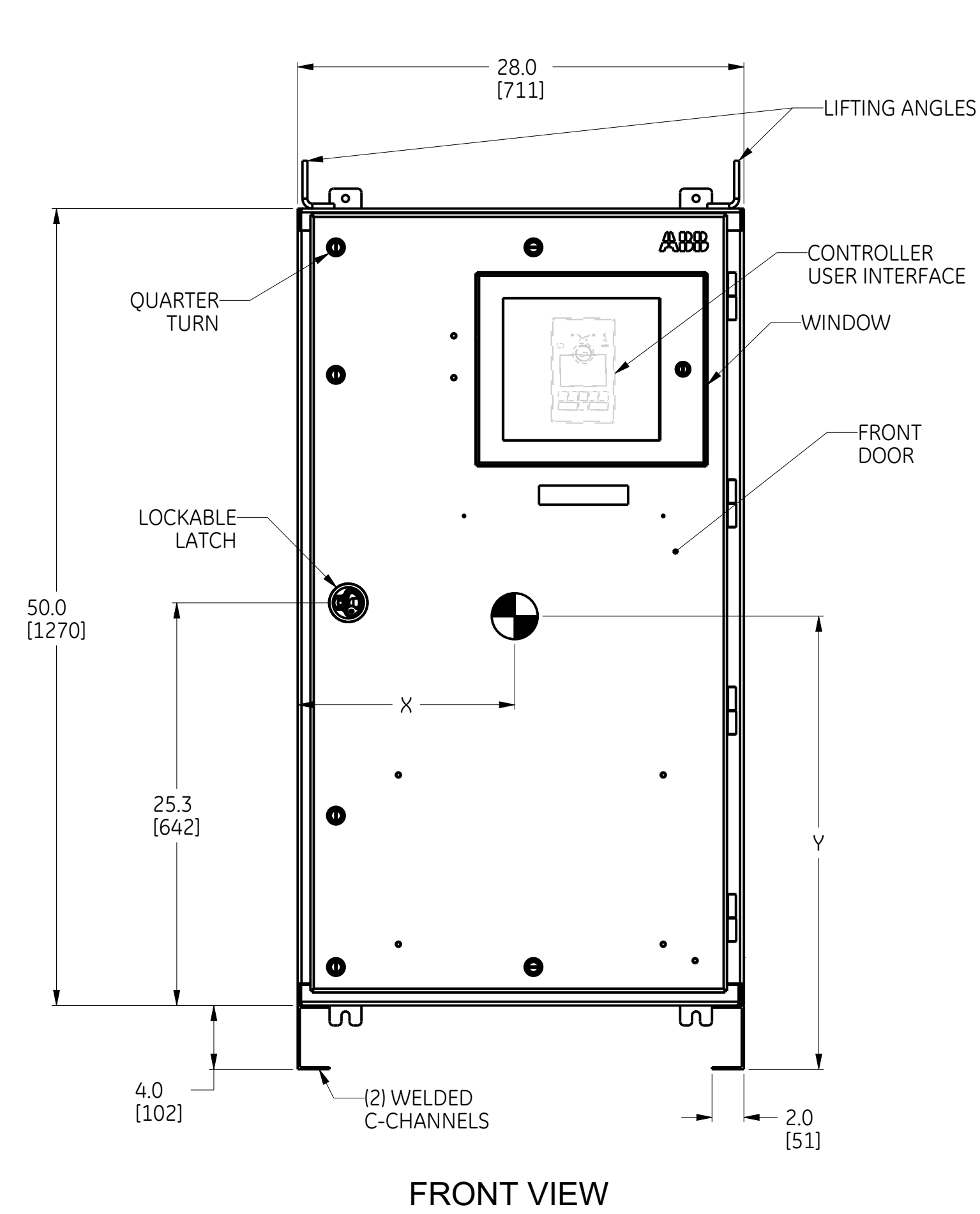

AMP	POLE	CONTROLLER TYPE	CABINET #	LUG RANGE	WEIGHT			CENTER OF GRAVITY IN(MM)		
					LB(KG)	X	Y	Z		
600A	2	SEE TABLE A	F-2015MPX	QTY 2 2 AWG-600 KCML	319(144)	13.7 (348)	28.1 (714)	9.7 (246)		
	3				324(147)					
	4				330(150)					

TYPE	TRANSITION	LEVEL	PART NO.
ZTX	OPEN	2	OXAMI1-L2
ZTG	OPEN	3	OXAMI1-L3
ZTGD	DELAYED	3	OXBMI1-L3

- NOTES
- ENCLOSURE : NEMA 4X TYPE, FREE STANDING, FLOOR MOUNT.
 - MATERIAL : 12 GA (.105) 304 SS REF.
 - FINISH : ANSI 61 GREY
 - CONSTRUCTION PER UL 1008 STANDARD.
 - FRONT ACCESSIBLE UNIT. NO SIDE OR REAR ACCESS REQUIRED.
 - SUITABLE WIRE BENDING SPACE PROVIDED PER THE SAFETY AGENCY STANDARDS.
 - UL AND CSA RECOGNIZED/CERTIFIED MECHANICAL LUGS ARE STANDARD.
 - EQUIPMENT GROUND LUG IS PROVIDED IN ALL UNITS. REFER SHEET 2 FOR DETAILS.
 - ALL DIMENSIONS ARE FOR REFERENCE ONLY AND SHOWN IN INCHES(MILLIMETERS).
 - 100% RATED SOLID/SWITCHED NEUTRAL PROVIDED PER THE SWITCH CONFIGURATION.
 - SUITABLE FOR TOP AND/OR BOTTOM CABLE ENTRY.

SEISMIC NOTES:

- BOLT ENCLOSURE FROM C-CHANNEL BASE USING THE FOLLOWING SEISMIC CERTIFIED MOUNTING HARDWARE PER MOUNTING HOLE: (HARDWARE PROVIDED BY INSTALLER).
 *1/2-13 GRADE 5 BOLT TORQUE TO 70 FT-LBS. (95 NEWTON METERS).
 *1/2-13 STANDARD FLAT WASHER.
 *1/2 (13) HELICAL SPRING LOCK WASHER.
- CENTER OF GRAVITY DIMENSIONS ARE FOR REFERENCE ONLY.
- FOR WORKING CLEARANCE REFER TO NATIONAL AND LOCAL CODES AND STANDARDS.

DRAWING FILE		MODEL FILE		ABB							
50C-1068		50C-1068									
DATE MODIFIED		DESIGNED BY		TruONE LAYOUT, 600A WITH NEMA 4X CABINET							
20-May-19 01:34:41 PM		DV									
VOLUME		APPROVED BY		UNITS LOCAL TITLE							
0.000 in^3		SR									
MASS		FINISH SPECIFICATION		SCALE PRODUCT LINE SHEET							
0.000 lbm		---									
TOLERANCE ON:		FINISH DESCRIPTION		SIZE		ROOT NUMBER		REV		RELEASE STATE	
1 PL DECIMALS ± 0.1		---		D		50C-1068		1		In Work	
2 PL DECIMALS ± 0.02		---		13:100		ZTX/ZTG(D)		1		1 of 2	
3 PL DECIMALS ± 0.005		---		---		---		---		---	
ANGLE ± 1.0		---		---		---		---		---	

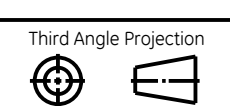

28 27 26 25 24 23 22 21

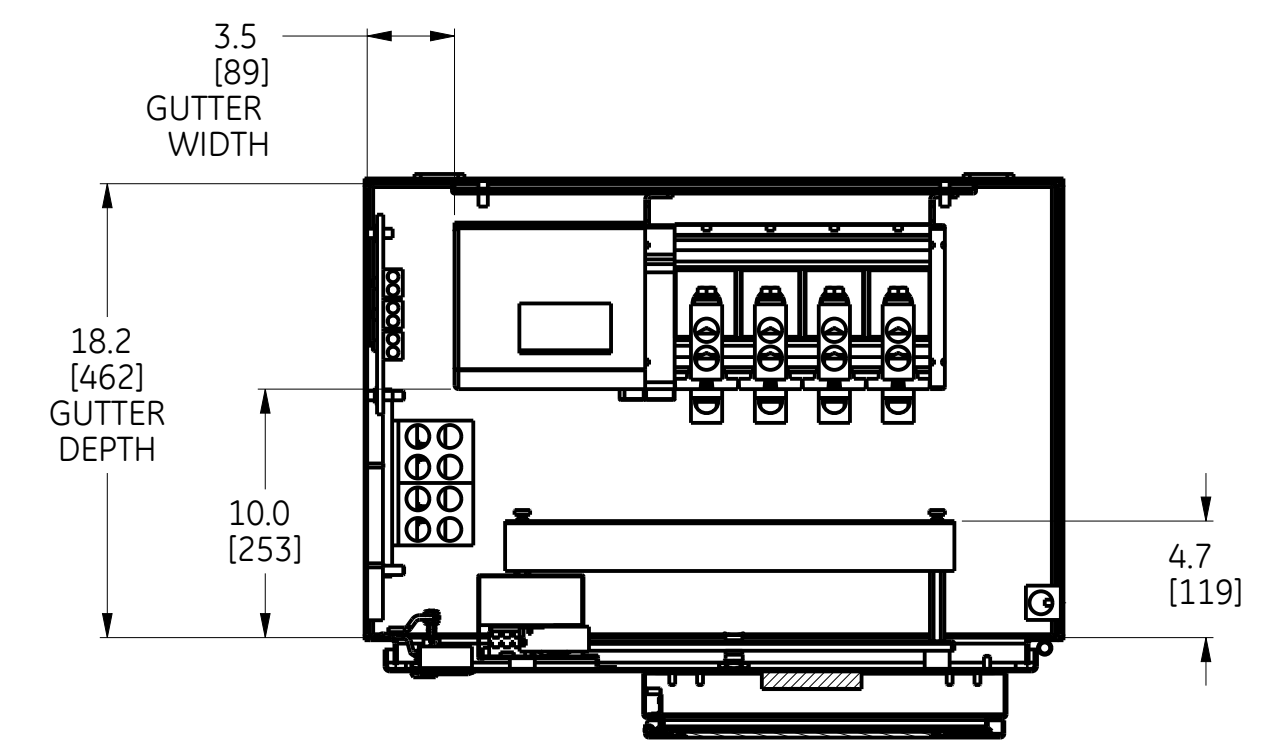

SECTION B-B
TOP VIEW
WITHOUT TOP PANEL

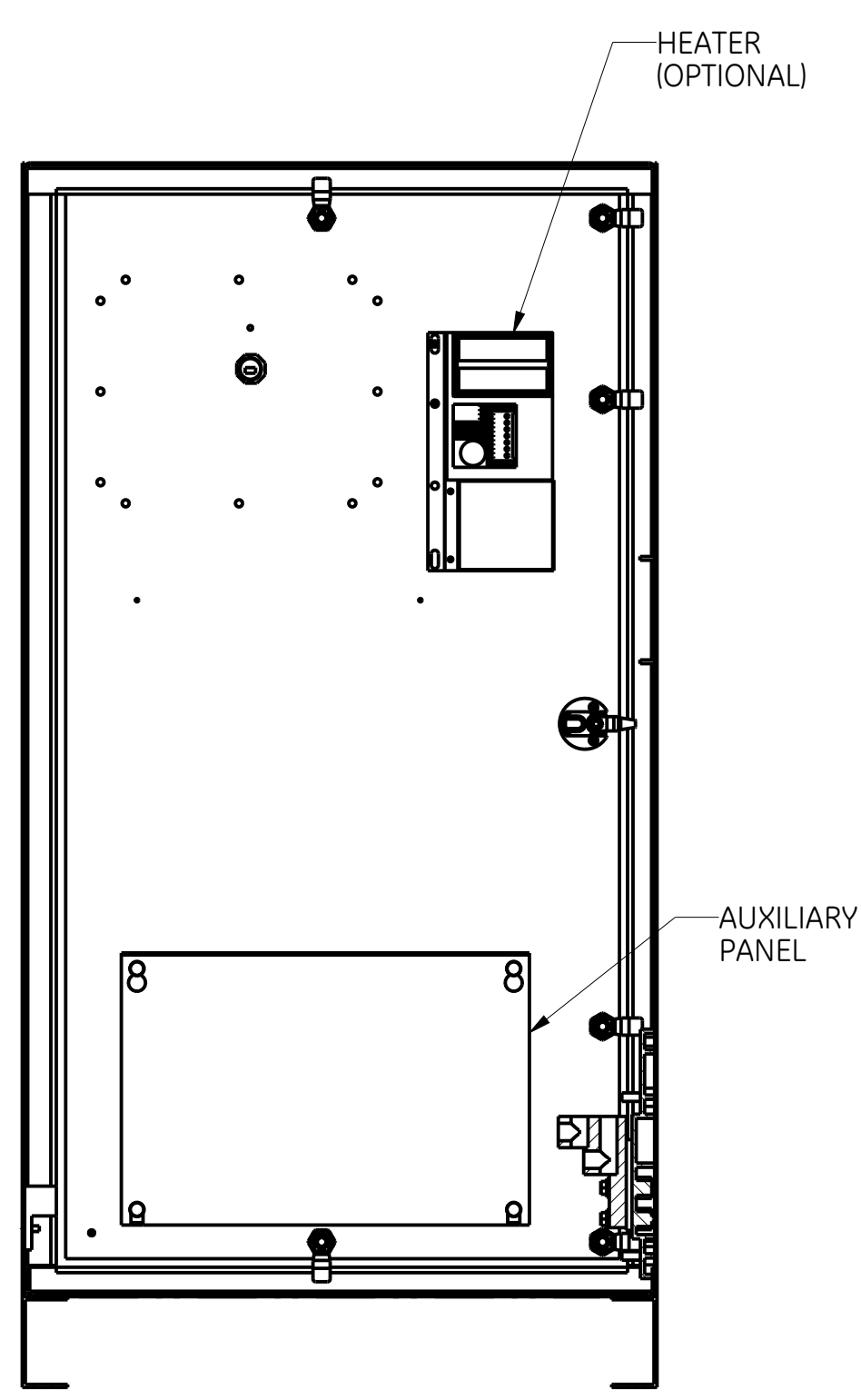

SECTION D-D
DOOR INSIDE VIEW

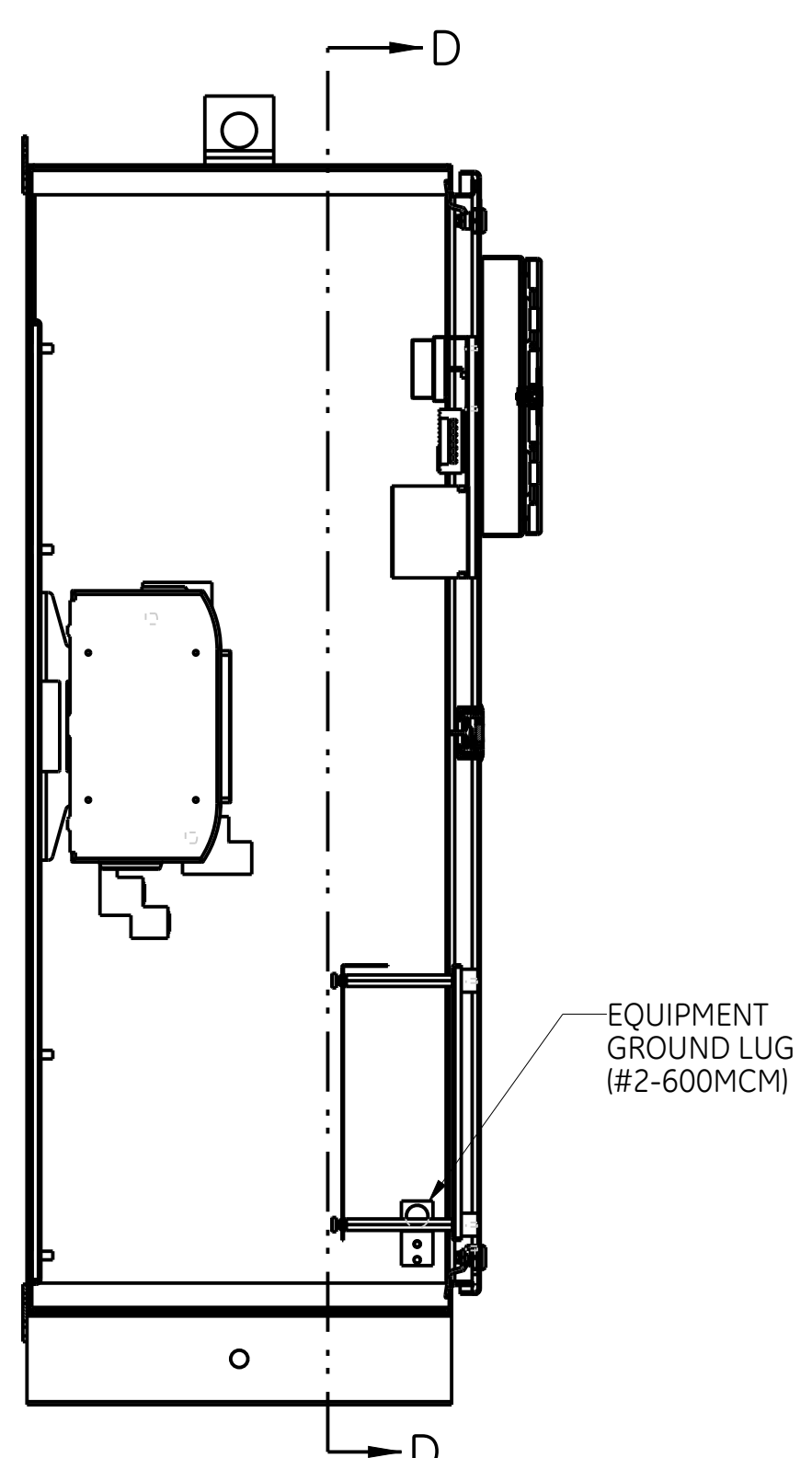

SECTION A-A
LEFT VIEW
WITHOUT SIDE PANEL

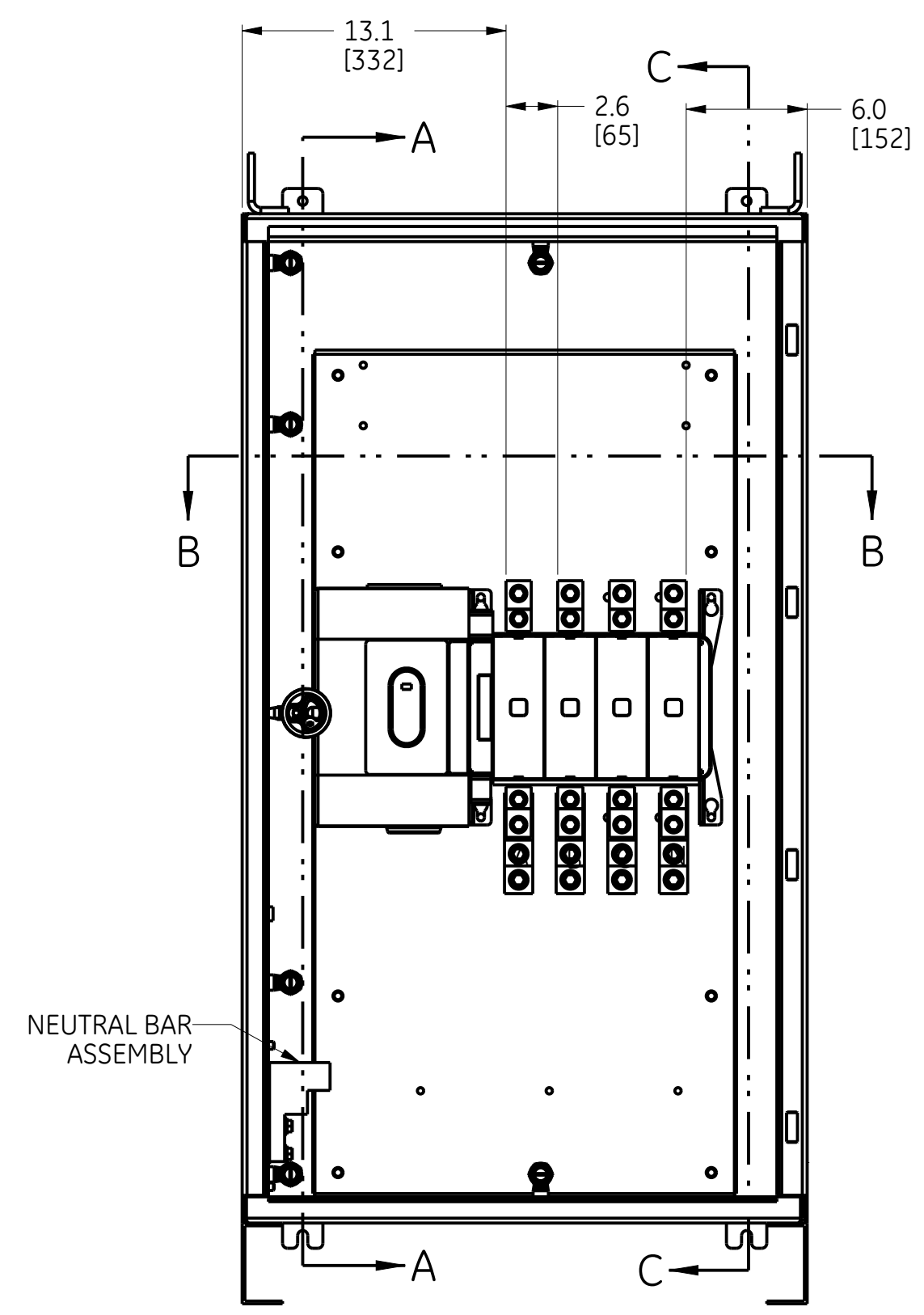

FRONT VIEW
WITHOUT DOOR

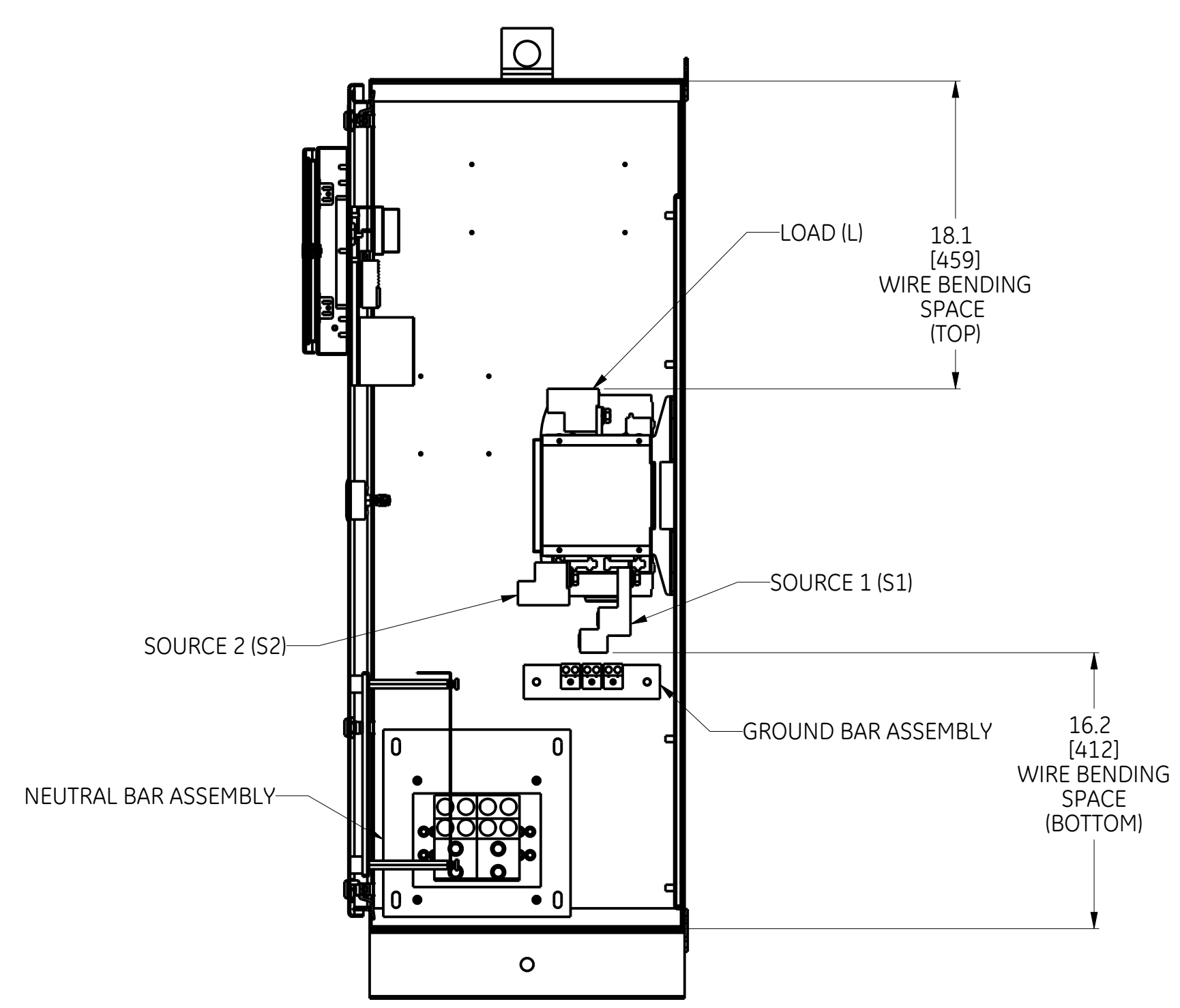

SECTION C-C
RIGHT VIEW
WITHOUT SIDE PANEL

NOTE:
1. REFER TO SHEET (1) FOR COMPLETE NOTE DETAILS
2. MECHANICAL LUGS SHOWN IN ABOVE VIEWS ARE FOR REFERENCE ONLY.

ABB PROPRIETARY AND CONFIDENTIAL INFORMATION
The information contained in this document has to be kept strictly confidential.
Any unauthorized use, reproduction, distribution or disclosure to third parties is strictly forbidden.
ABB reserves the right to change specifications without notice. All rights reserved.

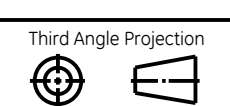

ABB		
SIZE	NUMBER	REV
D	50C-1068	1
SCALE	PRODUCT LINE	SHEET
13:100	ZTX/ZTG(D)	2 of 2

28 27 26 25 24 23 22 21