

TOP VIEW

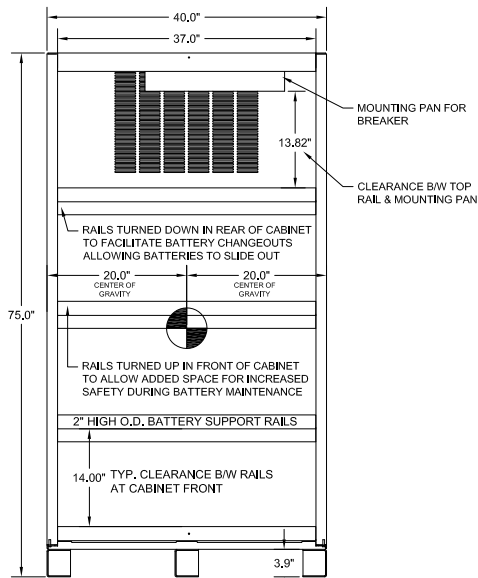

FRONT VIEW (DOORS REMOVED)

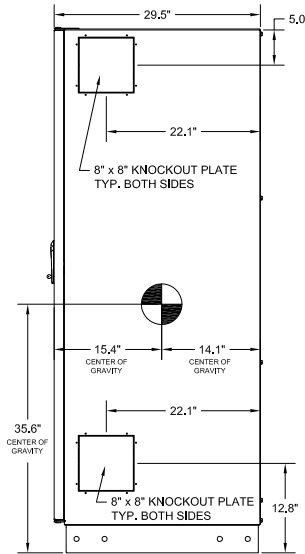

RIGHT SIDE VIEW

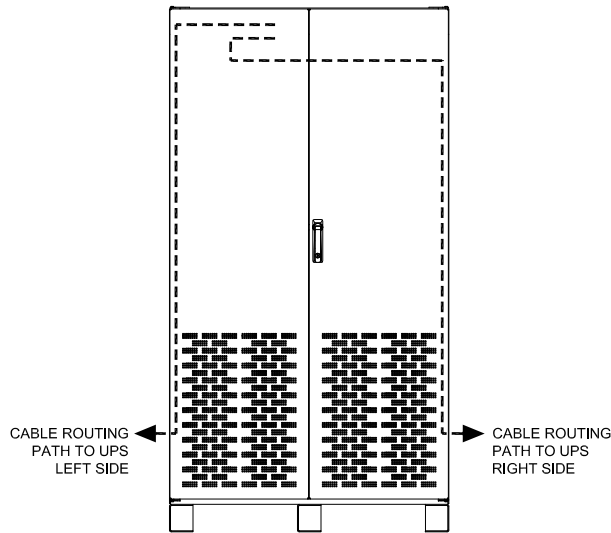
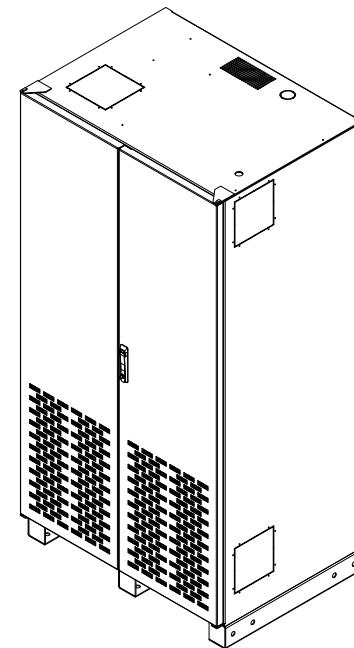

FRONT VIEW

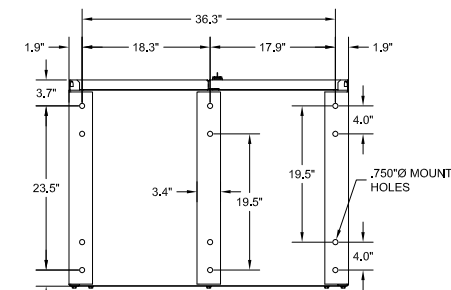

BOTTOM VIEW

NOTES:

- EMPTY CABINET WEIGHT: 520 LBS
- NEMA 1 ENCLOSED BATTERY CABINET.
- FACTORY ASSEMBLED CABINETS ARE LISTED TO UL 1778.
- HEAVY GAUGE WELDED STEEL CONSTRUCTION.
- FINISH IS BLACK DURABLE CHIP & CORROSION RESISTANT POWDER COAT.
- A MINIMUM REAR CLEARANCE OF 2" IS RECOMMENDED FOR OPTIMAL COOLING OF THE EQUIPMENT.
- FOR EASE OF CONDUIT INSTALLATION, (1) 8" X 8" CONDUIT PLATE IS PROVIDED TO REPLACE A KNOCKOUT IN THE CABINET.
- BATTERIES CAN BE ACCESSED FROM THE FRONT AND REAR.
- CABINET CAN BE MOVED WITH PALLET JACK OR FORK LIFT AT PALLET JACK ACCESS POINTS LOCATED AT FRONT OR REAR OF CABINET. FROM THE SIDES, THE CABINET CAN BE MOVED WITH ROL-A-LIFT TYPE EQUIPMENT MOVER. THE CABINET IS ONLY TO BE LIFTED FROM THE BOTTOM.
- CENTER OF GRAVITY IS FIGURED WITH 540 WATT BATTERIES IN A 480V CONFIGURATION.
- THE BC50S BATTERY CABINET (OPTIONAL CONFIGURATION) HAS BEEN CERTIFIED TO MEET THE 2015 EDITION OF THE INTERNATIONAL BUILDING CODE (IBC) AND THE 2016 EDITION OF THE CALIFORNIA BUILDING CODE (CBC) TO MEET DESIGN CATEGORY F, SS = 2.0 AND IMPORTANCE FACTOR 1.5.

BC50 BATTERY CABINET  
FOR USE WITH GE TLE SERIES 40-225 KVA UPS

MECHANICAL DRAWING

THE INFORMATION CONTAINED IN THIS DRAWING IS THE SOLE PROPERTY OF C&C POWER, INC. ANY REPRODUCTION WITHOUT THE WRITTEN CONSENT OF C&C POWER, INC IS PROHIBITED.

DIMENSIONS ARE IN INCHES		INITIALS	DATE
TOLERANCES:			
DECIMALS:	ANGLES:	DRAWN	JRL 08/11/2017
.XX ±.13	±1°	CHECKED	CH 08/11/2017
.XXX ±.082			



Manufactured by C&C Power for GE

SCALE: SIZE: A REV: 1 SHEET 1 OF 2

DRAWING # 91450-SDF01-TLEM2 REV 1

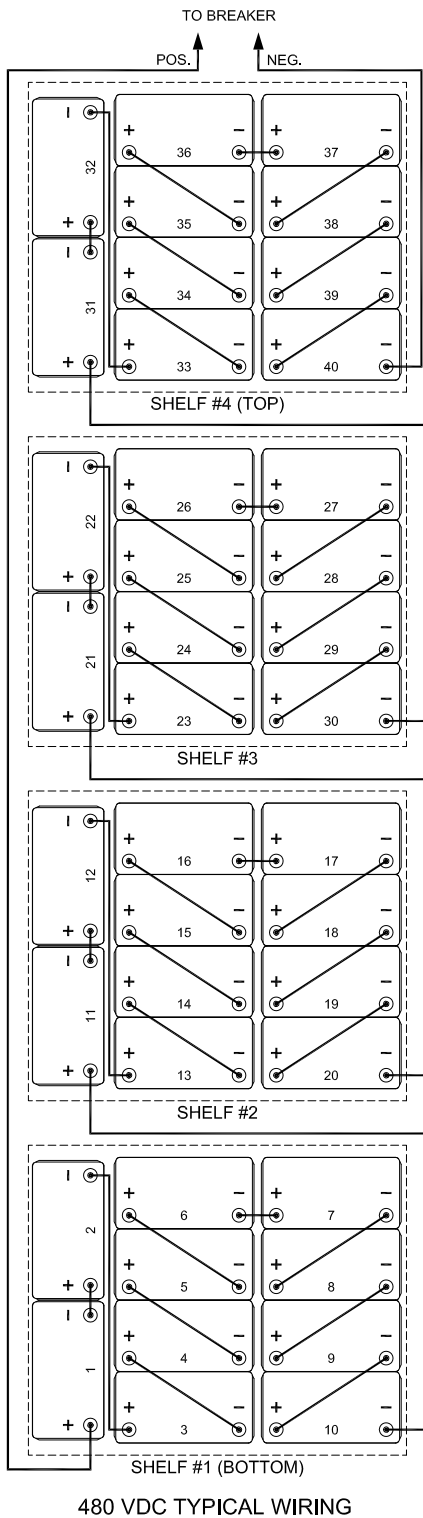

**BREAKER WIRING**

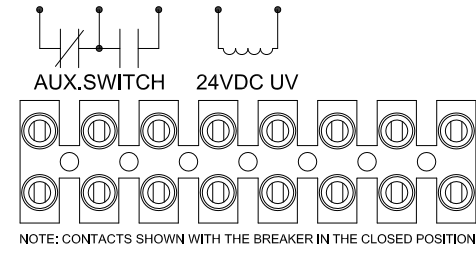
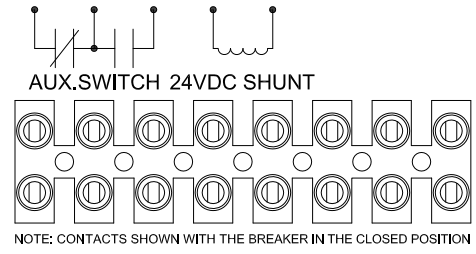
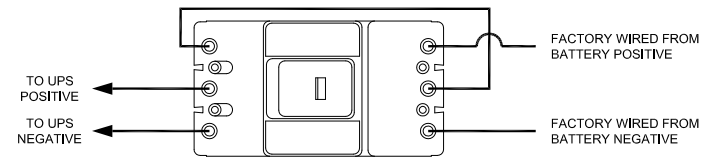

**40KVA - 150KVA TLE SERIES  
BREAKER ACCESSORIES**

**200KVA - 225KVA TLE SERIES  
BREAKER ACCESSORIES**

**CABLE KIT SIZING**

MAIN BREAKER MAX AMPS	MAINS TO UPS
125	1 AWG THHW
150	1/0 AWG THHW
225	4/0 AWG THHW
300	(2) 1/0 AWG THHW
350	(2) 2/0 AWG THHW
400	(2) 4/0 AWG THHW
600	(2) 350 MCM THHW

**NOTES:**

1. ALL INTERNAL WIRING IS UL LISTED, MTW, STYLE, 105C, EXTRA FLEXIBLE CABLE.
2. BREAKER IS UL LISTED.
3. BATTERY CABINETS WITH BREAKERS ARE SHIPPED WITH BREAKER IN THE OFF/OPEN POSITION.
4. BREAKER ACCESSORY TERMINAL BLOCK IS SHOWN WITH OPTIONAL ACCESSORIES.
5. MAIN CABLES FROM BATTERY CABINET TO UPS ARE INCLUDED AND ARE SIZED FOR A "SIDE BY SIDE" LINEUP WITH THE UPS.
6. CABINETS ARE SHIPPED WITH A BATTERY JUMPER REMOVED TO BREAK STRING VOLTAGE FOR ADDED SAFETY IN SHIPPING.
7. GROUND CONNECTION IS #14-2/0 AWG MECHANICAL LUG.

<b>BC50 BATTERY CABINET</b>		<b>INITIALS</b>		<b>DATE</b>	
FOR USE WITH GE TLE SERIES 40-225 KVA UPS		DRAWN JRL		08/09/2017	
<b>ELECTRICAL DRAWING</b>					
THE INFORMATION CONTAINED IN THIS DRAWING IS THE SOLE PROPERTY OF C&C POWER, INC. ANY REPRODUCTION WITHOUT THE WRITTEN CONSENT OF C&C POWER, INC IS PROHIBITED.					
DIMENSIONS ARE IN INCHES		CHECKED CH		08/09/2017	
TOLERANCES: DECIMALS: .XX ±.13 ANGLES: .XXX ±.082		SCALE: NTS		REV: 1	
		SHEET 2 OF 2		 Manufactured by C&C Power for GE	
© 2017 C&C POWER, INC. ALL RIGHTS RESERVED					