



DEH-41390 Installation Instructions

Arcing contacts assembly

Arcing contacts are supplied with the Entelliguard breaker.



Fig A



Fig B

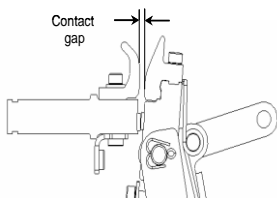
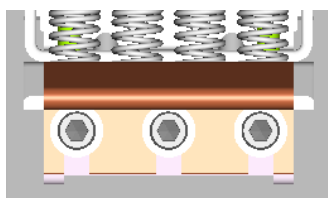

Table 1. Arc contact Catalog and Ratings

Envelope Size	Catalog #	TYPE
Envelope 1	G20HARC	H type
	G20NARC	S & N type
Envelope 2	G40MARC	H & M types
	G40NARC	E & N types
Envelope 2.5	G20NARC	S & N type
Envelope 3	G64LARC	

Arcing contact assembly using cluster pliers:

1. Turn the breaker off and discharge the closing springs by depressing the OFF and ON buttons in the sequence OFF-ON-OFF. Verify that the breaker OFF-ON indicator shows OFF on a green background and that the charge indicator shows DISCHARGE on a white background. If installing in a draw-out type breaker remove breaker from adaptor (cassette) before continuing.

EntelliGuard® G Circuit Breaker Accessories

Arcing contacts assembly



WARNING: Before installing any accessories, turn the breaker OFF, disconnect it from all voltage sources, and discharge the closing springs.



AVERTISSEMENT: Avant d'installer tout accessoire, mettre le disjoncteur en position OFF, le déconnecter de toute tension d'alimentation, et décharger les ressorts d'armement

2. The breaker should be safely isolated and fully removed from the cassette (for drawout breaker)
3. Loosen the mounting screws of arc chamber to the housings as shown in fig A
4. Lift the Arc chamber assembly as shown in fig B.
5. Loosen the fixed arcing contact assembly mounting screws as shown in fig C.
6. Inspect the arc plates & arcing contacts and sides of the moldings for signs of wear or damage. Replace as necessary.
7. Close the circuit breaker & ensure the contact gap between the fixed and moving arcing contacts is set to 2.5mm as shown in fig D
8. Tighten the three mounting screws of fixed arcing contact to torque of 18-20Nm (13.3 - 14.8 ft-lbs)
9. Install the arc chamber assembly by tightening the mounting screws to torque of 8 -10 Nm (5.9 - 7.4 ft-lbs)

These instructions do not purport to cover all details or variations in equipment nor, to provide contingency to be met in connection with installation, operation, or maintenance. Should further information be desired, or should particular problems arise which are not covered sufficiently for the purchaser's purposes, the matter should be referred to GE.

GE
41 Woodford Ave, Plainville, CT 06062
www.geelectrical.com

© 2009 General Electric Company



DEH-41390 R2 (12/15)