



DEH-0006885 Installation Guide

EntellEon^{*} Neutral Bonding Kit

WARNING

Danger of electrical shock or injury. Turn OFF power ahead of the panelboard or switchboard before working inside the equipment or removing any component. Equipment is to be installed and maintained by properly trained and qualified personnel only.

Neutral Bonding Strap Installation

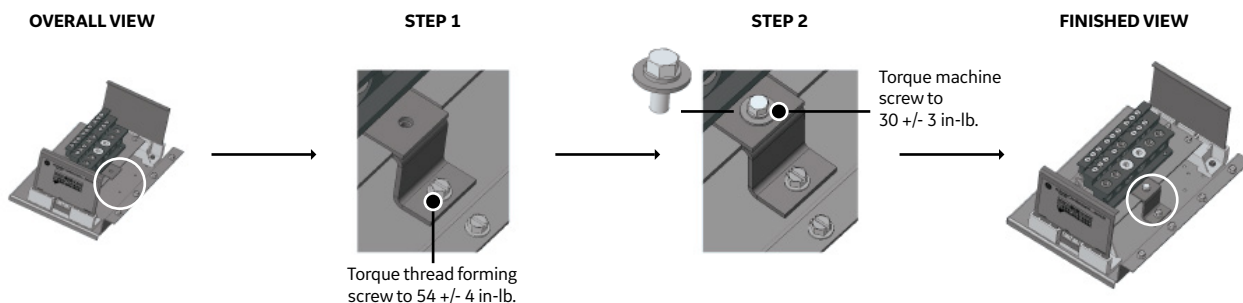

Ground Fault Neutral Bonding Strap Installation

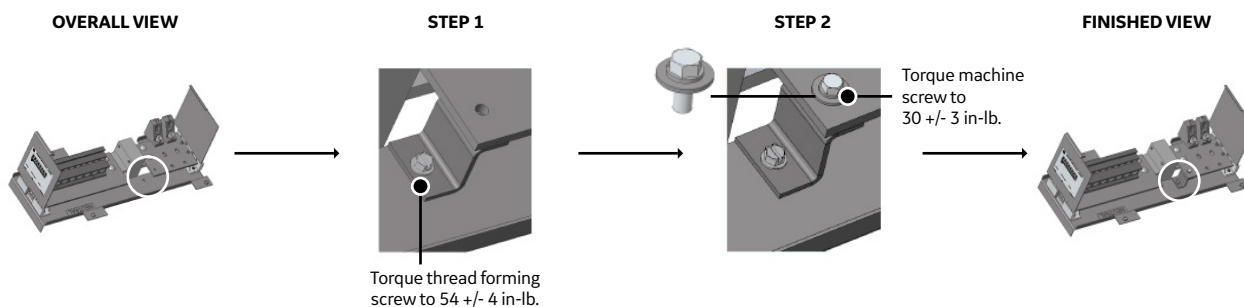

Service Entrance Main Disconnect Kits

As required, when upgrading to a service entrance panel with a single disconnect, order barrier kit corresponding to main type.

MAIN TYPE	KIT NUMBER	REPLACEMENT PLUG KIT
Spectra F	SFLSB	-
Spectra G	SGLSB	SGSK125SBP
Spectra K with 3 Cavity Lug	SKLSB124	SK124SBP
Spectra K with 4 Cavity Lug	SKLSB125	SGSK125SBP

*Registered trademark of the General Electric Company.

The GE brand, logo, and lamination are trademarks of the General Electric Company.

© 2018 General Electric Company. Information provided is subject to change without notice.

All values are design or typical values when measured under laboratory conditions.

DEH-0006885, Rev. 05/2018