



SecoBloc OEM Modules

For SecoVac Vacuum Circuit Breakers

Fact Sheet

Overview

SecoBloc OEM Modules have been developed for use in OEM designed and manufactured switchgear alongside with the SecoVac Vacuum Circuit Breakers rated at 5kV – 15kV, 1200A – 3000A, 60Hz.

Fully IEEE tested, SecoBloc OEM Modules provide OEMs with a simple, cost effective solution that is easy to order and assemble.



Standard Features – SecoVac Vacuum Circuit Breaker

- Environmentally friendly solid epoxy resin insulation
- Complete interlocking system to prevent incorrect operation
- Universal Open and Close modules to all frames allowing for reduced maintenance time and low replacement cost
- Primary disconnect finger cluster is built of silver-plated copper and tested for continuous and short time current ratings



Standard Features – SecoBloc Box Frame

- Air insulated OEM blocs in a compact envelope
- Equipped with automatic grounded metal shutters for Bus and Load connections
- Suitable for indoor use (NEMA 1/12) and outdoor use (NEMA 3R/4/4X) with a proper OEM enclosure
- All metal surfaces in the panels are painted or plated for corrosion protection



Standard Features – SecoBloc L-Frame

- Grounded Automatic shutters
- MOC and TOC options include 4A/4B or 8A/8B contacts
- Includes circuit breaker grounding, rejection feature, and position indicator

Standard Features – SecoBloc Cell Kit

- Includes guide rails and shutters with actuating lever
- Pre-wired secondary disconnect socket with 3m wire harness
- Circuit breaker ground connection
- Spout bushings, mounting sheet, and fixed contacts
- MOC and TOC switches and mounting details



Technical Data

Specifications		1200/31.5	1200/40	2000/40	3000/40
Rated Current (A)		1200	1200	2000	3000
Rated Voltage (kV)		4.76 / 8.25 / 15	4.76 / 8.25 / 15	4.76 / 8.25 / 15	4.76 / 8.25 / 15
Rated Power Frequency (1 min)	Phase to Phase and to Earth (kV)	36	36	36	36
	Between Isolating Distance (kV)	36	36	36	36
Rated Lighting Impulse (1.2/50µs)	Phase to Phase and to Earth (kV)	95	95	95	95
	Between Isolating Distance (kV)	95	95	95	95
Rated Frequency (Hz)		60	60	60	60
Rated Short Time Withstand (kA)		31.5	40	40	40
Rated Peak Value Withstand Current (kAp)		82	104	104	104
Rated duration Time for Short-circuit (s)		2	2	2	2
IP Level for Door		NEMA 250 Type 1 / Type 1+2 (IEC IP4X)			

Dimensions (SecoBloc)

Rating (amp/KA)	1200/31.5	1200/40	2000/40	3000/40
A(in / mm)	36 / 914	36 / 914	36 / 914	36 / 914
B(in / mm)	43.3 / 1100	43.3 / 1100	43.3 / 1100	43.3 / 1100
C(in / mm)	47.44 / 1205	47.44 / 1205	47.44 / 1205	47.44 / 1205
D(in / mm)	10.16 / 258	10.67 / 271	10.67 / 271	10.67 / 271
E(in / mm)	37.28 / 947	36.77 / 934	36.77 / 934	36.77 / 934
F(in / mm)	10.83 / 275	12.2 / 310	12.2 / 310	12.2 / 310
G(in / mm)	18.43 / 468	19.0 / 483	19.0 / 483	19.0 / 483
H(in / mm)	10.0 / 254	10.0 / 254	10.0 / 254	10.83 / 275
I(in / mm)	10.0 / 254	10.0 / 254	10.0 / 254	10.83 / 275
J(in / mm)	8.0 / 203	8.0 / 203	8.0 / 203	7.17 / 182

OUTLINE DRAWING

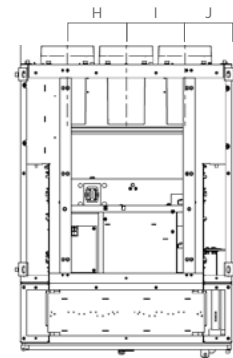
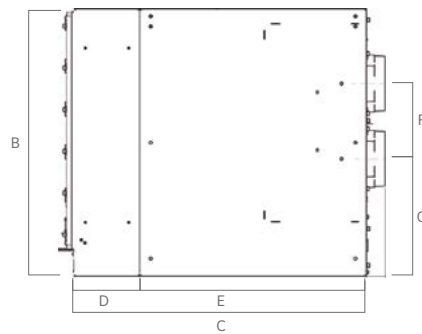
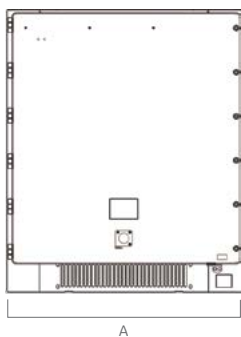

Dimensions (L-Frame)

Rating (amp/KA)	1200/31.5	1200/40	2000/40	3000/40
A(in / mm)	43.07 / 1094	43.07 / 1094	43.07 / 1094	43.07 / 1094
B(in / mm)	35.75 / 908	35.75 / 908	35.75 / 908	35.75 / 908
C(in / mm)	10.38 / 275	12.2 / 310	12.2 / 310	12.2 / 310
D(in / mm)	18.43 / 468	19.12 / 483	19.12 / 483	19.12 / 483
E(in / mm)	47.44 / 1205	47.44 / 1205	47.44 / 1205	47.44 / 1205
F(in / mm)	7.87 / 200	7.87 / 200	7.87 / 200	7.05 / 179
G(in / mm)	10.0 / 254	10.0 / 254	10.0 / 254	10.83 / 275
H(in / mm)	10.0 / 254	10.0 / 254	10.0 / 254	10.83 / 275

OUTLINE DRAWING

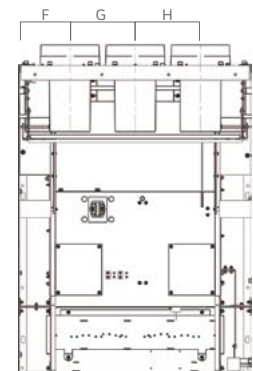
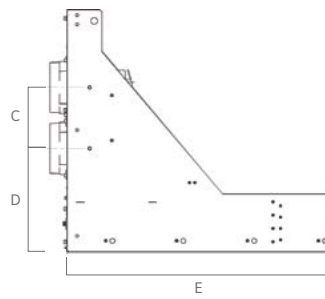
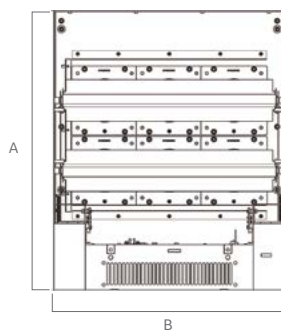



GE
41 Woodford Avenue
Plainville, CT 06062
www.geindustrial.com

*Registered trademark of the General Electric Company.
The GE brand, logo, and lumination are trademarks of the General Electric Company. © 2017 General Electric Company.
Information provided is subject to change without notice. All values are design or typical values when measured under laboratory conditions.
DEQ211, Rev. 05/2017