

RENEWAL PARTS

IC8000-EA AND IC8070-EA PLATE-TYPE RHEOSTATS

(6-inch Plate)

(Also CR8000-EA and CR8070-EA)

IC8000-EA and IC8070-EA-101AA, -102AA, -103AA, -104AA, -201AA, -202AA, -203AA, and -204AA

NOTE:—When ordering parts for a form of the contactor not covered by this bulletin, give reference number, description of part, complete nameplate reading, and above bulletin (GEF) number. Do not use catalog number when form for which the parts are needed is not covered by the bulletin.

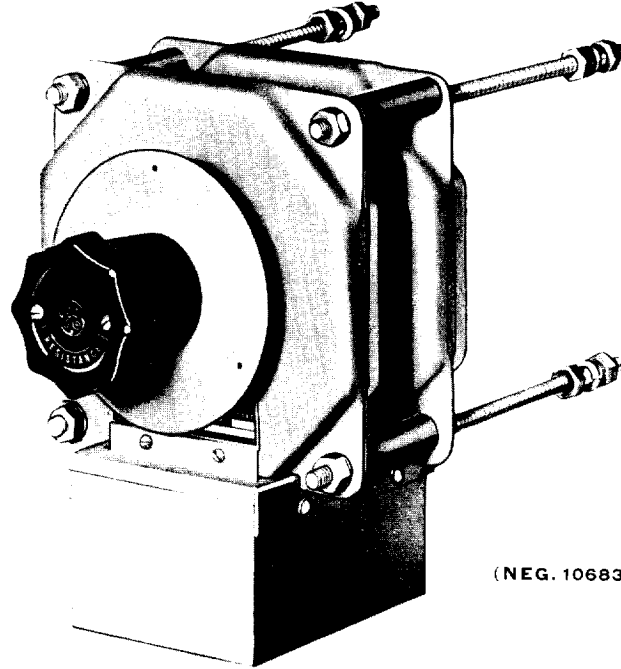

(NEG. 1068339)

IC8070-EA-201AA plate-type rheostat

Ref.No. 1 - RESISTANCE PLATES

When ordering Resistance Plates, the group number suffix must be added to the resistance plate root Cat.No. The last number in the Cat.No. designation identifies the resistance plate group number.

Example: - CR8000-EA-101-AA-12 requires resistance plate 3246900G12.

The resistance plate root Cat.No. should be determined from the following table.

Rheostat Root Cat.No.	Resistance Plate		Rheostat Root Cat.No.	Resistance Plate	
	Root Cat.No.	No.Re- quired		Root Cat.No.	No.Re- quired
CR8000-EA101AA	3246900	1	CR8070-EA101AA	3246900	1
CR8000-EA102AA	3246901	1	CR8070-EA102AA	3246901	1
CR8000-EA103AA	3246902	1	CR8070-EA103AA	3246902	1
CR8000-EA104AA	3246903	1	CR8070-EA104AA	3246903	1
CR8000-EA201AA	3246900	2	CR8070-EA201AA	3246900	2
CR8000-EA202AA	3246901	2	CR8070-EA202AA	3246901	2
CR8000-EA203AA	3246902	2	CR8070-EA203AA	3246902	2
CR8000-EA204AA	3246903	2	CR8070-EA204AA	3246903	2

When ordering renewal parts, give quantity, catalog number, description of each item required, and complete nameplate reading.



IC8000-EA AND IC8070-EA PLATE-TYPE RHEOSTATS

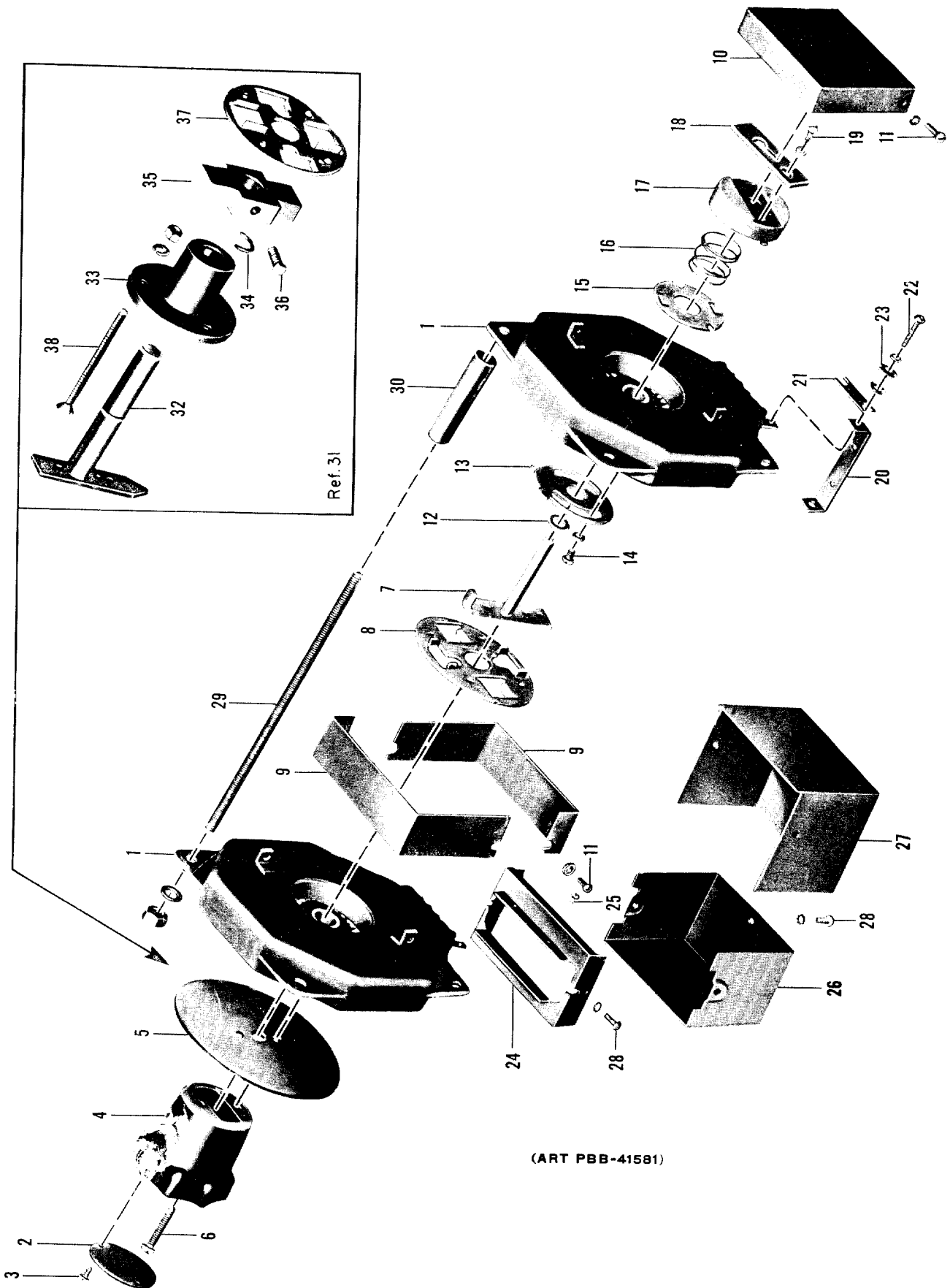

(ART PBB-41581)

IC8000-EA AND IC8070-EA PLATE-TYPE RHEOSTATS

GEF-3646

Ref. No.	No. Required for CR8000-EA-								No. Required for CR8070-EA-								Cat.No.	Description
	101AA	102AA	103AA	104AA	201AA	202AA	203AA	204AA	101AA	102AA	103AA	104AA	201AA	202AA	203AA	204AA		
2	1		1		1		1		1		1		1		1		-----	Directional nameplate (cuts in resistance clockwise) (Order by NP130570A)
2		1		1		1		1		1		1		1		1	-----	Directional nameplate (cuts in resistance counterclockwise) (Order by NP130570D)
3	2	2	2	2	2	2	2	2	2	2	2	2	2	2	2	2	101X198	Screw fastening directional nameplate to handwheel
4	1	1	1	1	1	1	1	1	1	1	1	1	1	1	1	1	9155374P2	Handwheel
5	1	1	1	1	1	1	1	1	1	1	1	1	1	1	1	1	9385798P2	Shield
6	2	2	2	2	2	2	2	2	2	2	2	2	2	2	2	2	N37P16018B	Screw fastening handwheel and shield to stop (10-32)
7	1	1	1	1	2	2	2	2	1	1	1	1	2	2	2	2	9384616G1	Shaft with stop
8					1	1	1	1					1	1	1	1	9196877	Coupling
9													2	2	2	2	9397216P1	Cover for coupling
10									1	1	1	1	1	1	1	1	9397215P1	End cover for brush assembly
11									2	2	2	2	4	4	4	4	N37P15006B	Screw fastening covers in position (8-32)
12	1	1	1	1	2	2	2	2	1	1	1	1	2	2	2	2	9644203Δ	Spacing washer for shaft
13	2	2	2	2	4	4	4	4	2	2	2	2	4	4	4	4	9092414	Stop plate
14	2	2	2	2	4	4	4	4	2	2	2	2	4	4	4	4	N37P16005B	Screw fastening stop plate to resistance plate (10-32)
15	1	1	1	1	2	2	2	2	1	1	1	1	2	2	2	2	278A888G1	Brush assembly
16	1	1	1	1	2	2	2	2	1	1	1	1	2	2	2	2	2418870	Compression spring for brush
17	1	1	1	1	2	2	2	2	1	1	1	1	2	2	2	2	9384614P1	Brush support
18	1	1	1	1	2	2	2	2	1	1	1	1	2	2	2	2	9092407	Locking strip for brush support
19	1	1	1	1	2	2	2	2	1	1	1	1	2	2	2	2	N37P15005B	Screw fastening locking strip to brush support (8-32)
20					Δ	Δ	Δ	Δ					Δ	Δ	Δ	Δ	9397197P2	"U" Shaped connector
21	Δ	Δ	Δ	Δ	Δ	Δ	Δ	Δ	Δ	Δ	Δ	Δ	Δ	Δ	Δ	Δ	9092695	Straight connector
22	3	3	3	3	6	6	6	6	3	3	3	3	6	6	6	6	N37P16012B	Screw fastening connectors to terminals (10-32)
23	6	6	6	6	12	12	12	12	6	6	6	6	12	12	12	12	N402P39	Washer for screw fastening leads to terminals
24									1	1	1	1	2	2	2	2	9357508P1	Conduit box support
25									4	4	4	4	4	4	4	4	101X204	Screw fastening conduit box support to resistance plate (6-32)
26									1	1	1	1	1	1	1	1	9357508P2	Conduit box
27									1	1	1	1					9357508P3	Conduit box cover
27													1	1	1	1	9397225P1	Conduit box cover
28									3	3	3	3	5	5	5	5	N37P15006B	Screw fastening cover or conduit box support in position (8-32)
29	4	4	4	4					4	4	4	4					9385526P1	Mounting stud
29					4	4	4	4					4	4	4	4	9385526P2	Mounting stud
30					4	4	4	4					4	4	4	4	2026023	Spacer between resistance plates

OPERATING MECHANISM FOR BACK-OF-BOARD MOUNTING

31	1	1	1	1	1	1	1	1	1	1	1	1	1	1	1	1	9350861G1	Operating mechanism, complete
32	1	1	1	1	1	1	1	1	1	1	1	1	1	1	1	1	9385529G1	Shaft and pointer assembly
33	1	1	1	1	1	1	1	1	1	1	1	1	1	1	1	1	9397235P1	Bearing hub
34	1	1	1	1	1	1	1	1	1	1	1	1	1	1	1	1	101X253	Retaining ring
35	1	1	1	1	1	1	1	1	1	1	1	1	1	1	1	1	9653798	Coupling arm
36	1	1	1	1	1	1	1	1	1	1	1	1	1	1	1	1	N72P2108B	Set screw holding coupling arm in position (1/4 in.-20)
37	1	1	1	1	1	1	1	1	1	1	1	1	1	1	1	1	9196877P1	Coupling
38	3	3	3	3	3	3	3	3	3	3	3	3	3	3	3	3	9644284	Mounting screw fastening operating mechanism to panel

Δ Not used on up to date rheostats

INTERLOCK MECHANISM
6-Inch Plate

Ref. No.	Cat.No.	No.Re-quired	Description
39	9653797G1	1	Interlock mechanism, complete, for CR8000-EA Rheostat
39	9653797G4	1	Interlock mechanism, complete, for CR8070-EA Rheostat
40	101X519	1	Groov pin fastening handwheel support to shaft assembly
41	9098063	1	Handwheel support
42	9196872P1	2	Stop plate
43	9098066	1	Spacer between stop plates
44	9397618G1	1	Shaft assembly
45	N22P21012B	2	Screw fastening stop plates and spacer to shaft assembly (1/4 in.-20)

Δ Quantity variable.

IC8000-EA AND IC8070-EA PLATE-TYPE RHEOSTATS

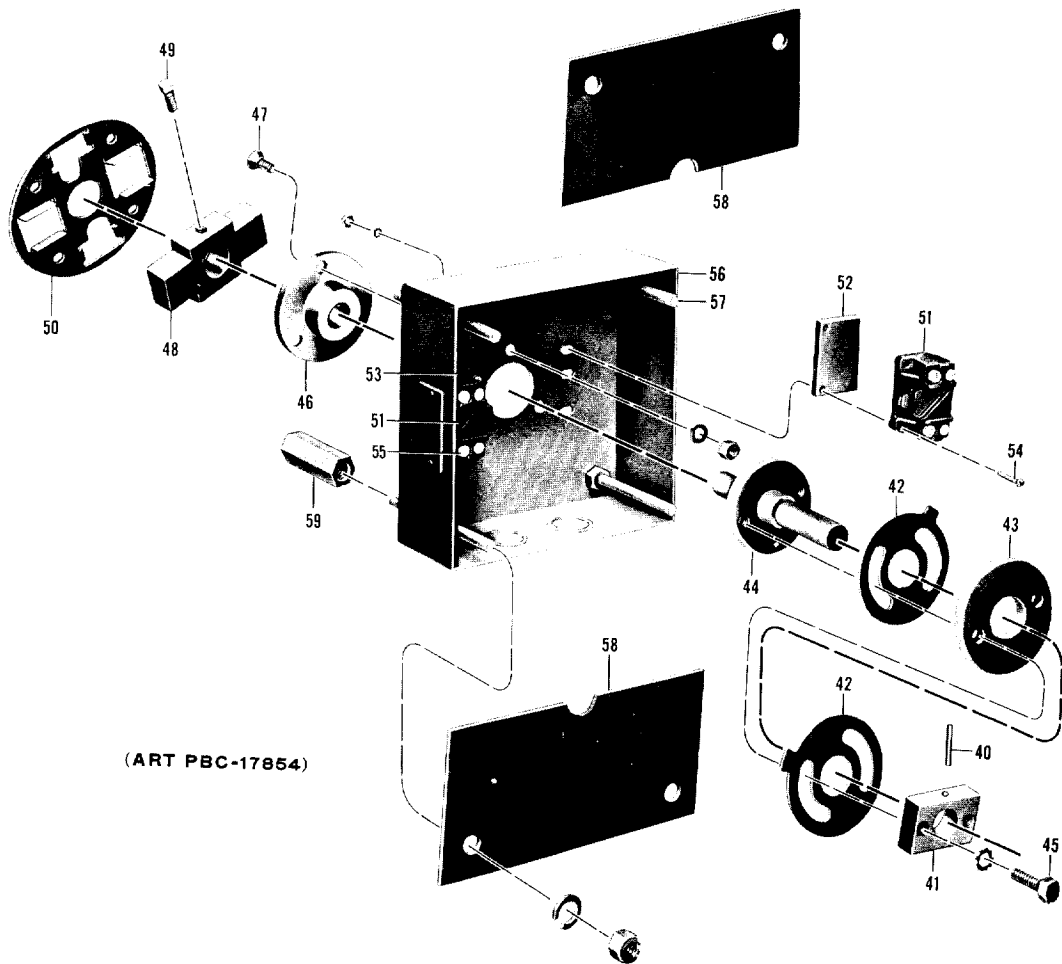

Ref. No. 39 Interlock mechanism

INTERLOCK MECHANISM (Cont'd)

Ref. No.	Cat.No.	No. Required	Description
46	9098061	1	Bearing hub
47	N44P21010B	3	Screw fastening bearing hub to box for interlock (1/4 in.-20)
48	9653798	1	Coupling arm
49	N72P2108B	1	Set screw holding coupling arm to shaft (1/4 in.-20)
50	9196877	1	Coupling
51	CR1070-A102F	2	Switchette
52	9098072P1	1	Spacer between switchette and interlock box (5/16 in. thick)
53	9098072P2	1	Spacer between switchette and interlock box (5/8 in. thick)
54	N37P13016B	2	Screw fastening switchette and spacer to interlock box (6-32, 1 in.)
55	N37P13020B	2	Screw fastening switchette and spacer to interlock box (6-32, 1 1/4 in.)
56	9664626P1	1	Interlock box
57	2401918	4	Mounting stud
58	9664626P2	2	Cover for interlock box
59	9098440	4	Spacer between interlock and rheostat
	9644531	2	Cover for interlock coupling and brush rigging assembly, for interlock mechanism Cat.No. 9653797G4 only

WASHERS

Cat.No.	Description
N402P9B	For No. 10 screw
N402P11B	For 1/4 in. screw
N402P12B	For 5/16 in. screw

NUTS

N210P13B	6-32, hex. std
N210P21B	1/4 in.-20, hex. std
N210P23B	5/16 in.-18, hex. std

LOCK WASHERS

Cat.No.	Description
N405P5B	For No. 4 screw
N403P13B	For No. 6 screw, Shakeproof
N405P8B	For No. 8 screw
N405P9B	For No. 10 screw
N405P11B	For 1/4 in. screw
N403P25B	For 1/4 in. screw, Shakeproof
N405P12B	For 5/16 in. screw

GENERAL ELECTRIC COMPANY, INDUSTRY CONTROL DEPARTMENT, SALEM, VA. 24153