

RENEWAL PARTS

IC2800-1619 CONTACTORS

(also CR2800-1619)

Forms A, B, C, H, J, K, M, N, and Q

NOTE:—When ordering parts for a form of the contactor not covered by this bulletin, give reference number, description of part, complete nameplate reading, and above bulletin (GEF) number. *Do not use catalog number when form for which the parts are needed is not covered by the bulletin.*

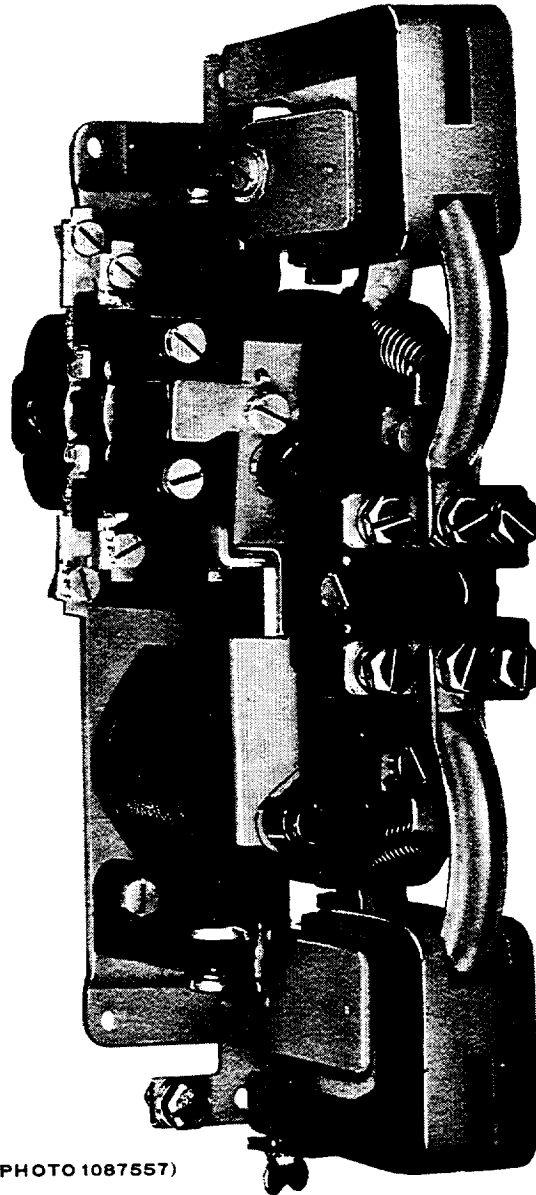

(PHOTO 1087557)

IC2800-1619C contactor

When ordering renewal parts, give quantity, catalog number, description of each item required, and complete nameplate reading.

GENERAL  ELECTRIC

IC2800-1619 CONTACTORS

PARTS RECOMMENDED FOR NORMAL STOCK

Ref. No.	No. Req. for IC2800-1619-									Catalog Number	Description
	A	B	C	H	J	K	M	N	Q		
1	1	1	1	1	1	1	1	1	1	-----	Operating coil (see table below) Holding coil (see table below) Set of interlock contacts (see table on page 4)
2	1	-	1	-	1	-	-	1	1	-----	
	Δ	Δ	Δ	Δ	Δ	Δ	Δ	Δ	Δ	-----	
12	2	2	2	2	2	2	2	2	2	8067076G1	Movable contact finger
51	2	2	2	2	2	2	2	2	2	6973075G1	Stationary contact tip
13	1	1	1	1	1	1	1	1	1	2418818	Compression spring for upper movable contact finger
14	1	1	1	1	1	1	1	1	1	2417929	Compression spring for lower movable contact finger
10	1	1	1	1	1	1	1	1	1	2418823	Compression spring for armature
17	2	2	2	2	2	2	2	2	2	9043584G1	Shunt for movable contact finger
40	-	-	2	1	1	1	1	2	2	8650867P1	Arc chute

Δ If interlock is used, a quantity of one set is required for each interlock.

Ref. No. 1 - OPERATING COILS - 1 Required

NOTE: - The operating coil is identified by the number following the form letter in the IC designation.

Example: - IC2800-1619-A-2-3-B requires operating coil number 2, Cat. No. 22D154G2.

Coil Number	Catalog Number	Coil Number	Catalog Number	Coil Number	Catalog Number	Coil Number	Catalog Number
2	22D154G2	8	22D154G8	14	22D154G14	20	22D154G20
3	22D154G3	9	22D154G9	15	22D154G15	21	22D154G21
4	22D154G4	10	22D154G10	16	22D154G16	22	22D154G22
5	22D154G5	11	22D154G11	17	22D154G17	23	22D154G23
6	22D154G6	12	22D154G12	18	22D154G18	24	22D154G24
7	22D154G7	13	22D154G13	19	22D154G19		

Ref. No. 2 - HOLDING COILS - 1 Required
(For Forms A, C, J, N, and Q only)

NOTE: - The holding coil is identified by the number following the operating coil number in the IC designation.

Example: - IC2800-1619-A-2-3-B requires holding coil number 3, Cat. No. 22D154G3.

Coil Number	Catalog Number	Coil Number	Catalog Number	Coil Number	Catalog Number	Coil Number	Catalog Number
2	22D154G2	8	22D154G8	14	22D154G14	20	22D154G20
3	22D154G3	9	22D154G9	15	22D154G15	21	22D154G21
4	22D154G4	10	22D154G10	16	22D154G16	22	22D154G22
5	22D154G5	11	22D154G11	17	22D154G17	23	22D154G23
6	22D154G6	12	22D154G12	18	22D154G18	24	22D154G24
7	22D154G7	13	22D154G13	19	22D154G19		

IC2800-1619 CONTACTORS

GEF-4061

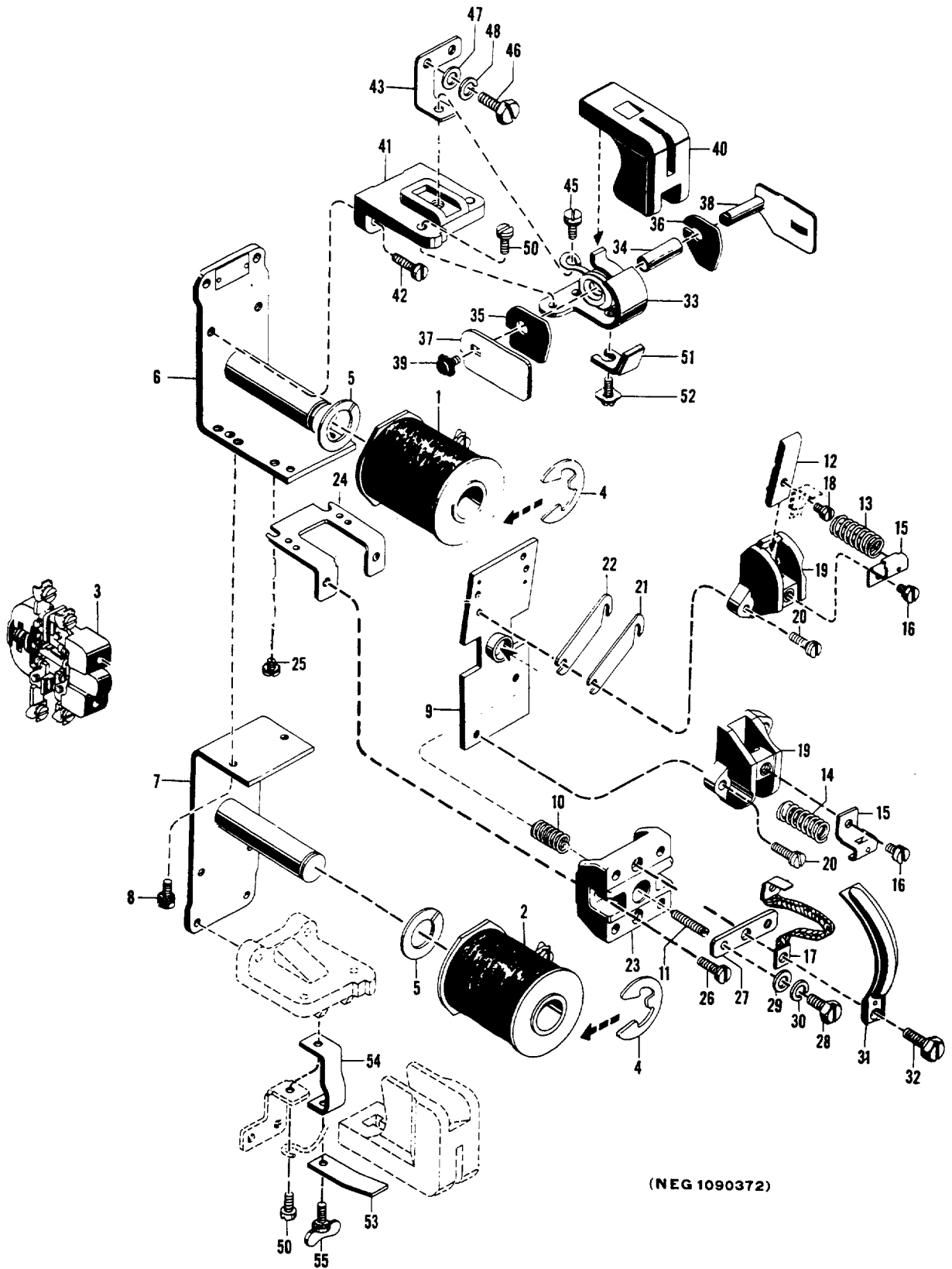

IC2800-1619 CONTACTORS

ELECTRICAL INTERLOCKS

NOTE:- The interlock is identified by the letter or letter and number following the coil number in the IC designation.

Examples:- IC2800-1619-A-2-3B requires interlock letter B, Cat. No. 8201985B.
 IC2800-1619-A-2-3-X1 requires interlock letter and number X1, Cat. No. 6927495G5.

Interlock Letter	Interlock with Mounting Parts		Ref. No. 3	§Set of Interlock Contacts
	Right-hand	Left-hand	Interlock Switch Unit	
	Cat. No.	Cat. No.	Cat. No.	Cat. No.
B	-----	8201985B	142L274G9	6960053G1
C	8201985C	-----	142L274G9	6960053G1
D	-----	8201985D	142L274G8	6960053G2
E	8201985E	-----	142L274G8	6960053G2
F	-----	8201985F	142L274G1	6960053G3
G	8201985G	-----	142L274G1	6960053G3
H	-----	8201985H	142L274G3	6960053G3
J	8201985J	-----	142L274G3	6960053G3
K	-----	8201985K	142L274G2	6960053G3
L	8201985L	-----	142L274G2	6960053G3

Interlock Number	Ref. No. 3		§Set of Interlock Contacts	Interlock Number	Ref. No. 3		§Set of Interlock Contacts
	Interlock Switch Unit				Interlock Switch Unit		
	Right-hand	Left-hand			Right-hand	Left-hand	
	Cat. No.	Cat. No.			Cat. No.	Cat. No.	
X1	-----	6927495G5	6960046G56	X7	-----	6927495G3	6960046G55
X3	-----	6927495G4	6960046G56	X9	-----	6927495G1	6960046G55
X5	-----	6927495G2	6960046G55				

§ Includes movable and stationary contacts with springs and contact-holding screws.

COMPLETE LIST OF PARTS

Ref. No.	No. Req. for IC2800-1619-									Catalog Number	Description
	A	B	C	H	J	K	M	N	Q		
4	2	1	2	1	2	1	1	2	2	101X862	Retainer for operating or holding coil
5	2	1	2	1	2	1	1	2	2	8626009P6	Lock washer for operating or holding coil
6	1	1	1	1	1	1	1	1	1	8650866G1	Magnet frame with core, upper
7	1	1	1	1	1	1	1	1	1	8650871G1	Magnet frame with core, lower
8	2	2	2	2	2	2	2	2	2	N144P16006C	Screw with lock washer fastening lower magnet frame to upper magnet frame (10-32, 3/8 in. pan hd., pro. fin.)
9	1	1	1	1	1	1	1	1	1	8650869G2	Armature with spring seat and stop
10	1	1	1	1	1	1	1	1	1	2418823	Compression spring for armature
11	1	1	1	1	1	1	1	1	1	9023691	Adjusting screw for compression spring
12	2	2	2	2	2	2	2	2	2	8067076G1	Movable contact finger
13	1	1	1	1	1	1	1	1	1	2418818	Compression spring for upper movable contact finger
14	1	1	1	1	1	1	1	1	1	2417929	Compression spring for lower movable contact finger
15	2	2	2	2	2	2	2	2	2	8650870P3	Support for compression spring
16	2	2	2	2	2	2	2	2	2	N144P16004C	Screw with lock washer fastening spring support to molded support (10-32, 1/4 in. pan hd., pro. fin.)
17	2	2	2	2	2	2	2	2	2	9043584G1	Shunt for movable contact finger
18	2	2	2	2	2	2	2	2	2	9693201P1	Screw with lock washer fastening shunt to movable contact finger
19	2	2	2	2	2	2	2	2	2	8650873P1	Molded support for movable contact finger
20	4	4	4	4	4	4	4	4	4	N144P16010C	Screw with lock washer fastening molded support to armature (10-32, 5/8 in. pan hd., pro. fin.)
21	†	†	†	†	†	†	†	†	†	9644199P1	Shim between molded support and armature (0.030 in. thick)

† Quantity variable.

IC2800-1619 CONTACTORS

GEF-4061

Ref. No.	No. Req. for IC2800 1619-									Catalog Number	Description
	A	B	C	H	J	K	M	N	Q		
22	†	†	†	†	†	†	†	†	†	9644199P2	Shim between molded support and armature (0.062 in. thick)
23	1	1	1	1	1	1	1	1	1	9043480G1	Terminal block
24	1	1	1	1	1	1	1	1	1	8650868P8	Supporting bracket for terminal block
25	2	2	2	2	2	2	2	2	2	N144P16006C	Screw with lock washer fastening supporting bracket to magnet frame (10-32, 3/8 in. pan hd., pro. fin.)
26	2	2	2	2	2	2	2	2	2	N144P16012C	Screw with lock washer fastening terminal block to supporting bracket (10-32, 3/4 in. pan hd., pro. fin.)
27	2	2	2	2	2	2	2	2	2	8650871P4	Connection strip for terminal block
28	2	2	2	2	2	2	2	2	2	N26P21010B	Connection screw for terminal block (1/4 in. -20, 5/8 in. hex. hd. slot, pro. fin.)
29	2	2	2	2	2	2	2	2	2	N402P11B	Washer for connection screw
30	2	2	2	2	2	2	2	2	2	N405P41B	Lock washer for connection screw
31	-	-	2	1	1	1	1	2	2	8650869G1	Arcing horn
32	2	2	2	2	2	2	2	2	2	9693215P1	Screw with lock washer fastening connection strip, shunt, and arcing horn to terminal block
33	-	-	2	-	-	-	-	-	-	9043373G2	Blowout coil and stationary contact tip support
	-	-	-	1	-	-	-	-	-	3243603	Blowout coil
	-	-	-	-	1	1	-	2	-	3243604	Blowout coil
33	-	-	-	-	-	-	1	-	-	9043373G1	Blowout coil and stationary contact tip support
	-	-	-	-	-	-	-	-	2	3247664	Blowout coil
	-	-	-	1	1	1	-	2	2	8650868P1	Stationary contact tip support
34	-	-	2	-	-	-	1	2	2	9023914	Insulation tube for blowout coil
35	-	-	2	1	1	1	1	2	2	9043375P1	Insulation for blowout coil, left-hand
36	-	-	2	1	1	1	1	2	2	9043375P2	Insulation for blowout coil, right-hand
37	-	-	2	1	1	1	1	2	2	8650868P4	Pole piece, left-hand
38	-	-	2	1	1	1	1	2	2	8650868G1	Pole piece, right-hand
39	-	-	2	1	1	1	1	2	2	N57P15005B	Screw fastening pole piece and insulation to core (8-32, 5/16 in. pan hd., pro. fin.)
40	-	-	2	1	1	1	1	2	2	8650867P1	Arc chute
41	2	2	2	2	2	2	2	2	2	9043374P1	Insulation base
42	4	4	4	4	4	4	4	4	4	N144P16010C	Screw with lock washer fastening insulation base to magnet frame (10-32, 5/8 in. pan hd., pro. fin.)
43	-	-	2	1	1	1	1	2	2	8650872P7	Terminal support
45	-	-	2	1	1	1	1	2	2	N144P16008C	Screw with lock washer fastening blowout coil lead and terminal support to insulation base (10-32, 1/2 in. pan hd., pro. fin.)
46	2	2	2	2	2	2	2	2	2	N26P21010B	Connection screw for terminal support or stationary contact tip support (1/4 in. -20, 5/8 in. hex. hd. slot, pro. fin.)
47	2	2	2	2	2	2	2	2	2	N405P41B	Lock washer for connection screw
48	2	2	2	2	2	2	2	2	2	N402P11B	Plain washer for connection screw
	2	2	-	1	1	1	1	-	-	8650870P2	Support for stationary contact tip support
50	4	4	4	4	4	4	4	4	4	N144P16010C	Screw with lock washer fastening stationary contact tip support to insulation base (10-32, 5/8 in. pan hd., pro. fin.)
51	2	2	2	2	2	2	2	2	2	6973075G1	Stationary contact tip
52	2	2	2	2	2	2	2	2	2	9384190P1	Screw with lock washer fastening stationary contact tip to support
53	-	-	2	1	1	1	1	2	2	8650870P6	Clamp for arc chute
54	-	-	2	1	1	1	1	2	2	8650870P5	Supporting bracket for clamp
55	-	-	2	1	1	1	1	2	2	9693202P1	Wing screw fastening clamp to supporting bracket

† Quantity variable.

IC2800-1619 CONTACTORS

INDEX OF CATALOG NUMBERS

Catalog identifications in this index are arranged in order, reading from *left to right*, first alphabetically according to the prefix letter or letters, if used, and second numerically.

In this index all numbers with a letter prefix will precede those without prefixes.

The number of letters or digits does not affect placement in the table, thus A1999999 will precede A2, and ZZ9999999 will precede Cat. No. 1 (number without a prefix). Letters take precedence over numbers so that Cat. No. 26F1 will precede Cat. No. 261.

Catalog Number	Page	Catalog Number	Page	Catalog Number	Page	Catalog Number	Page
N144P16004C	---- 4	22D154G2	----- 2	6960046G56	----- 4	8650869G2	----- 4
N144P16006C	--- 4, 5	22D154G20	----- 2	6960053G1	----- 4	8650870P2	----- 5
N144P16008C	---- 5	22D154G21	----- 2	6960053G2	----- 4	8650870P3	----- 4
N144P16010C	--- 4, 5	22D154G22	----- 2	6960053G3	----- 4	8650870P5	----- 5
N144P16012C	---- 5	22D154G23	----- 2	6973075G1	----- 2, 5	8650870P6	----- 5
N26P21010B	---- 5	22D154G24	----- 2	8067076G1	----- 2, 4	8650871G1	----- 4
N402P11B	----- 5	22D154G3	----- 2	8201985B	----- 4	8650871P4	----- 5
N405P41B	----- 5	22D154G4	----- 2	8201985C	----- 4	8650872P7	----- 5
N57P15005B	---- 5	22D154G5	----- 2	8201985D	----- 4	8650873P1	----- 4
101X862	----- 4	22D154G6	----- 2	8201985E	----- 4	9023691	----- 4
142L274G1	----- 4	22D154G7	----- 2	8201985F	----- 4	9023914	----- 5
142L274G2	----- 4	22D154G8	----- 2	8201985G	----- 4	9043373G1	----- 5
142L274G3	----- 4	22D154G9	----- 2	8201985H	----- 4	9043373G2	----- 5
142L274G8	----- 4	2417929	----- 2, 4	8201985J	----- 4	9043374P1	----- 5
142L274G9	----- 4	2418818	----- 2, 4	8201985K	----- 4	9043375P1	----- 5
22D154G10	----- 2	2418823	----- 2, 4	8201985L	----- 4	9043375P2	----- 5
22D154G11	----- 2	3243603	----- 5	8626009P6	----- 4	9043480G1	----- 5
22D154G12	----- 2	3243604	----- 5	8650866G1	----- 4	9043584G1	----- 2, 4
22D154G13	----- 2	3247664	----- 5	8650867P1	----- 2, 5	9384190P1	----- 5
22D154G14	----- 2	6927495G1	----- 4	8650868G1	----- 5	9644199P1	----- 4
22D154G15	----- 2	6927495G2	----- 4	8650868P1	----- 5	9644199P2	----- 5
22D154G16	----- 2	6927495G3	----- 4	8650868P4	----- 5	9693201P1	----- 4
22D154G17	----- 2	6927495G4	----- 4	8650868P8	----- 5	9693202P1	----- 5
22D154G18	----- 2	6927495G5	----- 4	8650869G1	----- 5	9693215P1	----- 5
22D154G19	----- 2	6960046G55	----- 4				

GENERAL ELECTRIC SALES OFFICES

READY TO ASSIST YOU... When You Have Electrical Problems... Need Further Information... Require Ordering Instructions

KEY TO SALES OPERATIONS
 A - Agency & Distributor
 C - Components Sales
 I - Industrial Sales
 M - Marine & Defense Facilities Sales
 U - Electric Utility Sales

ALABAMA
 A C I U Birmingham 35205 2151 Highland Ave.
 I Huntsville 35801 3222 Memorial Pkwy. S.
 A I Mobile 36606 1111 S. Beltline Hwy.
 Montgomery 36107 513 Madison Ave.

ARIZONA
 A C I U Phoenix 84012 3550 N. Central Ave.
 A I U Tucson 85711 40 No. Swan Rd.

ARKANSAS
 A C I N. Little Rock 72119 120 Main St.
 U Pine Bluff 71602 P. O. Box 1933

CALIFORNIA
 C Burlingame 94010 1675 Rollins Rd.
 A I Emeryville 94608 5000 Shilohwood St.
 A I Fresno 93728 1532 N. West Ave.
 C Los Angeles 90015 1543 W. Olympic Blvd.
 A I M U Los Angeles 90054 212 N. Vignes St.
 Sacramento 95808 2407 "J" St.
 A M U San Diego 92103 2560 Cherry Ave.
 A I M U San Francisco 94106 225 Montgomery St.
 A Santa Clara 95050 1400 Coleman Ave.

COLORADO
 A C I U Denver 80206 201 University Blvd.

CONNECTICUT
 I U Hamden 06518 2905 Dixwell Ave.
 A C U Hartford 06106 764 Asylum Ave.

DISTRICT OF COLUMBIA
 I M U Washington 20005 777-14th St., N. W.

FLORIDA
 A M Cocoa Beach 32931 1325 N. Atlantic Ave.
 A I U Jacksonville 32207 4040 Woodcock Dr.
 A U Miami 33134 4100 W. Flagler St.
 A Orlando 32823 601 N. Fern Creek Ave.
 U Pensacola 32502 P. O. Box 1027
 A C I U Tampa 33609 2106 S. Lois Ave.

GEORGIA
 A C I U Atlanta 30309 1660 Peachtree Rd. N. W.
 A Macon 31201 582 Cherry St.
 A I Savannah 31405 5002 Paulsen St.

IDAHO
 A U Boise 83701 1524 Idaho St.

ILLINOIS
 A I M U Chicago 60630 840 S. Canal St.
 C Oakbrook 60521 1200 Harger Rd.
 A I U Peoria 61601 2008 W. E. Perry Ave.
 A I Rockford 61108 4223 E. State St.
 U Springfield 62701 607 E. Adams St.

INDIANA
 A C U Evansville 47714 2706 Washington St.
 C Fort Wayne 46804 1635 Broadway
 A U Fort Wayne 46806 6001 S. Anthony Blvd.
 A I Indianapolis 46207 3750 N. Meridian St.
 C Indianapolis 46240 1010 E. 86th St.
 A C South Bend 46601 450 N. Michigan St.

IOWA
 C Bettendorf 52722 2435 Kimberly Rd.
 U Cedar Rapids 52401 210 Second St., S. E.
 A I C Davenport (1039 State St., Bettendorf 52722)
 A U Des Moines 50310 3839 Merle Hay Rd.
 U Sioux City 51101 520 Pierce St.

KANSAS
 C Overland Park 66204 7219 Metcalf St.
 A Wichita 67211 820 E. Indianapolis Ave.
 U Wichita 67202 104 S. Broadway Suite 1408

KENTUCKY
 A U Lexington 40502 443 S. Ashland Ave.
 A I U Louisville 40218 2300 Meadow Dr.

LOUISIANA
 A U Alexandria 71301 2001 MacArthur Dr.
 I Baton Rouge 70815 633 Oak Villa Blvd.
 I Lake Charles 70601 1424 Ryan St.
 I Monroe 71201 1028 N. Sixth St.

A I New Orleans 70125 4747 Earhart Blvd.
 U New Orleans 70112 225 Baronne St.
 M New Orleans 70130 390 Inter. Trade Mart.
 A U Shreveport 71101 400 Travis St.

MADISE
 U Augusta 04300 152 State St.
 U Bangor 04402 177 Central St.

MARYLAND
 I U Baltimore 21201 1 N. Charles St.
 A Columbia 21403 10221 Wirecann Circle
 A U Hagerstown 21740 49 E. Franklin St.
 A Salisbury 21801 P. O. Box 424

MASSACHUSETTS
 I U Boston 02117 31 St. James Ave.
 I Springfield 01103 120 Maple St.
 A C I M Wellesley 02181 1 Washington St.

MICHIGAN
 A C I U Detroit 48202 700 Antoinette St.
 I Flint 48502 801 S. Saginaw St.
 A C I Grand Rapids 49509 2821 Madison Ave., S. E.
 A U Jackson 49201 210 W. Franklin St.
 I Saginaw 48601 805 2nd National Bank Bldg.
 A Saginaw 48601 1220 S. Washington Ave.

MINNESOTA
 I U Sulu 55802 14 W. Superior St.
 A U Fergus Falls 56537 201 1/2 Lincoln Ave., W.
 C Minneapolis 55424 4018 W. 65th St.
 A I U Minneapolis 55416 1500 Lutac Dr., S.

MISSISSIPPI
 U Gulfport 39502 P. O. Box 33
 A Jackson 39206 333 No. Mart Plaza
 U Jackson 39205 Rm. 917 Electric Bldg.

MISSOURI
 A Joplin 64802 310 Wall St.
 A I U Kansas City 64105 811 Main St.
 A C I U St. Louis 63101 1015 Locust St.

MONTANA
 A Billings 59101 312 Transwestern Life Bldg.
 A I U Butte 59701 103 N. Wyoming St.

NEBRASKA
 A I U Omaha 68102 409 S. 17th St.

NEVADA
 U Las Vegas 89106 1711 S. 8th St.

NEW HAMPSHIRE
 U Manchester 06104 46 Bay St.

NEW JERSEY
 C East Orange 07017 56 Melmore Gardens
 A I U Millburn 07041 25 E. Willow St.

NEW MEXICO
 A I M U Albuquerque 87108 120 Madeira Dr., N. E.

NEW YORK
 A I M U Albany 12206 8 Colvin Ave.
 U Binghamton 13902 40 Front St.
 A I U Buffalo 14202 625 Delaware Ave.
 A Elmford 10514 44 N. Central Ave.
 A I M U New York 10023 641 Lexington Ave.
 C Rochester 14618 3380 Monroe Ave.
 A I U Rochester 14604 339 East Ave.
 C Syracuse 13206 2360 James St.
 A I U Syracuse 13206 3532 James St.
 A Vestal 13805 P. O. Box 407

NORTH CAROLINA
 A C I U Charlotte 28207 141 Providence Rd.
 A I Greensboro 27405 801 Summit Blvd.
 A U Raleigh 27603 120 N. Boylan Ave.

NORTH DAKOTA
 U Bismarck 58501 418 Rosser Ave.

OHIO
 I U Akron 44313 2858 W. Market St.
 A Akron 44313 (Agency & Distributor)
 I Canton 44703 2855 W. Market St.
 I U Canton 44703 515 Third St., N. W.
 A C I U Cincinnati 45206 2621 Victory Pkwy.
 C Cleveland 44116 20950 Center Ridge Rd.
 A I M U Cleveland 44114 1005 Lakeway Ave.
 C Columbus 43212 397 Burrill Ave.
 A I U Columbus 43215 935 E. Broad St.
 C Dayton 45402 11 W. Monument Bldg.

A I U Dayton 45439 3430 S. Dixie Hwy.
 C Mansfield 44902 166 Park Ave., W.
 A C I Toledo 43606 3450 W. Central Ave.
 U Toledo 43604 420 Madison Ave.
 A I Youngstown 44507 272 E. Indianola Ave.

OKLAHOMA
 A U Oklahoma City 73106 2000 Classen Blvd.
 A I Tulsa 74105 5138 S. Peoria Ave.
 U Tulsa 74103 420 Main St.

OREGON
 A I U Eugene 97401 1170 Pearl St.
 A U Medford 97501 107 E. Main St.
 A C I U Portland 97210 2929 N. W. 29th Ave.

PENNSYLVANIA
 A I U Allentown 18102 732 N. 16th St.
 A I Erie 16501 3001 E. Lake Rd.
 I U Johnstown 15902 841 Oak St.
 C Philadelphia 19114 2417 Welsh Rd.
 A I M U Philadelphia 19102 3 Penn Center Plaza
 C Pittsburgh 15234 300 Mt. Lebanon Blvd.
 A U Pittsburgh 15222 Oliver Bldg., Mellon Sq.
 A Williamsport 17701 2209 Fink Ave.
 C York 17403 56 N. Harrison St.
 I York 17403 1617 E. Market St.

RHODE ISLAND
 A Providence 02904 1006 Charles St., N. E.

SOUTH CAROLINA
 A I U Columbia 29205 2728 Devine St.
 A I Greenville 29606 1403 Laurens Rd.

SOUTH DAKOTA
 A U Sioux Falls 57105 513 Main Ave.

TENNESSEE
 U Chattanooga 37402 832 Georgia Ave.
 A C I Chattanooga 37411 5800 Bldg. Eastgate Center
 I Kingsport 37664 1170 E. Eastman Rd.
 A U Knoxville 37921 1301 Hannah Ave., N. W.
 A I U Memphis 38104 1420 Union Ave.
 U Murfreesboro 37130 117 N. W. Broad St.
 C Nashville 37203 1717 West End Bldg.
 A Nashville 37204 2930 Sisco Drive
 M Oak Ridge 37830 253 Main St., East

TEXAS
 U Abilene 79601 442 Cedar St.
 U Amarillo 79101 303 Folk St.
 A I U Beaumont 77701 1385 Calder Ave.
 U Corpus Christi 78401 205 N. Chaparral St.
 A C I U Dallas 75247 8101 Stemmons Freeway
 I El Paso 79901 215 N. Stanton St.
 A El Paso 79902 2800 N. Stanton St.
 A Fort Worth 76107 100 N. Univ. Dr.
 U Fort Worth 76102 408 W. 7th St.
 A C I U Houston 77027 4219 Richmond Ave.
 A I Lubbock 79408 500 E. 50th St.
 A I Midland 79704 122 N. "M" St.
 A C U San Antonio 78204 419 S. Main Ave.

UTAH
 A I U Salt Lake City 84101 431 S. Third E. St.
 C Salt Lake City 84110 2425 S. 8th St.

VERMONT
 U Rutland 05702 38 1/2 Center St.

VIRGINIA
 A M Newport News 23601 311 Main St.
 A I U Richmond 23230 1508 Willow Lawn Dr.
 A I U Roanoke 24015 2018 Colonial Ave., SW

WASHINGTON
 U Pasco 99301 824 W. Lewis St.
 A I M U Seattle 98188 112 Andover Park E.
 A I U Spokane 99220 E. 1805 Trent Ave.

WEST VIRGINIA
 A I Charleston 25328 306 MacCorkle Ave., SE
 I Fairmont 26555 310 Jacobs Bldg.
 A Huntington 25701 1401 Sixth Ave.
 I Wheeling 26002 40 14th St.

WISCONSIN
 A I U Appleton 54911 3003 W. College Ave.
 U Madison 53703 340 W. Washington Ave.
 C Milwaukee 53226 Mayfair Plaza, 2421 N. Mayfair Rd.
 A I U Milwaukee 53202 615 E. Michigan St.

CANADA
 Canadian General Electric Company, Ltd.
 Toronto

GENERAL ELECTRIC SERVICE SHOPS

WHEN YOU NEED SERVICE... These GE service shops will repair, recondition, and rebuild your electric apparatus. The facilities are available day and night, seven days a week, for work in the shops or on your premises. Latest factory methods and genuine GE renewal parts are used to maintain peak performance of your equipment. For full information about these services, contact your nearest service shop or sales office.

ALABAMA
 Birmingham 35211 1500 Mims Ave., S. W.

ARIZONA
 Phoenix 85019 3840 W. Clarendon Ave.
 (Instrumentation Service)

CALIFORNIA
 Inglewood 90301 Los Angeles Instrumentation Service
 Los Angeles 90001 6900 Stanford Ave.
 Oakland 94608 3400 Wood St.
 Sacramento 95814 99 North 17th St.
 San Francisco 94103 1089 Harrison St.

COLORADO
 Denver 80205 3353 Larimer St.

CONNECTICUT
 (Southington) Plantsville 06479 370 Atwater St.

FLORIDA
 Jacksonville 32203 2020 W. Beaver St.
 (Miami) Hialeah 33010 1062 E. 28th St.
 Tampa 33601 P. O. Box 1245

GEORGIA
 (Atlanta) Chamblee 30005 5035 Peachtree Industrial Blvd.

ILLINOIS
 Chicago 60638 6045 S. Nottingham Ave.

INDIANA
 Ft. Wayne 46803 1731 Edsall Ave.
 Indianapolis 46222 1740 W. Vermont St.

IOWA
 (Davenport) Bettendorf 52722 1025 State St.

KENTUCKY
 Louisville 40209 3900 Crittenden Dr.

LOUISIANA
 New Orleans 70114 1115 De Armas St.

MARYLAND
 Baltimore 21230 920 E. Fort Ave.

MASSACHUSETTS
 (Boston) Medford 02155 3960 Mystic Valley Parkway

MICHIGAN
 Detroit 48202 5950 Third St.
 Flint 48505 1506 E. Carpenter Rd.

MINNESOTA
 Minneapolis 55430 2025-49th Ave., N.
 W. Duluth 55807 P. O. Box 7198

MISSOURI
 Kansas City 64120 3525 Gardner Ave.
 St. Louis 63110 1115 East Road

NEW YORK
 Albany 12205 1097 Central Ave.
 Buffalo 14211 313 Urban St.
 Clifton, N. J. 07012 New York Instrumentation Service
 North Bergen, N. J. 07047 6001 Tonnelie Ave.
 Schenectady 12305 (Instrumentation Service) 1 River Road
 Syracuse 13208 1015 E. Hiawatha Blvd.

NORTH CAROLINA
 Charlotte 28208 2328 Thrift Road

OHIO
 Cincinnati 45202 444 W. Third St.
 Cleveland 44125 4477 East 49th St.
 Columbus 43229 5660 Huntley Rd.
 Toledo 43605 405 Dearborn Ave.
 Youngstown 44507 272 E. Indianola Ave.

OREGON
 Portland 97210 2727 N. W. 29th Ave.

PENNSYLVANIA
 Allentown 18103 668 E. Highland St.
 Johnstown 15905 841 Oak St.
 Philadelphia 19124 1040 E. Erie Ave.
 (Pittsburgh) West Mifflin, Pa. 15122 4930 Buttermilk Hollow Rd., R. D. #1
 York 17403 54 N. Harrison St.

TENNESSEE
 Knoxville 37914 2621 Gov. John Sevier Hwy.
 Memphis 38107 708 No. Main St.

TEXAS
 Corpus Christi 78401 115 Waco St.
 Dallas 75235 3202 Manor Way
 Houston 77020 5584 Harvey Wilson Dr.
 Midland 79701 704 S. Johnston St.

UTAH
 Salt Lake City 84110 301 S. 7th West St.

VIRGINIA
 Richmond 23224 1403 Ingram Ave.
 Roanoke 24013 1004 River Ave., S. E.

WASHINGTON
 Seattle 98134 3422 First Ave., S.
 Spokane 99211 E. 4323 Mission St.

WEST VIRGINIA
 Charleston 25328 306 MacCorkle Ave., S. E.

WISCONSIN
 Appleton 54910 P. O. Box 83
 Milwaukee 53207 235 W. Oklahoma Ave.