



# RENEWAL PARTS

GEF-4062B  
Supersedes GEF-4062A  
and GEF-3757D

## IC2800-1609 CONTACTORS

Forms A thru DA

**NOTE:**—When ordering parts for a form of the contactor not covered by this bulletin, give reference number, description of part, complete nameplate reading, and above bulletin (GEF) number. *Do not use catalog number when form for which the parts are needed is not covered by the bulletin.*

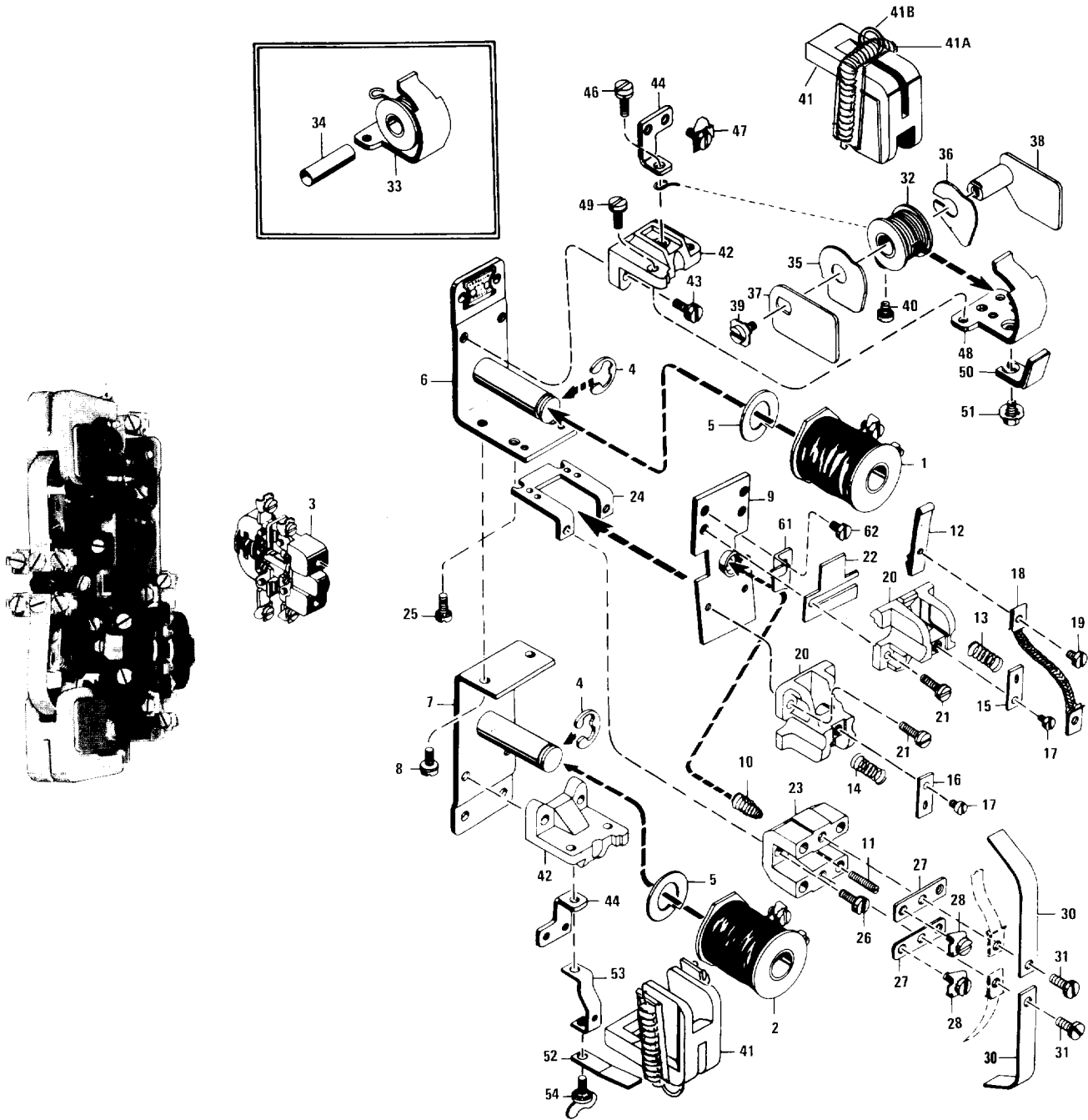

When ordering renewal parts, give quantity, catalog number, description of each item required, and complete nameplate reading.

GENERAL  ELECTRIC

IC2800-1609 CONTACTORS

GEF-4062

COMPLETE LIST OF PARTS (CONT'D)

Ref. No.	No. Req. for IC2800-1609																				Catalog Number	Description					
	AA	AB	AC	AD	AE	AF	AG	AH	AJ	AK	AL	AM	AN	AP	BE	BF	BG	BH	BJ	BK			BL	BM	BW	CA	DA
4	1	2	1	1	1	2	2	2	2	2	1	1	2	2	2	1	2	1	2	1	2	1	2	1	2	N910P50B6	Retainer for operating coil or holding coil
5	1	2	1	1	1	2	2	2	2	2	1	1	2	2	2	1	2	1	2	1	2	1	2	1	2	9023730	Lockwasher for operating coil or holding coil
6	1	1	1	1	1	1	1	1	1	1	1	1	1	1	1	1	1	1	1	1	1	1	1	1	1	8650770G2	Magnet frame with core, upper
7	1	1	1	1	1	1	1	1	1	1	1	1	1	1	1	1	1	1	1	1	1	1	1	1	1	8650771G1	Magnet frame with core, lower
8	2	2	2	2	2	2	2	2	2	2	2	2	2	2	2	2	2	2	2	2	2	2	2	2	2	N144P16006C	Screw with lockwasher fastening lower magnet frame to upper magnet frame
9	1	1	1	1	1	1	1	1	1	1	1	1	1	1	1	1	1	1	1	1	1	1	1	1	1	8650775G1	Armature with spring seat and stop
10	1	1	1	1	1	1	1	1	1	1	1	1	1	1	1	1	1	1	1	1	1	1	1	1	1	2418822	Compression spring for armature
11	1	1	1	1	1	1	1	1	1	1	1	1	1	1	1	1	1	1	1	1	1	1	1	1	1	9023691	Adjusting screw for compression spring
12	2	2	2	2	2	2	2	2	2	2	2	2	2	2	2	2	2	2	2	2	2	2	2	2	2	6974772G1	Movable contact finger
13	1	1	1	1	1	1	1	1	1	1	1	1	1	1	1	1	1	1	1	1	1	1	1	1	1	2418819	Compression spring for upper movable contact finger
14	1	1	1	1	1	1	1	1	1	1	1	1	1	1	1	1	1	1	1	1	1	1	1	1	1	2419451	Compression spring for lower movable contact finger
15	1	1	1	1	1	1	1	1	1	1	1	1	1	1	1	1	1	1	1	1	1	1	1	1	1	8650777P9	Support for upper compression spring
16	1	1	1	1	1	1	1	1	1	1	1	1	1	1	1	1	1	1	1	1	1	1	1	1	1	9694754	Support for lower compression spring
17	2	2	2	2	2	2	2	2	2	2	2	2	2	2	2	2	2	2	2	2	2	2	2	2	2	N144P13004C	Screw with lockwasher fastening upper or lower spring
18	2	2	2	2	2	2	2	2	2	2	2	2	2	2	2	2	2	2	2	2	2	2	2	2	2	9043178G1	Shunt for movable contact finger
19	2	2	2	2	2	2	2	2	2	2	2	2	2	2	2	2	2	2	2	2	2	2	2	2	2	N144P13004C	Screw with lockwasher fastening shunt to movable contact finger
20	2	2	2	2	2	2	2	2	2	2	2	2	2	2	2	2	2	2	2	2	2	2	2	2	2	8650773P1	Molded support for movable contact finger
21	4	4	4	4	4	4	4	4	4	4	4	4	4	4	4	4	4	4	4	4	4	4	4	4	4	N144P15008C	Screw with lockwasher fastening molded support to armature
22	6	6	6	6	6	6	6	6	6	6	6	6	6	6	6	6	6	6	6	6	6	6	6	6	6	9644198P1	Shim between upper molded support and armature (0.030 in. thick)
22	6	6	6	6	6	6	6	6	6	6	6	6	6	6	6	6	6	6	6	6	6	6	6	6	6	9644198P2	Shim between upper molded support and armature (0.062 in. thick)
23	1	1	1	1	1	1	1	1	1	1	1	1	1	1	1	1	1	1	1	1	1	1	1	1	1	9043483G1	Terminal block
24	1	1	1	1	1	1	1	1	1	1	1	1	1	1	1	1	1	1	1	1	1	1	1	1	1	8650775P5	Supporting bracket for terminal block
25	2	2	2	2	2	2	2	2	2	2	2	2	2	2	2	2	2	2	2	2	2	2	2	2	2	N144P15006C	Screw with lockwasher fastening supporting brackets to magnet frame
26	2	2	2	2	2	2	2	2	2	2	2	2	2	2	2	2	2	2	2	2	2	2	2	2	2	N144P16008C	Screw with lockwasher fastening terminal block to supporting bracket
27	2	2	2	2	2	2	2	2	2	2	2	2	2	2	2	2	2	2	2	2	2	2	2	2	2	8650775P7	Connection strip for terminal block
28	4	4	4	4	4	4	4	4	4	4	4	4	4	4	4	4	4	4	4	4	4	4	4	4	4	9108642P15	Terminal clamp with screw and lockwasher
30	1	2	2	2	2	2	2	2	2	2	2	2	2	2	2	2	2	2	2	2	2	2	2	2	2	8650770P6	Arcing horn
31	2	2	2	2	2	2	2	2	2	2	2	2	2	2	2	2	2	2	2	2	2	2	2	2	2	N144P16006C	Screw with lockwasher fastening connection strip, shunt, and arcing horn to terminal block
32	-	-	-	-	-	-	-	-	-	-	-	-	-	-	-	-	-	-	-	-	-	-	-	-	-	3243199	Blowout coil
32	-	-	-	-	-	-	-	-	-	-	-	-	-	-	-	-	-	-	-	-	-	-	-	-	-	3243600	Blowout coil
32	-	-	-	-	-	-	-	-	-	-	-	-	-	-	-	-	-	-	-	-	-	-	-	-	-	3243601	Blowout coil

Quantity variable

# IC2800-1609 CONTACTORS

GEF-4062

## OPERATING COILS, PICK UP RESISTORS, AND RECTIFIERS

NOTE: The number following the form letters in the IC designation identifies the operating coils, pick up resistor and rectifiers. Each must be ordered separately from the table below.

EXAMPLE: IC2800-1609-B-3-B requires coil number 3 Cat. No. 1D106G3A, pick up resistor 3000DA/X131AE, rectifier 6RS22PD12AHD1.

Coil No.	Coil Catalog No.	No. Req'd	Pick Up Resistor IC9006A50E	No. Req'd	Rectifier	No. Req'd
2	1D106G2A	1	-----	-	-----	-
2	1D106G2A	1	4600DA/X131AE	1	6RS22PD12AHD1	2
2	1D106G2A	1	5000DA/X131AE	1	6RS22PD12AHD1	2
2	1D106G2A	1	-----	-	-----	-
2	1D106G2A	1	A50E4000DA-TH	1	IC3500A403C8	1
2	1D106G2A	1	A50E6500DA-TH	1	IC3500A403C5	-
2	1D106G2A	1	A50E4000DA-TH	1	IC3500A403C8	1
2	1D106G2A	1	A50E6500DA-TH	1	IC3500A403C5	1
2	1D106G2A	1	A50E6500DA-TH	1	IC3500A403C8	1
3	1D106G3A	1	-----	-	-----	-
3	1D106G3A	1	3000DA/X131AE	1	6RS22PD12AHD1	1
3	1D106G3A	1	1200DA/X131AL	1	6RS22PD12AHD1	2
3	1D106G3A	1	2300DA/X131AE	1	6RS22PD12AHD1	2
3	1D106G3A	1	2800DA/X131AE	1	6RS22PD12AHD1	2
4	1D106G4A	1	-----	-	6RS22PD12AHD1	2
5	1D106G5A	1	-----	-	-----	-
6	1D106G6A	1	-----	-	-----	-
7	1D106G7A	1	-----	-	-----	-
7	1D106G7A	1	A50E200DA-TH	1	IC3500A403C2	1
7	1D106G7A	1	A50E200DA-TH	1	IC3500A403C2	-
8	1D106G8A	1	-----	-	-----	-
8	1D106G8A	1	A50E750DA-TH	1	IC3500A403C5	1
9	1D106G9A	1	-----	-	-----	-
9	1D106G9A	1	150DA/X131AL	1	6RS22PB3AHD1	1
9	1D106G9A	1	750DA/X131AL	1	6RS22PB3AHD1	1
9	1D106G9A	1	330DA/X131AE	1	6RS22PB6AHD1	1
9	1D106G9A	1	A50E300DA-TH	1	IC3500A403C6	1
10	1D106G10A	1	-----	-	-----	-
10	1D106G10A	1	90DA/X131AE	1	6RS22PB3AHD1	1
10	1D106G10A	1	A50E75DA-TH	1	IC3500A403C2	1
11	1D106G11A	1	-----	-	-----	-
12	1D106G12A	1	-----	-	-----	-
13	1D106G45A	1	-----	-	-----	-
14	1D106G14A	1	-----	-	-----	-
15	1D106B15A	1	-----	-	-----	-
16	Do not use - use G2	1	-----	-	-----	-
17	Do not use - use G2	1	-----	-	-----	-
18	1D106G18A	1	-----	-	-----	-
19	1D106G2A	1	-----	-	-----	-
20	1D106G2A	1	∅	-	-----	-
21	1D106G21A	1	†	-	-----	-
22	1D106G22A	1	-----	-	-----	-
23	1D106G23A	1	-----	-	-----	-
24	1D106G24A	1	-----	-	-----	-
25	1D106G25A	1	-----	-	-----	-
26	1D106G26A	1	-----	-	-----	-
27	1D106G27A	1	-----	-	-----	-
28	1D106G28A	1	-----	-	-----	-
29	1D106G29A	1	-----	-	-----	-
30	1D106G30A	1	-----	-	-----	-
31	Do not use - use G2	1	-----	-	-----	-
32	1D106G93A	1	-----	-	-----	-
33	1D106G33A	1	-----	-	-----	-
34	1D106G34A	1	-----	-	-----	-
35	1D106G35A	1	-----	-	-----	-
36	1D106G36A	1	-----	-	-----	-
37	1D106G2A	1	Δ	-	-----	-
38	1D106G2A	1	Δ	-	-----	-
39	1D106G2A	1	oo	-	-----	-

∅ Requires 6000 ohm resistor. Cat. No. of coil does not include resistor.  
 † Requires 1000 ohm resistor. Cat. No. of coil does not include resistor.  
 Δ Requires 4000 ohm resistor. Cat. No. of coil does not include resistor.  
 oo Requires 3000 ohm resistor. Cat. No. of coil does not include resistor.

# IC2800-1609 CONTACTORS

GEF-4062

COMPLETE LIST OF PARTS

Ref. No.	No. Req. for IC2800-1609																Catalog Number	Description			
	A	B	C	D	E	F	G	H	J	K	L	M	N	P	Q	R			S	T	U
4	2	1	2	1	2	1	2	1	1	2	1	2	1	1	2	1	2	1	2	1	2
5	2	1	2	1	2	1	2	1	1	2	1	2	1	1	2	1	2	1	2	1	2
6	1	1	1	1	1	1	1	1	1	1	1	1	1	1	1	1	1	1	1	1	1
7	1	1	1	1	1	1	1	1	1	1	1	1	1	1	1	1	1	1	1	1	1
8	2	2	2	2	2	2	2	2	2	2	2	2	2	2	2	2	2	2	2	2	2
9	1	1	1	1	1	1	1	1	1	1	1	1	1	1	1	1	1	1	1	1	1
10	1	1	1	1	1	1	1	1	1	1	1	1	1	1	1	1	1	1	1	1	1
11	1	1	1	1	1	1	1	1	1	1	1	1	1	1	1	1	1	1	1	1	1
12	2	2	2	2	2	2	2	2	2	2	2	2	2	2	2	2	2	2	2	2	2
13	1	1	1	1	1	1	1	1	1	1	1	1	1	1	1	1	1	1	1	1	1
14	1	1	1	1	1	1	1	1	1	1	1	1	1	1	1	1	1	1	1	1	1
15	1	1	1	1	1	1	1	1	1	1	1	1	1	1	1	1	1	1	1	1	1
16	1	1	1	1	1	1	1	1	1	1	1	1	1	1	1	1	1	1	1	1	1
17	2	2	2	2	2	2	2	2	2	2	2	2	2	2	2	2	2	2	2	2	2
18	2	2	2	2	2	2	2	2	2	2	2	2	2	2	2	2	2	2	2	2	2
19	2	2	2	2	2	2	2	2	2	2	2	2	2	2	2	2	2	2	2	2	2
20	2	2	2	2	2	2	2	2	2	2	2	2	2	2	2	2	2	2	2	2	2
21	4	4	4	4	4	4	4	4	4	4	4	4	4	4	4	4	4	4	4	4	4
22	5	5	5	5	5	5	5	5	5	5	5	5	5	5	5	5	5	5	5	5	5
22	5	5	5	5	5	5	5	5	5	5	5	5	5	5	5	5	5	5	5	5	5
23	1	1	1	1	1	1	1	1	1	1	1	1	1	1	1	1	1	1	1	1	1
24	1	1	1	1	1	1	1	1	1	1	1	1	1	1	1	1	1	1	1	1	1
25	4	4	4	4	4	4	4	4	4	4	4	4	4	4	4	4	4	4	4	4	4
26	2	2	2	2	2	2	2	2	2	2	2	2	2	2	2	2	2	2	2	2	2
27	2	2	2	2	2	2	2	2	2	2	2	2	2	2	2	2	2	2	2	2	2
28	4	4	4	4	4	4	4	4	4	4	4	4	4	4	4	4	4	4	4	4	4
30	-	-	-	-	-	-	-	-	-	-	-	-	-	-	-	-	-	-	-	-	-
31	2	2	2	2	2	2	2	2	2	2	2	2	2	2	2	2	2	2	2	2	2
32	-	-	-	-	-	-	-	-	-	-	-	-	-	-	-	-	-	-	-	-	-
32	-	-	-	-	-	-	-	-	-	-	-	-	-	-	-	-	-	-	-	-	-
32	-	-	-	-	-	-	-	-	-	-	-	-	-	-	-	-	-	-	-	-	-
32	-	-	-	-	-	-	-	-	-	-	-	-	-	-	-	-	-	-	-	-	-
33	-	-	-	-	-	-	-	-	-	-	-	-	-	-	-	-	-	-	-	-	-
34	-	-	-	-	-	-	-	-	-	-	-	-	-	-	-	-	-	-	-	-	-
35	-	-	-	-	-	-	-	-	-	-	-	-	-	-	-	-	-	-	-	-	-
36	-	-	-	-	-	-	-	-	-	-	-	-	-	-	-	-	-	-	-	-	-
37	-	-	-	-	-	-	-	-	-	-	-	-	-	-	-	-	-	-	-	-	-
38	-	-	-	-	-	-	-	-	-	-	-	-	-	-	-	-	-	-	-	-	-
39	-	-	-	-	-	-	-	-	-	-	-	-	-	-	-	-	-	-	-	-	-
40	-	-	-	-	-	-	-	-	-	-	-	-	-	-	-	-	-	-	-	-	-

5 Quantity variable

IC2800-1609 CONTACTORS

GEF-4062

COMPLETE LIST OF PARTS

Ref. No.	No. Req. for IC2800-1609																Catalog Number	Description					
	A	B	C	D	E	F	G	H	J	K	L	M	N	P	Q	R			S	T	U	V	W
4	2	1	2	1	2	1	2	1	2	1	2	1	2	1	2	1	2	1	2	1	2	N910P50B6	Retainer for operating coil or holding coil
5	2	1	2	1	2	1	2	1	2	1	2	1	2	1	2	1	2	1	2	1	2	9023730	Lockwasher for operating coil or holding coil
6	1	1	1	1	1	1	1	1	1	1	1	1	1	1	1	1	1	1	1	1	1	8650770G2	Magnet frame with core, upper
7	1	1	1	1	1	1	1	1	1	1	1	1	1	1	1	1	1	1	1	1	1	8650771G1	Magnet frame with core, lower
8	2	2	2	2	2	2	2	2	2	2	2	2	2	2	2	2	2	2	2	2	2	N144P16006C	Screw with lockwasher fastening lower magnet frame to upper magnet frame
9	1	1	1	1	1	1	1	1	1	1	1	1	1	1	1	1	1	1	1	1	1	8650775G1	Armature with spring seat and stop
10	1	1	1	1	1	1	1	1	1	1	1	1	1	1	1	1	1	1	1	1	1	2418822	Compression spring for armature
11	1	1	1	1	1	1	1	1	1	1	1	1	1	1	1	1	1	1	1	1	1	9023691	Adjusting screw for compression spring
12	2	2	2	2	2	2	2	2	2	2	2	2	2	2	2	2	2	2	2	2	2	6974772G1	Movable contact finger
13	1	1	1	1	1	1	1	1	1	1	1	1	1	1	1	1	1	1	1	1	1	2418819	Compression spring for upper movable contact finger
14	1	1	1	1	1	1	1	1	1	1	1	1	1	1	1	1	1	1	1	1	1	2419451	Compression spring for lower movable contact finger
15	1	1	1	1	1	1	1	1	1	1	1	1	1	1	1	1	1	1	1	1	1	8650777P9	Support for upper compression spring
16	1	1	1	1	1	1	1	1	1	1	1	1	1	1	1	1	1	1	1	1	1	9694754	Support for lower compression spring
17	2	2	2	2	2	2	2	2	2	2	2	2	2	2	2	2	2	2	2	2	2	N144P13004C	Screw with lockwasher fastening upper or lower spring
18	2	2	2	2	2	2	2	2	2	2	2	2	2	2	2	2	2	2	2	2	2	9043178G1	Shunt for movable contact finger
19	2	2	2	2	2	2	2	2	2	2	2	2	2	2	2	2	2	2	2	2	2	N144P13004C	Screw with lockwasher fastening shunt to movable contact finger
20	2	2	2	2	2	2	2	2	2	2	2	2	2	2	2	2	2	2	2	2	2	8650773P1	Molded support for movable contact finger
21	4	4	4	4	4	4	4	4	4	4	4	4	4	4	4	4	4	4	4	4	4	N144P15008C	Screw with lockwasher fastening molded support to armature
22	5	5	5	5	5	5	5	5	5	5	5	5	5	5	5	5	5	5	5	5	5	9644198P1	Shim between upper molded support and armature (0.030 in. thick)
22	5	5	5	5	5	5	5	5	5	5	5	5	5	5	5	5	5	5	5	5	5	9644198P2	Shim between upper molded support and armature (0.062 in. thick)
23	1	1	1	1	1	1	1	1	1	1	1	1	1	1	1	1	1	1	1	1	1	9043483G1	Terminal block
24	1	1	1	1	1	1	1	1	1	1	1	1	1	1	1	1	1	1	1	1	1	8650775P5	Supporting bracket for terminal block
25	4	4	4	4	4	4	4	4	4	4	4	4	4	4	4	4	4	4	4	4	4	N144P15006C	Screw with lockwasher fastening supporting brackets to magnet frame
26	2	2	2	2	2	2	2	2	2	2	2	2	2	2	2	2	2	2	2	2	2	N144P16008C	Screw with lockwasher fastening terminal block to supporting bracket
27	2	2	2	2	2	2	2	2	2	2	2	2	2	2	2	2	2	2	2	2	2	8650775P7	Connection strip for terminal block
28	4	4	4	4	4	4	4	4	4	4	4	4	4	4	4	4	4	4	4	4	4	9108642P15	Terminal clamp with screw and lockwasher
30	-	-	-	-	-	-	-	-	-	-	-	-	-	-	-	-	-	-	-	-	-	8650770P6	Arcing horn
31	2	2	2	2	2	2	2	2	2	2	2	2	2	2	2	2	2	2	2	2	2	N144P16006C	Screw with lockwasher fastening connection strip, shunt, and arcing horn to terminal block
32	-	-	-	-	-	-	-	-	-	-	-	-	-	-	-	-	-	-	-	-	-	3243199	Blowout coil
32	-	-	-	-	-	-	-	-	-	-	-	-	-	-	-	-	-	-	-	-	-	3243600	Blowout coil
32	-	-	-	-	-	-	-	-	-	-	-	-	-	-	-	-	-	-	-	-	-	3243601	Blowout coil
32	-	-	-	-	-	-	-	-	-	-	-	-	-	-	-	-	-	-	-	-	-	3243602	Blowout coil
33	-	-	-	-	-	-	-	-	-	-	-	-	-	-	-	-	-	-	-	-	-	9108314G1	Blowout coil and stationary contact tip support
34	-	-	-	-	-	-	-	-	-	-	-	-	-	-	-	-	-	-	-	-	-	9023690	Insulation tube for blowout coil
35	-	-	-	-	-	-	-	-	-	-	-	-	-	-	-	-	-	-	-	-	-	9043179P1	Insulation for blowout coil, left-hand
36	-	-	-	-	-	-	-	-	-	-	-	-	-	-	-	-	-	-	-	-	-	9043179P2	Insulation for blowout coil, right-hand
37	-	-	-	-	-	-	-	-	-	-	-	-	-	-	-	-	-	-	-	-	-	8650777P3	Pole piece, left-hand
38	-	-	-	-	-	-	-	-	-	-	-	-	-	-	-	-	-	-	-	-	-	8650777G1	Pole piece with core, right-hand
39	-	-	-	-	-	-	-	-	-	-	-	-	-	-	-	-	-	-	-	-	-	N57P15005B	Screw fastening pole piece and insulation to core
40	-	-	-	-	-	-	-	-	-	-	-	-	-	-	-	-	-	-	-	-	-	N144P16006C	Screw with lockwasher fastening blowout coil lead to contact tip support

δ Quantity variable

# IC2800-1609 CONTACTORS

GEF-4062

## OPERATING COILS, PICK UP RESISTORS, AND RECTIFIERS

NOTE: The number following the form letters in the IC designation identifies the operating coils, pick up resistor and rectifiers. Each must be ordered separately from the table below.

EXAMPLE: IC2800-1609-B-3-B requires coil number 3 Cat. No. 1D106G3A, pick up resistor 3000DA/X131AE, rectifier 6RS22PD12AHD1.

Coil No.	Coil Catalog No.	No. Req'd	Pick Up Resistor IC9006A50E	No. Req'd	Rectifier	No. Req'd
2	1D106G2A	1	-----	-	-----	-
2	1D106G2A	1	4600DA/X131AE	1	6RS22PD12AHD1	2
2	1D106G2A	1	5000DA/X131AE	1	6RS22PD12AHD1	2
2	1D106G2A	1	-----	-	-----	-
2	1D106G2A	1	A50E4000DA-TH	1	IC3500A403C8	1
2	1D106G2A	1	A50E6500DA-TH	1	IC3500A403C5	-
2	1D106G2A	1	A50E4000DA-TH	1	IC3500A403C8	1
2	1D106G2A	1	A50E6500DA-TH	1	IC3500A403C5	1
3	1D106G3A	1	-----	-	-----	-
3	1D106G3A	1	3000DA/X131AE	1	6RS22PD12AHD1	1
3	1D106G3A	1	1200DA/X131AL	1	6RS22PD12AHD1	2
3	1D106G3A	1	2300DA/X131AE	1	6RS22PD12AHD1	2
3	1D106G3A	1	2800DA/X131AE	1	6RS22PD12AHD1	2
4	1D106G4A	1	-----	-	6RS22PD12AHD1	2
5	1D106G5A	1	-----	-	6RS22PD12AHD1	2
6	1D106G6A	1	-----	-	-----	-
7	1D106G7A	1	-----	-	-----	-
7	1D106G7A	1	A50E200DA-TH	1	IC3500A403C2	1
7	1D106G7A	1	A50E200DA-TH	1	IC3500A403C2	-
8	1D106G8A	1	-----	-	-----	-
8	1D106G8A	1	A50E750DA-TH	1	IC3500A403C5	1
9	1D106G9A	1	-----	-	-----	-
9	1D106G9A	1	150DA/X131AL	1	6RS22PB3AHD1	1
9	1D106G9A	1	750DA/X131AL	1	6RS22PB3AHD1	1
9	1D106G9A	1	330DA/X131AE	1	6RS22PB6AHD1	1
9	1D106G9A	1	A50E300DA-TH	1	IC3500A403C6	1
10	1D106G10A	1	-----	-	-----	-
10	1D106G10A	1	90DA/X131AE	1	6RS22PB3AHD1	1
10	1D106G10A	1	A50E75DA-TH	1	IC3500A403C2	1
11	1D106G11A	1	-----	-	-----	-
12	1D106G12A	1	-----	-	-----	-
13	1D106G45A	1	-----	-	-----	-
14	1D106G14A	1	-----	-	-----	-
15	1D106B15A	1	-----	-	-----	-
16	Do not use - use G2	1	-----	-	-----	-
17	Do not use - use G2	1	-----	-	-----	-
18	1D106G18A	1	-----	-	-----	-
19	1D106G2A	1	∅	-	-----	-
20	1D106G2A	1	†	-	-----	-
21	1D106G21A	1	-----	-	-----	-
22	1D106G22A	1	-----	-	-----	-
23	1D106G23A	1	-----	-	-----	-
24	1D106G24A	1	-----	-	-----	-
25	1D106G25A	1	-----	-	-----	-
26	1D106G26A	1	-----	-	-----	-
27	1D106G27A	1	-----	-	-----	-
28	1D106G28A	1	-----	-	-----	-
29	1D106G29A	1	-----	-	-----	-
30	1D106G30A	1	-----	-	-----	-
31	Do not use - use G2	1	-----	-	-----	-
32	1D106G93A	1	-----	-	-----	-
33	1D106G33A	1	-----	-	-----	-
34	1D106G34A	1	-----	-	-----	-
35	1D106G35A	1	-----	-	-----	-
36	1D106G36A	1	-----	-	-----	-
37	1D106G2A	1	Δ	-	-----	-
38	1D106G2A	1	Δ	-	-----	-
39	1D106G2A	1	oo	-	-----	-

∅ Requires 6000 ohm resistor. Cat. No. of coil does not include resistor.  
 † Requires 1000 ohm resistor. Cat. No. of coil does not include resistor.  
 Δ Requires 4000 ohm resistor. Cat. No. of coil does not include resistor.  
 oo Requires 3000 ohm resistor. Cat. No. of coil does not include resistor.

IC2800-1609 CONTACTORS

GEF-4062

COMPLETE LIST OF PARTS (CONT'D)

Ref. No.	No. Req. for IC2800-1609																Catalog Number	Description										
	AA	AB	AC	AD	AE	AF	AG	AH	AJ	AK	AL	AM	AN	AP	BE	BF			BG	BH	BJ	BK	BL	BM	BW	CA	DA	
4	1	2	1	1	1	1	2	2	2	2	1	2	2	2	2	1	2	1	2	1	2	1	2	1	2	N910P50B6	Retainer for operating coil or holding coil	
5	1	2	1	1	1	1	2	2	2	2	1	2	2	2	2	1	2	1	2	1	2	1	2	1	2	9023730	Lockwasher for operating coil or holding coil	
6	1	1	1	1	1	1	1	1	1	1	1	1	1	1	1	1	1	1	1	1	1	1	1	1	1	8650770G2	Magnet frame with core, upper	
7	1	1	1	1	1	1	1	1	1	1	1	1	1	1	1	1	1	1	1	1	1	1	1	1	1	8650771G1	Magnet frame with core, lower	
8	2	2	2	2	2	2	2	2	2	2	2	2	2	2	2	2	2	2	2	2	2	2	2	2	2	N144P16006C	Screw with lockwasher fastening lower magnet frame to upper magnet frame	
9	1	1	1	1	1	1	1	1	1	1	1	1	1	1	1	1	1	1	1	1	1	1	1	1	1	8650775G1	Armature with spring seat and stop	
10	1	1	1	1	1	1	1	1	1	1	1	1	1	1	1	1	1	1	1	1	1	1	1	1	1	2418822	Compression spring for armature	
11	1	1	1	1	1	1	1	1	1	1	1	1	1	1	1	1	1	1	1	1	1	1	1	1	1	9023691	Adjusting screw for compression spring	
12	2	2	2	2	2	2	2	2	2	2	2	2	2	2	2	2	2	2	2	2	2	2	2	2	2	6974772G1	Movable contact finger	
13	1	1	1	1	1	1	1	1	1	1	1	1	1	1	1	1	1	1	1	1	1	1	1	1	1	2418819	Compression spring for upper movable contact finger	
14	1	1	1	1	1	1	1	1	1	1	1	1	1	1	1	1	1	1	1	1	1	1	1	1	1	2419451	Compression spring for lower movable contact finger	
15	1	1	1	1	1	1	1	1	1	1	1	1	1	1	1	1	1	1	1	1	1	1	1	1	1	8650777P9	Support for upper compression spring	
16	1	1	1	1	1	1	1	1	1	1	1	1	1	1	1	1	1	1	1	1	1	1	1	1	1	9694754	Support for lower compression spring	
17	2	2	2	2	2	2	2	2	2	2	2	2	2	2	2	2	2	2	2	2	2	2	2	2	2	N144P13004C	Screw with lockwasher fastening upper or lower spring	
18	2	2	2	2	2	2	2	2	2	2	2	2	2	2	2	2	2	2	2	2	2	2	2	2	2	9043178G1	Shunt for movable contact finger	
19	2	2	2	2	2	2	2	2	2	2	2	2	2	2	2	2	2	2	2	2	2	2	2	2	2	N144P13004C	Screw with lockwasher fastening shunt to movable contact finger	
20	2	2	2	2	2	2	2	2	2	2	2	2	2	2	2	2	2	2	2	2	2	2	2	2	2	8650773P1	Molded support for movable contact finger	
21	4	4	4	4	4	4	4	4	4	4	4	4	4	4	4	4	4	4	4	4	4	4	4	4	4	N144P15008C	Screw with lockwasher fastening molded support to armature	
22	6	6	6	6	6	6	6	6	6	6	6	6	6	6	6	6	6	6	6	6	6	6	6	6	6	6	9644198P1	Shim between upper molded support and armature (0.030 in. thick)
22	6	6	6	6	6	6	6	6	6	6	6	6	6	6	6	6	6	6	6	6	6	6	6	6	6	9644198P2	Shim between upper molded support and armature (0.062 in. thick)	
23	1	1	1	1	1	1	1	1	1	1	1	1	1	1	1	1	1	1	1	1	1	1	1	1	1	9043483G1	Terminal block	
24	1	1	1	1	1	1	1	1	1	1	1	1	1	1	1	1	1	1	1	1	1	1	1	1	1	8650775P5	Supporting bracket for terminal block	
25	2	2	2	2	2	2	2	2	2	2	2	2	2	2	2	2	2	2	2	2	2	2	2	2	2	N144P15006C	Screw with lockwasher fastening supporting brackets to magnet frame	
26	2	2	2	2	2	2	2	2	2	2	2	2	2	2	2	2	2	2	2	2	2	2	2	2	2	N144P16008C	Screw with lockwasher fastening terminal block to supporting bracket	
27	2	2	2	2	2	2	2	2	2	2	2	2	2	2	2	2	2	2	2	2	2	2	2	2	2	8650775P7	Connection strip for terminal block	
28	4	4	4	4	4	4	4	4	4	4	4	4	4	4	4	4	4	4	4	4	4	4	4	4	4	9108642P15	Terminal clamp with screw and lockwasher	
30	1	2	2	2	2	2	2	2	2	2	2	2	2	2	2	2	2	2	2	2	2	2	2	2	2	8650770P6	Arcing horn	
31	2	2	2	2	2	2	2	2	2	2	2	2	2	2	2	2	2	2	2	2	2	2	2	2	2	N144P16006C	Screw with lockwasher fastening connection strip, shunt, and arcing horn to terminal block	
32	-	-	-	-	-	-	-	-	-	-	-	-	-	-	2	2	-	-	-	-	-	-	-	-	-	3243199	Blowout coil	
32	-	-	-	-	-	-	-	-	-	-	-	-	-	-	2	2	-	-	-	-	-	-	-	-	-	3243600	Blowout coil	
32	-	1	-	-	-	-	-	-	-	-	-	-	-	-	-	-	-	-	-	-	-	-	-	-	-	3243601	Blowout coil	

δ Quantity variable



# RENEWAL PARTS

GEF-4062B  
Supersedes GEF-4062A  
and GEF-3757D

## IC2800-1609 CONTACTORS

Forms A thru DA

**NOTE:**—When ordering parts for a form of the contactor not covered by this bulletin, give reference number, description of part, complete nameplate reading, and above bulletin (GEF) number. Do not use catalog number when form for which the parts are needed is not covered by the bulletin.

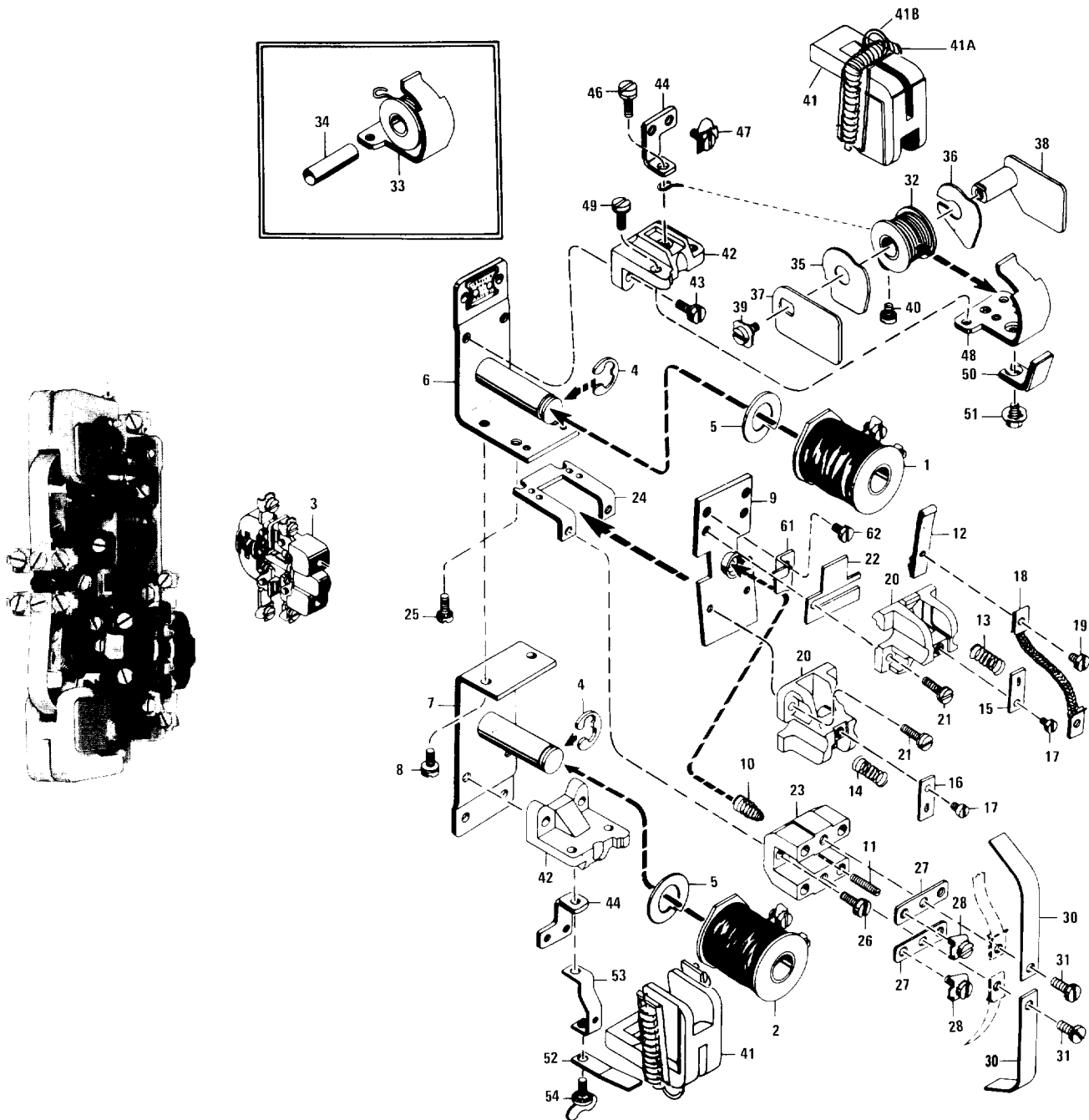

When ordering renewal parts, give quantity, catalog number, description of each item required, and complete nameplate reading.

GENERAL  ELECTRIC