

# RENEWAL PARTS

## DS2800-Y105 CONTACTORS

Forms A, D, E, F, S, T, U, V, W and Y

**NOTE:**—When ordering parts for a form of the contactor not covered by this bulletin, give reference number, description of part, complete nameplate reading, and above bulletin (GEF) number. Do not use catalog number when form for which the parts are needed is not covered by the bulletin.

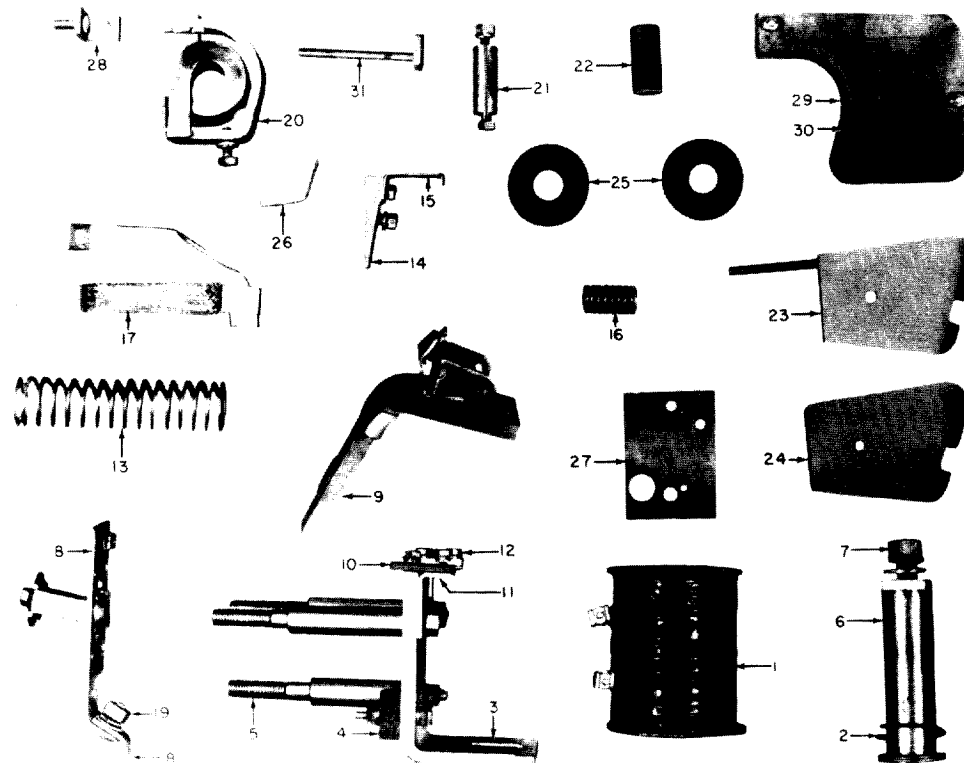

### PARTS RECOMMENDED FOR NORMAL STOCK

Ref. No.	Number Required for 2800-Y105-										Catalog Number	Description
	A	D	E	F	S	T	U	V	W	Y		
1	1	1	1	1	1	1	1	1	1	1	-----	Operating coil (see table page 2)
	Δ	Δ	Δ	Δ	Δ	Δ	Δ	Δ	Δ	Δ	-----	Set of interlock contacts (see table page 2)
14	1	1	1	1	-	1	1	1	1	1	5351643	Movable contact
14	-	-	-	-	1	-	-	-	-	-	5306170G2	Movable contact
26	1	1	-	1	-	1	1	1	-	1	5352149	Stationary contact
26	-	-	-	-	1	-	-	-	-	-	5306170G1	Stationary contact
16	1	1	1	1	1	1	1	1	1	1	2414865	Compression spring for movable contact
13	1	1	1	1	1	1	1	1	1	1	2416433	Compression spring for armature
17	1	1	1	1	1	1	1	1	1	1	6969508G1	Shunt with connection strip
29	1	1	-	1	1	1	1	1	-	1	3671036P2	Arc chute side, right-hand
30	1	1	-	1	1	1	1	1	-	1	3671035P2	Arc chute side, left-hand

Δ If interlock is used, a quantity of one set is required for each interlock switch unit.

When ordering renewal parts, give quantity, catalog number, description of each item required, and complete nameplate reading.



**DS2800-Y105 CONTACTORS**

Ref. No. 1 - OPERATING COILS - 1 Required

NOTE: The operating coil is identified by the number following the form letter in the DS designation.

EXAMPLE: DS2800-Y105-A-2-B requires operating coil number 2, Cat. No. 22D87G10.

Coil No.	Catalog Number	Coil No.	Catalog Number	Coil No.	Catalog Number	Coil No.	Catalog Number
2	22D87G10A	12	22D87G11A	22	22D87G10A	32	22D87G12A
3	22D87G3A	13	22D87G12A	23	22D87G3A	33	22D87G13A
4	22D87G2A	14	22D87G13A	24	22D87G2A	34	22D87G14A
5	22D87G4A	15	22D87G14A	25	22D87G4A	35	22D87G15A
6	22D87G5A	16	22D87G15A	26	22D87G5A	36	22D87G16A
7	22D87G6A	17	22D87G16A	27	22D87G6A	37	(Use Coil No. 33)
8	22D87G6A	18	22D87G19	28	22D87G7A	38	22D87G20A
9	22D87G7A	19	22D87G20A	29	22D87G8A	39	22D87G21A
10	22D87G8A	20	22D87G21A	30	22D87G9A	40	22D87G22
11	22D87G9A	21	22D87G22A	31	22D87G11A		

**ELECTRICAL INTERLOCKS**

NOTE: The interlock is identified by the letter or letter and number following the coil number in the DS designation.

EXAMPLE: DS2800-Y105-A-2-B requires interlock letter B, Cat. No. DS2956A200C.

Interlock Letter	Interlock Switch Unit		δ Set of Interlock Contacts	† Interlock Mounting Kit
	Right-hand	Left-hand		
Catalog Number				
B	-----	IC2956A200C	6960053G3	IC2956A203D
C	-----	IC2956A200B	6960053G3	IC2956A203D
D	-----	IC2956A200A	6960053G3	IC2956A203D
E	IC2956A200C	-----	6960053G3	IC2956A203D
F	IC2956A200B	-----	6960053G3	IC2956A203D
G	IC2956A200A	-----	6960053G3	IC2956A203D
H	IC2956A200A	IC2956A200A	6960053G3	IC2956A203D
J	IC2956A200C	IC2956A200A	6960053G3	IC2956A203D
K	IC2956A200C	IC2956A200C	6960053G3	IC2956A203D
L	IC2956A200B	IC2956A200C	6960053G3	IC2956A203D
M	IC2956A200B	IC2956A200B	6960053G3	IC2956A203D
N	IC2956A200AJ	-----	6960053G3	IC2956A203D
P	IC2956A200AK	-----	6960053G3	IC2956A203D
R	IC2956A200AH	-----	6960053G3	IC2956A203D
S	-----	IC2956A200AK	6960053G3	IC2956A203D
AB	-----	IC2956A200AC	6960053G22	IC2956A203D
AC	-----	IC2956A200AB	6960053G22	IC2956A203D
AD	-----	IC2956A200AA	6960053G22	IC2956A203D
AE	IC2956A200AC	-----	6960053G22	IC2956A203D
AF	IC2956A200AB	-----	6960053G22	IC2956A203D
AG	IC2956A200AA	-----	6960053G22	IC2956A203D
CB	-----	IC2956A205C	6960053G46	IC2956A203C
CC	-----	IC2956A205A	6960053G3	IC2956A203C
CD	-----	IC2956A205B	6960053G46	IC2956A203C
CE	IC2956A205C	-----	6960053G46	IC2956A203C
CF	IC2956A205A	-----	6960053G3	IC2956A203C
CG	IC2956A205B	-----	6960053G46	IC2956A203C

δ Includes movable and stationary contacts with springs and contact-holding screws.

† Includes mounting bracket, operating arm, mounting screws and lock washers.

# DS2800-Y105 CONTACTORS

GEF-4125

## COMPLETE LIST OF PARTS

Ref. No.	Number Required for 2800-Y105-										Catalog Number	Description
	A	D	E	F	S	T	U	V	W	Y		
2	1	1	1	1	1	1	1	1	1	1	8626009P4	Retaining washer
3	1	1	1	1	1	1	1	1	1	1	6982581P1	Magnet frame
4	1	1	1	1	1	-	1	1	1	1	6982580P3	Armature stop
4	-	-	-	-	-	1	-	-	-	-	6982580P10	Armature stop
	2	2	2	2	2	2	2	2	2	2	N26P21024B	Screw fastening armature stop to frame (1/4-20, 1 1/2 in. hex. hd slot., pro. fin.)
5	3	3	3	3	3	3	3	3	3	3	119A5400P1	Supporting post for frame
6	1	1	1	1	1	1	1	1	1	1	5304780G3	Magnet core
7	1	1	1	1	1	1	1	1	1	1	N22P29016B	Screw fastening magnet core to frame (1/2-13, 1 in. hex. hd, pro. fin.)
8	1	1	1	1	1	1	1	1	1	1	6960501G1	Base plate with spring support
	1	1	1	1	1	1	-	-	1	1	119A4693P1	Cover for spring support (back of base)
	-	-	-	-	-	-	1	1	-	-	68J120202TH0101DBV	Spacer
9	1	1	1	1	1	1	1	1	1	1	6982582G1	Armature with tip support
10	2	2	2	2	2	2	2	2	2	2	6980186P3	Guide plate for armature
11	1	1	1	1	1	1	1	1	1	1	6982580P8	Supporting bracket for guide plates
12	4	4	4	4	4	4	4	4	4	4	N26P21008B	Screw fastening guide plate and supporting bracket (1/4-20, 1/2 in. hex. hd slot., pro. fin.)
13	1	1	1	1	1	1	1	1	1	1	2416433	Compression spring for armature
14	1	1	1	1	-	1	1	1	1	1	5351643	Movable contact
14	-	-	-	-	1	-	-	-	-	-	5306170G2	Movable contact
15	1	1	1	1	1	1	1	1	1	1	5353262	Arcing horn for movable contact
16	1	1	1	1	1	1	1	1	1	1	2414865	Compression spring for movable contact
17	1	1	1	1	1	1	1	1	1	1	6969508G1	Shunt with connection strip
	1	1	1	1	1	1	1	1	1	1	N26P23008B	Screw fastening shunt to movable contact (5/16-18, 1/2 in. hex. hd slot., pro. fin.)
18	1	1	1	1	1	1	1	1	1	1	117A7300P2	Bus bar for shunt
19	1	1	1	1	1	1	1	1	1	1	N62P25014B	Carriage bolt fastening shunt and bus bar to base plate (3/8-16, 7/8 in. pro. fin.)
20	1	1	-	1	1	1	1	1	-	1	117A7303G1	Blowout coil and support for stationary contact
21	1	1	-	1	1	1	1	1	-	1	6903416P1	Magnet core for blowout coil
22	1	1	-	1	1	-	1	1	-	1	6903415P1	Insulation sleeve for core
22	-	-	-	-	-	1	-	-	-	-	6903415P2	Insulation sleeve for core
23	1	1	-	-	-	-	1	1	-	1	6914815G4	Pole piece with stud
23	-	-	-	-	-	1	-	-	-	-	6914815G3	Pole piece with stud
24	1	1	-	1	1	1	1	1	-	1	6914806P3	Pole piece
25	2	2	-	2	2	-	2	2	-	2	6907875P1	Insulation washer for blowout coil
25	-	-	-	-	-	2	-	-	-	-	6907875P2	Insulation washer for blowout coil
	1	1	-	1	1	1	1	1	-	1	N26P23040B	Screw fastening pole pieces to magnet core (5/16-18, 2 1/4 in. hex. hd slot., pro. fin.)
26	1	1	-	1	-	1	1	1	-	1	5352149	Stationary contact
26	-	-	-	-	1	-	-	-	-	-	5306170G1	Stationary contact
											N26P23010B	Screw fastening stationary contact tip to support (5/16-18, 5/8 in. hex. hd slot., pro. fin.)
27	1	1	-	1	1	-	1	1	-	1	6906186	Spacer between blowout coil and base
28	1	1	-	1	1	1	-	1	-	1	119A4691G1	Support for blowout coil lead
28	-	-	-	-	-	-	1	-	-	-	119A4691G2	Support for blowout coil lead
	1	1	-	1	1	1	1	1	-	1	117A7148G2	Arc chute, complete, with screws and nuts
29	1	1	-	1	1	1	1	1	-	1	3671036P2	Arc chute side, right-hand
30	1	1	-	1	1	1	1	1	-	1	3671035P2	Arc chute side, left-hand
	2	2	-	2	2	2	2	2	-	2	1457P16032B	Screw fastening arc chute sides together (10-32, 2 in. pan hd, pro. fin.)
31	1	1	-	1	1	-	1	1	-	1	119A5401G1	Supporting stud for blowout coil support and arc chute
31	-	-	-	-	-	1	-	-	-	-	6914804G9	Supporting stud for blowout coil support and arc chute
	1	-	-	-	1	-	-	-	-	1	909B579P1	Base for contactor
	-	1	-	-	-	1	1	-	-	-	909B579P3	Base for contactor
	-	-	-	1	-	-	-	1	-	-	909B579P4	Base for contactor
	-	-	1	-	-	-	-	-	1	1	68J1202ER0101DDV	Base for contactor
	1	1	-	1	1	-	-	-	-	-	909B579P2	Insulation for back of base
	-	-	-	-	-	1	-	1	-	-	909B579P3	Insulation for back of base
	-	-	-	-	-	-	1	1	-	-	139B8037P2	Insulation

**GENERAL ELECTRIC COMPANY  
COMPONENTS AND EQUIPMENT SALES  
DRIVE SYSTEMS DEPARTMENT  
SALEM, VA 24153**

**GENERAL  ELECTRIC**