



Spectra Series™ Power Panelboards

Surface Front Trim, Type APF

Installation



WARNING: Danger of electrical shock or injury. Turn OFF power ahead of the panelboard or switchboard before working inside the equipment or removing any component. Equipment is to be installed and maintained by properly trained and qualified personnel only.

1. All type APP filler plates, the main lug cover (if applicable), and C/B covers (if applicable) should be in place, and all wiring should be complete before starting the trim assembly. For ease of assembly, ADS Fusible Switch device side fillers should be installed after the front trim is in place.
2. Fasten the end trims (with turned edges toward the interior) to the box with the screws provided, as shown in Figure 1. Do not tighten the screws. The end trim with the cutout should be installed on the load end of the box.

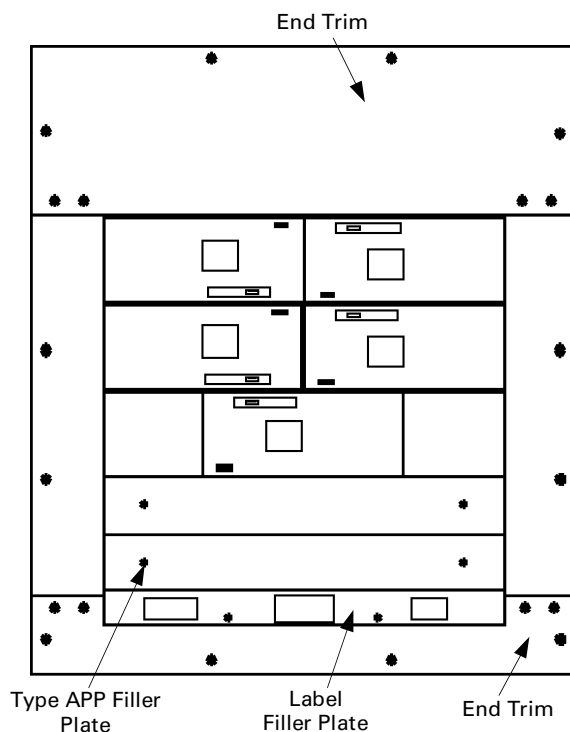

Figure 1. Installation of the end trims. (Top feed is shown.)

3. Make sure that all positions on the interior between the end trims are occupied with a device or an appropriate type APP filler plate, as shown in Figure 1.

4. Slide a side trim over the turned edge of the box. The tabs extending from the ends of the side trim slide under the end trims. Rest the side trim on the bottom end trim to help align the mounting holes. The ends of any installed filler plates and, in some cases, flanges on devices, should fit into the channel (if applicable) on the inner edge of the side trim. See Figure 2.

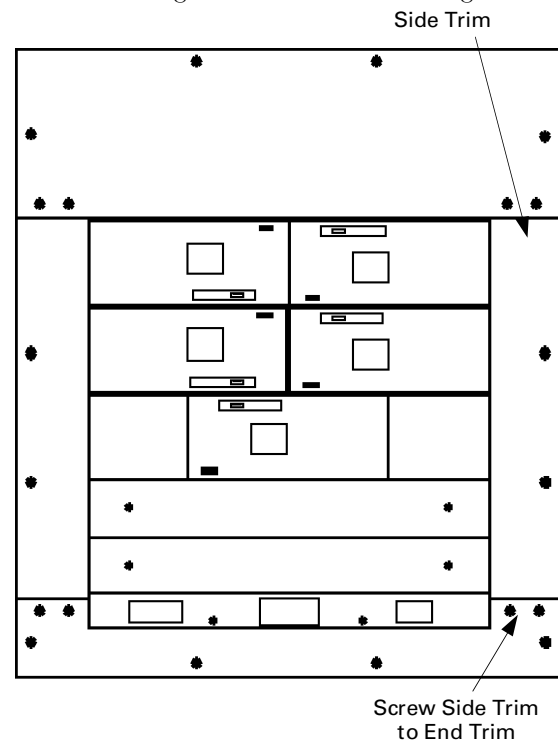

Figure 2. Installation of the side trims.

5. Insert screws into the top and bottom end trim holes, then into the side trim holes. Do not tighten the screws.
6. Secure the opposite side trim in the same manner as steps 4 and 5.
7. Any open spaces between the installed devices and the side trims should be covered with the filler plate supplied with the device or with an appropriate type APF filler plate.

To install the APF filler plate, insert the flat end into the channel on the inner edge of the side trim. Secure the opposite end to the flange on the device with the screws supplied and tighten to 25–30 in.-lb. There should be no unoccupied spaces when installation is complete, as shown in Figure 3.

8. Adjust the trims for proper fit, then tighten all screws to 25–30 in.-lb.

9. Apply the GE Logo to the panel front end trim. For OEM and Distributor Stock Panels apply the FOR RATINGS SEE label to the panel front end trim.

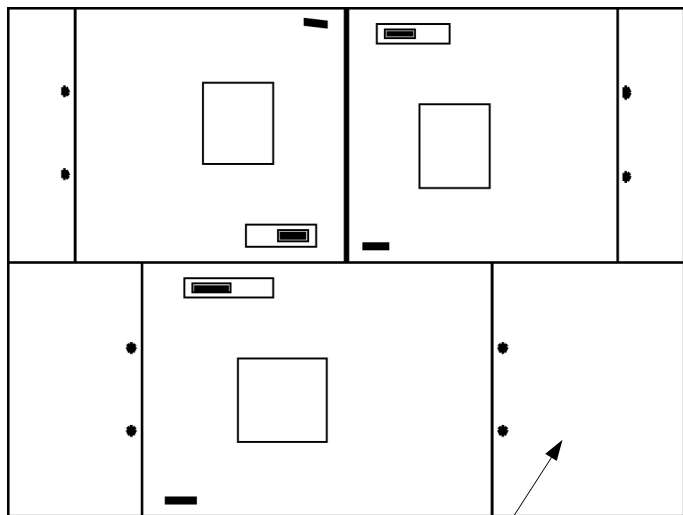

Type APF
Filler Plate

Figure 3. Installation of Type APF filler plate.

These instructions do not cover all details or variations in equipment nor do they provide for every possible contingency that may be met in connection with installation, operation, or maintenance. Should further information be desired or should particular problems arise that are not covered sufficiently for the purchaser's purposes, the matter should be referred to the GE Company.



GE Industrial Systems