

Side View

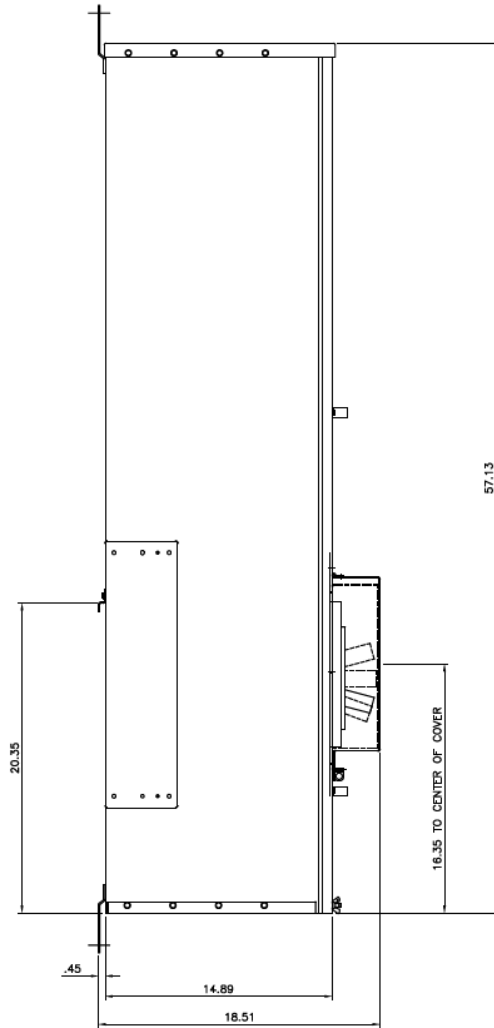

This unit includes a
110-240V shunt trip

Fixed rating plug, not
field adjustable

Front View

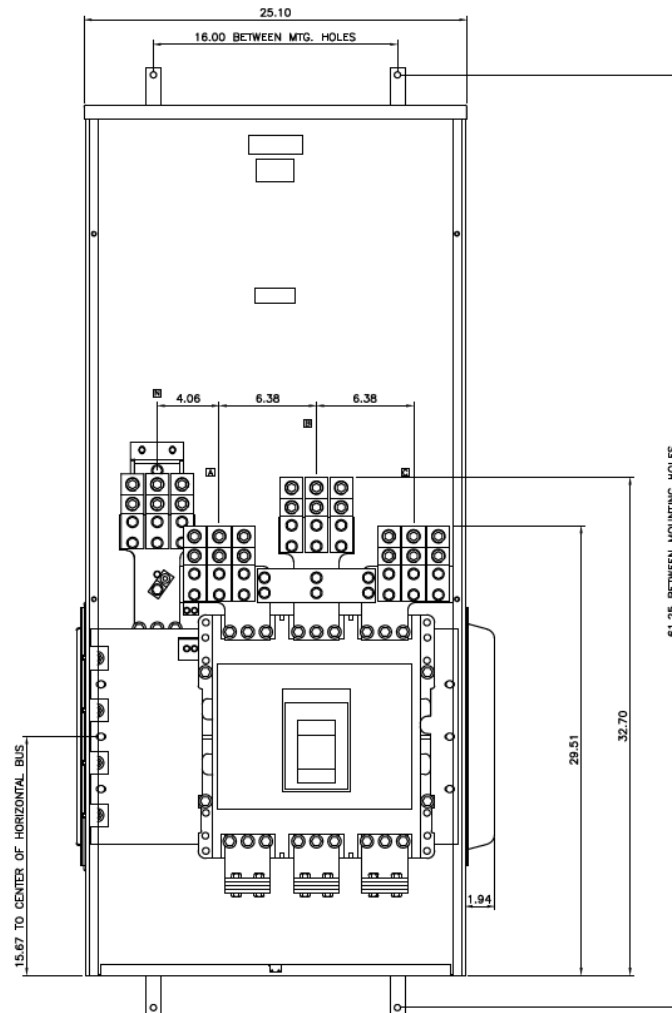

Incoming Cable Sizes:

(6) #2 – 600MCM/ Phase&Neutral (AL & CU)

Notes:

No Knockouts in Endwalls



imagination at work

METER MOD III-2000A MAIN BREAKER SECT N3R ENCL
100KAIC 3PH 4W 208Y/120V TOP FEED W/ SHUNT TRIP

| REF NO | CAT NO | DWG DATE | REV # |
|---------|-------------|----------|-------|
| 96-5560 | TMP3BT20RST | 1/8/2015 | 01 |