

Left Side View

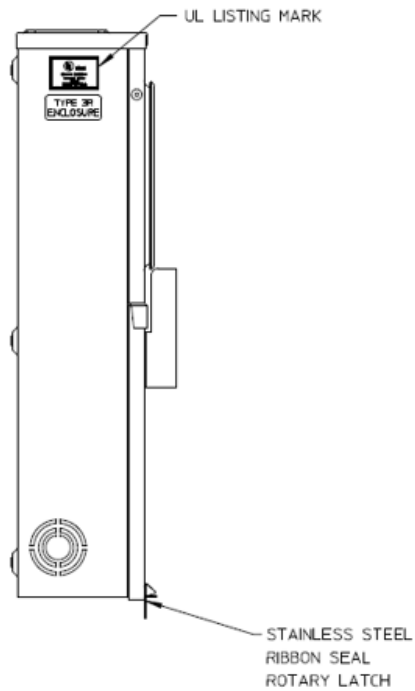

Front View Exterior

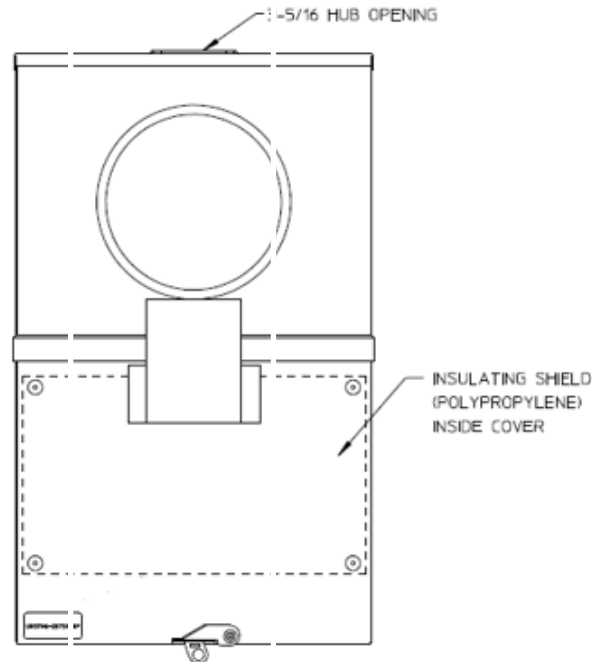

Front View Interior

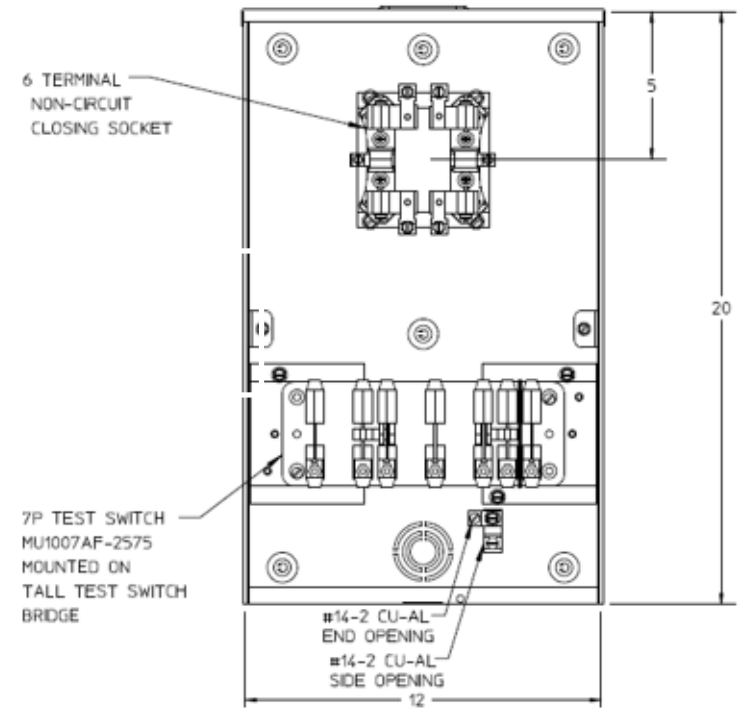

Notes

- 1) CABINET CONSTRUCTED FROM 16 GAUGE G90 GALVANIZED STEEL
- 2) FINISH: GREY
- 3) UNIT RATING: 20 AMP CONTINUOUS 600VAC 1 PHASE 3 WIRE
- 4) UNIT IS PREWIRED FORM 4S PER CUSTOMER SPECS
- 5) UNIT IS SUPPLIED WITH TEMPORARY CARDBOARD METER OPENING COVER
- 6) MIDWEST LABEL ATTACHED TO END OF THE CARTON
- 7) MIDWEST LOGO STAMPED ON LOWER LEFT HAND CORNER OF FRONT
- 8) SAFETY LABEL IS LOCATED ON THE LOWER RIGHT-HAND CORNER OF THE FRONT
- 9) 1" HUB KIT PACKED INSIDE
- 10) FOR TECO USE ONLY
- 11) STAINLESS STEEL SCREW TYPE SEALING RING MOUNTED ON TOP FRONT

Bottom View

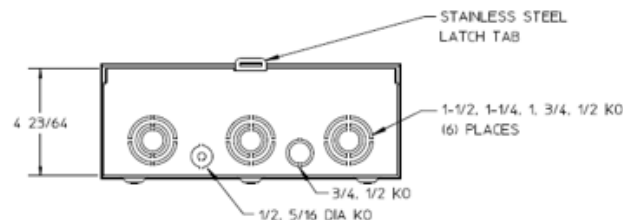

TRANSFORMER RATED MTR – 20A 6T 1P3W N3R STEEL
SMALL HUB OPENING TOP/BOT FEED TECO APPROVED

CAT NO	DWG DATE	REV #
URSTH62B759MEP	02/23/2017	01